

# TOWNSHIP 23 SOUTH, RANGE 10 WEST, OF THE WILLAMETTE MERIDIAN, OREGON. DEPENDENT RESURVEY

Sec. 11

Sec. 12

Sec. 14

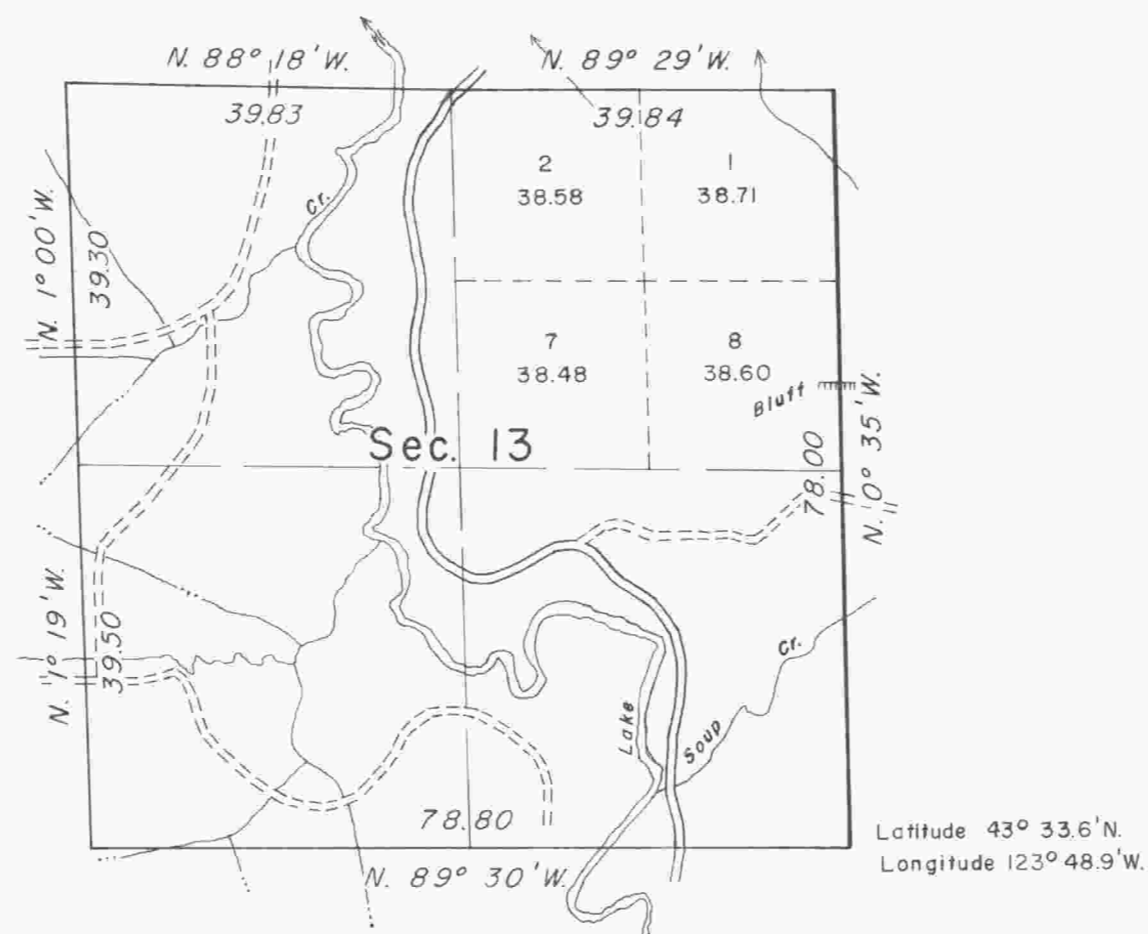

This plat represents a retracement and reestablishment of a portion of the east boundary and subdivisional lines, T. 23 S., R. 10 W., Willamette Meridian, Oregon, designed to restore the corners in their true original locations according to the best available evidence.

Excepting as new or modified vacant subdivisions are shown hereon, the lottings and areas are as shown on the plat approved July 26, 1879.

In 1879, William H. Byars surveyed the east boundary and a portion of the subdivisional lines.

The resurvey was executed by Donald R. Beck, Cadastral Surveyor, October 12 to November 1, 1967, under Special Instructions dated September 27, 1967, which provide for the surveys included under Group No. 658, Oregon.



Mean  
Magnetic  
Declination  
19°45' East

Sec. 23

Sec. 24

UNITED STATES DEPARTMENT OF THE INTERIOR  
BUREAU OF LAND MANAGEMENT  
Washington, D. C. April 24, 1970

This plat is strictly conformable to the approved field notes, and the survey, having been correctly executed in accordance with the requirements of law and the regulations of this Bureau, is hereby accepted.

For the Director

Chief, Division of Cadastral Survey

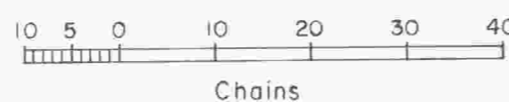

Area resurveyed: 634.37 Acres

Timber in this area consists of fir, hemlock, cedar, maple, alder, myrtle, dogwood, chinquapin, and yew.