

Township No. 23 South, Range No. 10 West, Willamette Meridian, Oregon.

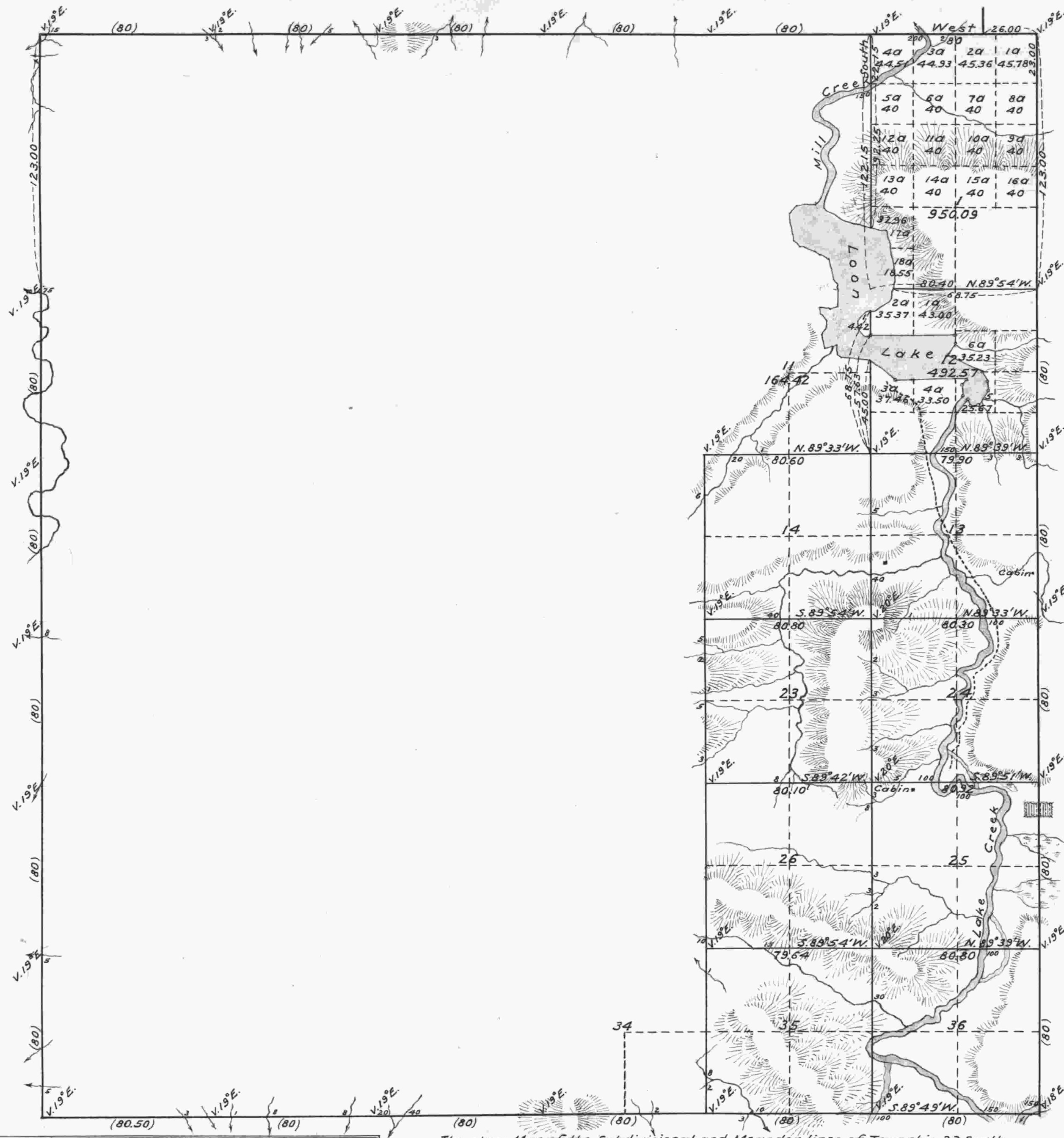

General Description.
 The quality of the lands in this Township is varied. The land along Lake Creek is rich bottom varying in width from 5 to 60 chains. Some bench lands are found on the hills back from the Creek, which are good and susceptible of cultivation. A vast amount however is broken mountainous and 3^d rate. Timber burned off. The valley, above the lake, overflows during extreme high water. The bottoms are covered with the finest quality of Myrtle and Maple timber.
 Total Acres - 6887.08

True Meridian
 Var. From 18° to 20° East
 Scale: 40 Chains to an Inch.

| Lines | Contractor | Contract No. | Date | Amount Surveyed | | | Commenced | Completed |
|---------------|-------------|--------------|--------------|-----------------|--------|-------|--------------|--------------|
| | | | | Miles | Chains | Links | | |
| Subdivisions | W. H. Byars | 292 | Aug. 7, 1878 | 18 | 72 | 81 | May 28, 1879 | June 6, 1879 |
| Meanders | | | | 2 | 69 | 35 | | |
| Intersections | | | | Total | 21 | 62 | 16 | |

The above Map of the Subdivisional and Meander lines of Township 23 South, Range 10 West, Will. Mer, Oregon, is strictly conformable to the original field notes of the survey thereof on file in this Office, which have been examined and approved.
 U. S. Surveyor General's Office,
 Portland, Oregon, July 26, 1879.

(signed) James C. Tolman,
 Sur. Gen'l. of Oregon.

Public Survey Office,
 Portland, Oregon,
 September 9, 1935.
 I certify this to be a correct copy of the original plat on file in this office.
 Joseph A. Sawing,
 Office Cadastral Engineer.

B. L. F. Copy.