

# TOWNSHIP 23 SOUTH, RANGE 4 WEST, OF THE WILLAMETTE MERIDIAN, OREGON.

DEPENDENT RESURVEY

Sec. 11

Sec. 12

Sec. 14

Sec. 13

Sec. 23

Sec. 24



Mean magnetic declination  
18° 15' E.

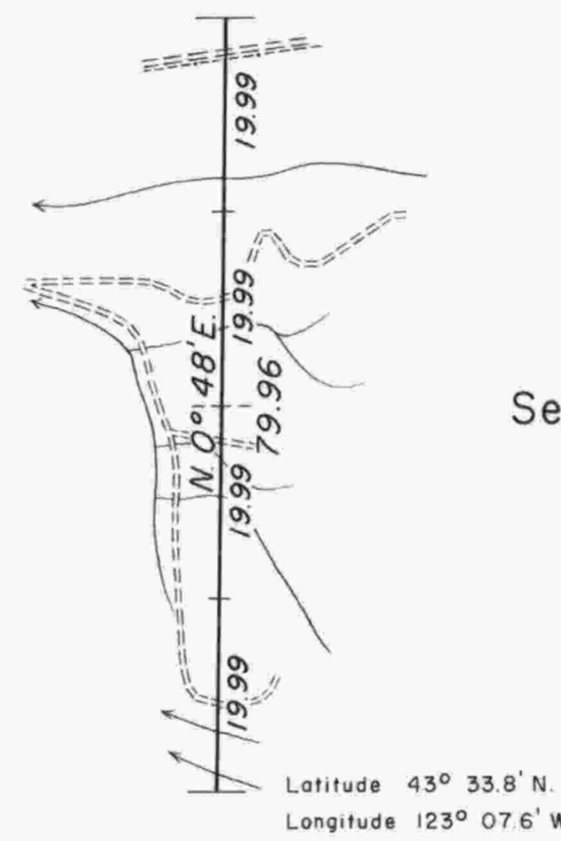

Latitude 43° 33.8' N.  
Longitude 123° 07.6' W.

This plat represents a retracement and reestablishment of the line between sections 13 and 14, T. 23 S., R. 4 W., Willamette Meridian, Oregon, designed to restore the corners in their true original locations according to the best available evidence.

The mile between sections 13 and 14 was surveyed by Harvey Gordon and Charles T. Gardner in 1855-56.

The resurvey was executed by James E. Jelley, Cadastral Surveyor, from April 7 to April 12, 1971 under Special Instructions dated March 8, 1971, which provide for the surveys included under Group No. 733, Oregon.

UNITED STATES DEPARTMENT OF THE INTERIOR  
BUREAU OF LAND MANAGEMENT  
Washington, D.C. August 28, 1972

This plat is strictly conformable to the approved field notes, and the survey, having been correctly executed in accordance with the requirements of law and the regulations of this Bureau, is hereby accepted.

For the Director

Chief, Division of Cadastral Survey

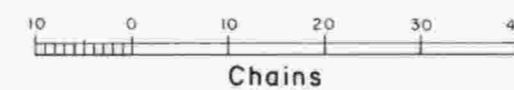

Timber in this area consists of fir, hemlock, cedar, alder, oak, madrone, dogwood, and maple.