

TOWNSHIP No. 23 SOUTH RANGE No. 3 WEST WILLAMETTE MERIDIAN OREGON.

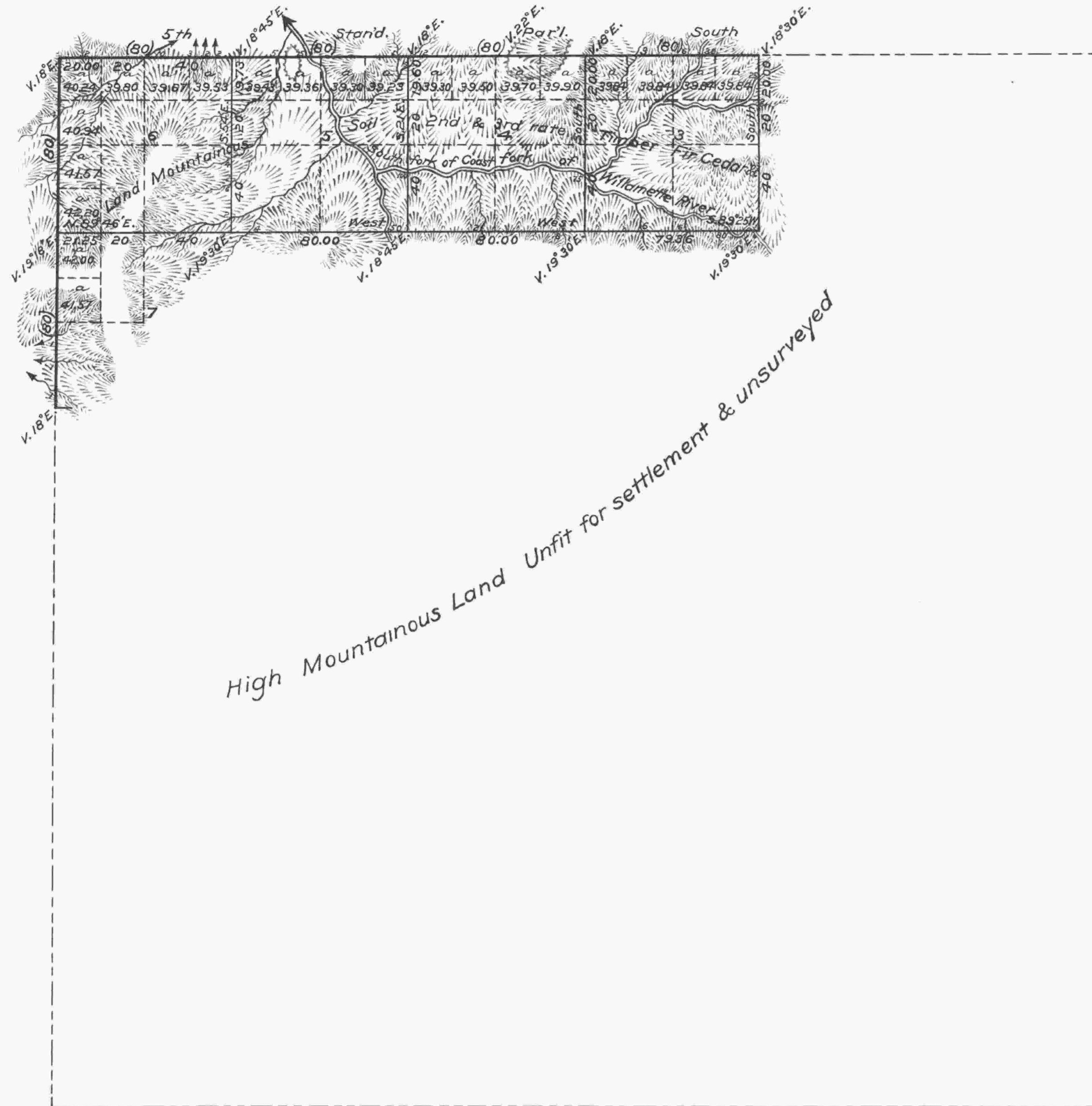

High Mountainous Land Unfit for settlement & unsurveyed

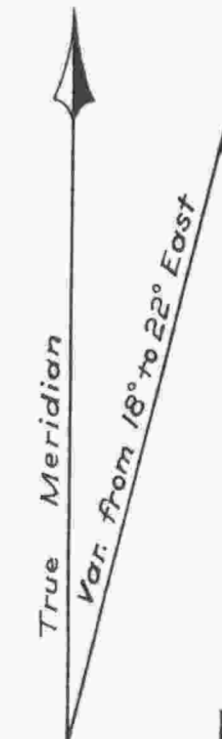

Scale 40 chains to an inch

Surveys designated	By whom surveyed	Contract		Amt. of surveys			When surveyed
		No.	Date	Miles	chains	links	
Township Lines	Gordon & Gardner	52	February 17th., 1855	2	00	00	September 24th. 1855
Subdivisions	Armstrong & Hutchinson	60	July 19th., 1855	7	79	94	May 14th., 1855
Total number of	Acres	2722.80					

The above Map of Fractional Township No. 23 South of Range No. 3 West of the Willamette Meridian State of Oregon is strictly conformable to the field notes of the survey thereof on file in this office which have been examined & approved.
 Surveyor General's Office
 Salem, Oregon, May 14th. 1859
 (Signed)

John S. Zieber
 Sur. Gen. of Oregon

Public Survey Office,
 Portland, Oregon, May 25, 1928
 I certify the above to be a correct copy of the original plat on file in this office.

Joseph A. Gausoy
 Office Cadastral Engineer.