

Township No. 22 South Range No. 9 West of the Willamette Meridian, Oregon.

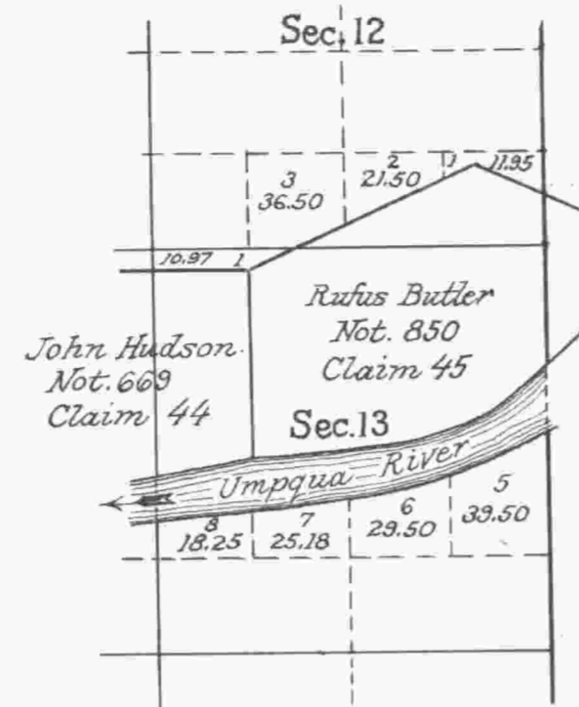

The above diagram showing the change in the numbering of lots in Section 13, T. 22 S. R. 9 W. Will. Mer. Or. by authority of Commissioners Letter E, dated April 14, 1899 is correct and is hereby approved.
 Sur. Gen's Office
 Portland, Oregon April 22, 1899.

Robert A. Stabersham
 Sur. Gen. for Oregon.

I certify the above to be a correct copy of the original tracing on file in this Office.
 U.S. Surveyor General's Office
 Portland, Oregon December 17, 1921.

Wesley W. Cariness
 Surveyor General of Oregon.

0 10 20 40 80
 Scale 40 Chains to an inch
 Mean Magnetic Declination

Surveys Designated	By Whom Surveyed	Group		Amount of Surveys			When Surveyed	
		No.	Date	Mls.	chs.	lks.	Begun	Completed

The above map of Township No. Range No. of the
 Meridian is strictly conformable to the field notes of the survey thereof on file
 in this office, which have been examined and approved.

U. S. Surveyor General's Office.

Surveyor General.