

Township N°22 South Range N°9 West Willamette Meridian, Or.

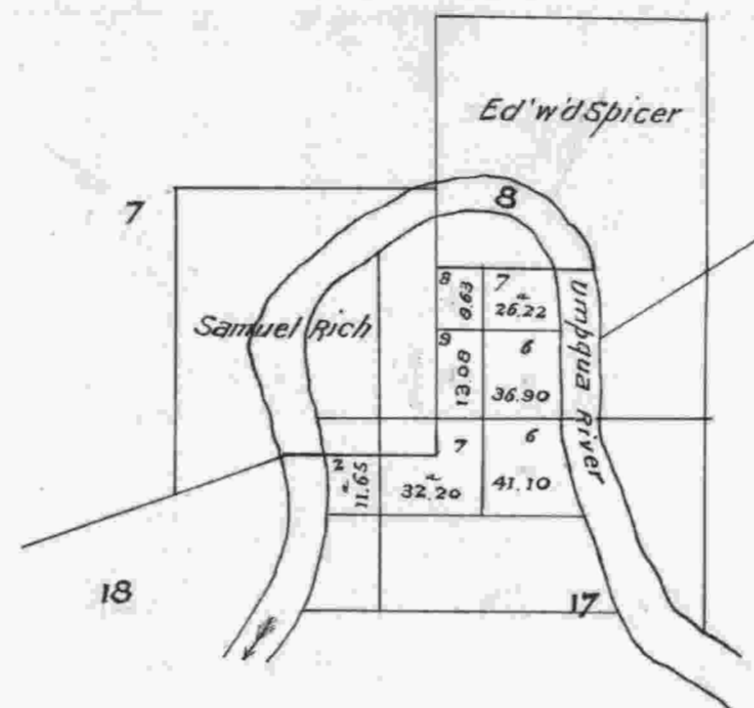

The above special plat showing the number and area of lots, adjoining the surveyed lines of the Donation Land claims of Ed'wd Spicer and Samuel Rich in Secs 8, 17 & 18, T. 22 S. R. 9 W. Will Mer Oregon is correct and is hereby approved.

U.S. Surveyor General's Office
Portland Oregon

Nov. 21. 1881

Signed

James C. Tolman
Surveyor Gen'l for Oregon.

I certify this to be a correct copy of the original tracing on file in this Office.
U.S. Surveyor General's Office.
Portland, Oregon, January, 25, 1915

Edward G. South
Surveyor General
for Oregon.