

Township N^o 22 South Range N^o 9 West Willamette Meridian, Oregon.

G F F E D C B A

Deposit made to Credit of United States
 Sep^r 4th 1877 By James M^cCahey for Office Work Field Work
 E. Breen \$5.00 \$21.75
 C. Hacker \$5.00 \$21.75
 A. Decker \$5.00 \$21.75
 Total \$20.00 \$87.00
 Byars Contract 274 Frac^l T. 22 S. Rgs 9 and 10 W.

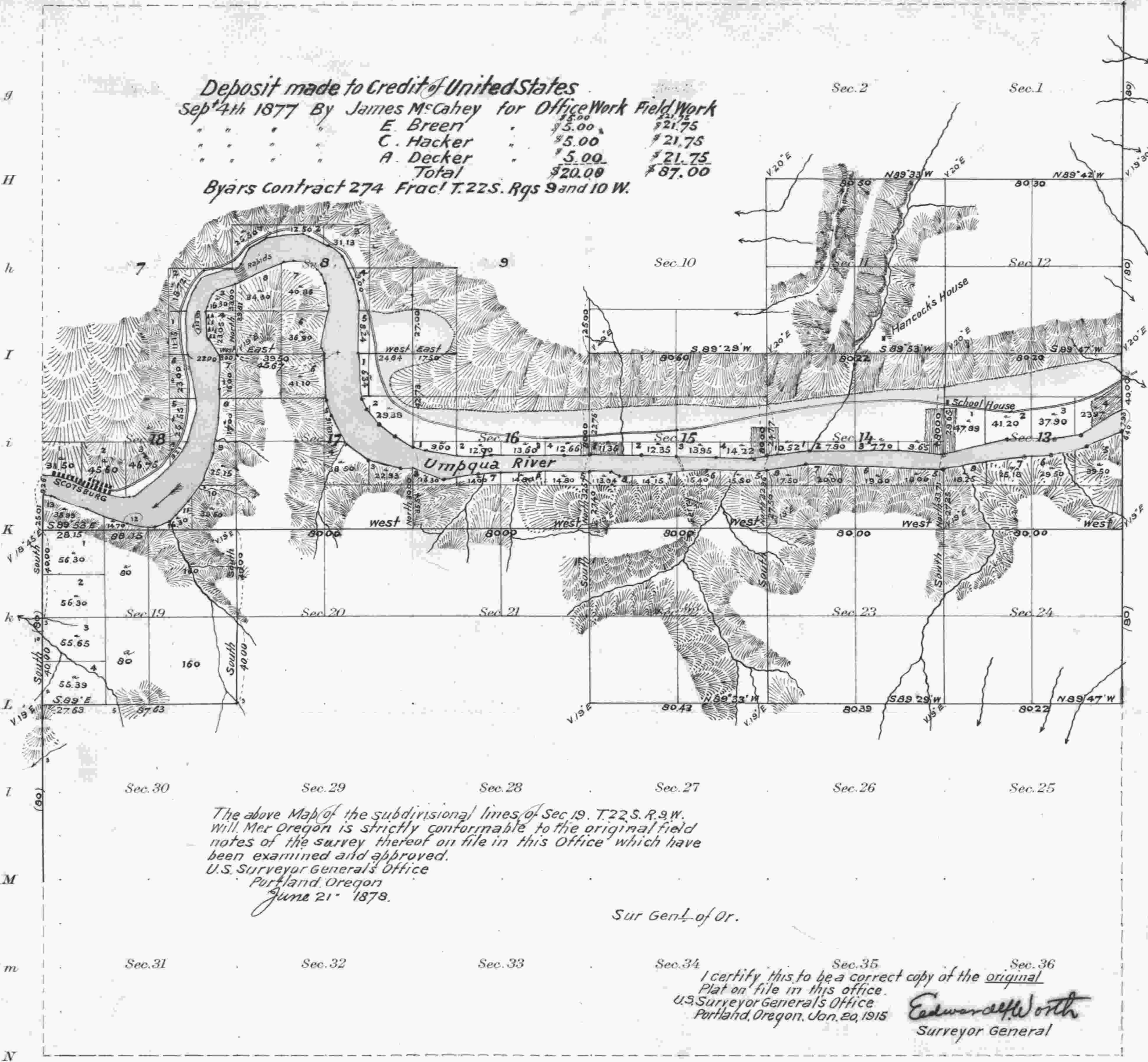

The above Map of the subdivisional lines of Sec 19, T. 22 S. R. 9 W. Will. Mer Oregon is strictly conformable to the original field notes of the survey thereof on file in this Office which have been examined and approved.
 U.S. Surveyor General's Office
 Portland Oregon
 June 21st 1878.

Sur Gen^l of Or.

I certify this to be a correct copy of the original Plat on file in this office.
 U.S. Surveyor General's Office
 Portland, Oregon, Jan. 20, 1915
 Edward A. Worth
 Surveyor General

Meanders of the South bank of Umbqua River in T. 22 S. R. 9 W. Begin at the M. P. on South side of River and West boundary of Section 18, and run

East	4.00	Chs	
S. 93° E	3.00		
75°	13.50		
69°	20.50		
80°	13.50		
N 85°	11.00		
32°	7.00		
40°	12.00		
21°	13.00		
North	5.00		
09°	12.00		
02°	13.00		
07° W	10.00		To M.P.
35°	14.00		
13° E	2.00		
23°	6.50		
65°	11.00		
74°	10.10		To M.P.
59°	1.00		
78°	2.00		
87°	21.00		
85°	5.88		
S 78°	7.50		
55°	3.00		
45°	2.50		
19°	5.88		
12°	3.88		
07° E	23.00		
05° E	3.50		To M.P.
22°	8.50		
35°	15.00		
53°	12.00		
70°	15.00		
East	4.18		To M.P.
70°	13.00		
N 85°	38.00		To M.P.
East	38.07		To M.P.
11.00			
S 74°	3.50		
N 87°	48.00		
S 85°	24.87		To M.P.
N 78°	18.50		To M.P.
S 87°	42.83		To M.P.
N 80°	38.00		
East	12.50		
W 78°	18.50		To M.P. East boundary To
83°	17.18		
Total	662.30		

Meanders of an Island in Sec 7 T. 22 S. R. 9 W. Lower end of Island from Station N^o 2 of the Meander of the South bank of River bears N 67° W 551 chs dist

N 40° W	1.00	Chs	
North	5.00		
17° E	6.75		
East	5.00		
S 09°	10.25		
49° W	4.10		To place of beginning
Total	28.60		

Sections	Acres
7	42.48
8	152.00
10	160.00
11	640.00
12	640.00
13	432.45
14	394.50
15	378.09
16	217.30
17	475.69
18	134.74
19	352.60
20	320.00
21	320.00
22	640.00
23	640.00
24	640.00
Total	6580.48

Total Acres 351.04

Areas in Acres	
Public Land	
Indian Reservation	
Indian Allotments	
Mineral Claims	
Water Surface	
Total Area	

Scale 40 Chains to an inch
 Mean Magnetic Declination

Lines	Contractor	Contract No.	Date	Amount of Surveys			When Surveyed	
				Mile	links	chains	Commenced	Completed
Subdivisions	W. H. Byars	202	March 11, 1874	25	60	03	August 26 th 1874	November 10, 1874
Meanders	"	"	"	8	51	90		
			Total	34	31	93		
Exteriors	"	"	"					
Subdivisions	W. H. Byars	274	Sept 10 th 1877	1	47	63	Nov 15 th 1877	Nov 15 th 1877

The above map of Township No. 22 South Range No. 9 West of the Will. Mer Oregon is strictly conformable to field notes of the survey thereof on file in this office, which have been examined and approved
 U. S. Surveyor General's Office.
 Portland Oregon August 2nd 1878
 Ben Simpson
 Sur Gen^l of Or