

TOWNSHIP 22 SOUTH, RANGE 6 WEST, OF THE WILLAMETTE MERIDIAN, OREGON.

DEPENDENT RESURVEY

Sec. 17

Sec. 16

Sec. 19

Sec. 20

Sec. 21

Sec. 30

Sec. 29

Latitude 43°37.7' N. Sec. 28
Longitude 123°25.6' W.

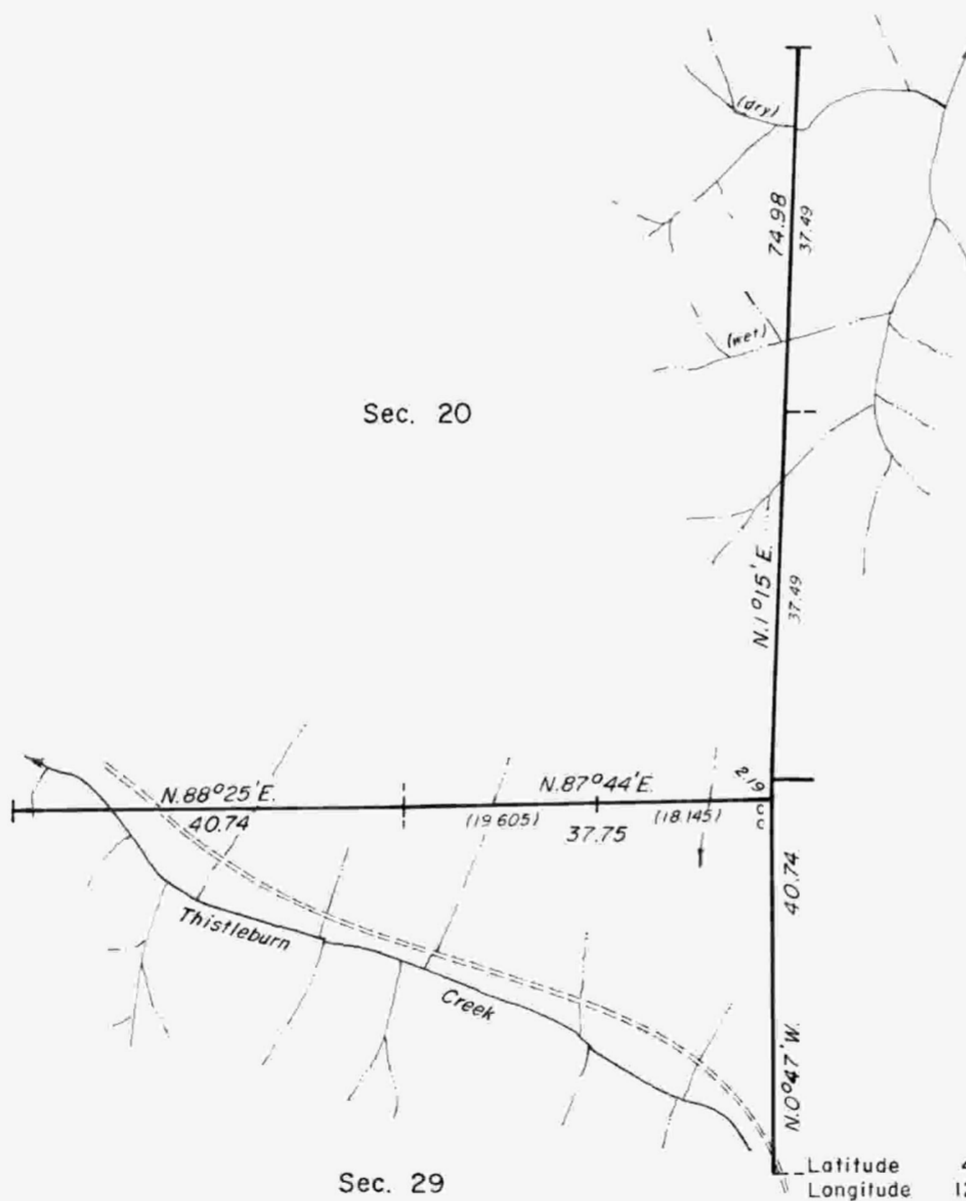

A history of surveys is contained in the field notes.

This plat represents a dependent resurvey of a portion of the subdivisional lines, T. 22 S., R. 6 W., Willamette Meridian, Oregon, designed to restore the corners in their true original locations according to the best available evidence.

The survey was executed by James E. Jelley, Cadastral Surveyor, beginning August 20, 1981 and completed September 14, 1981, pursuant to Special Instructions dated July 20, 1981, for Group No. 1073, Oregon.

Timber in this area consists of fir, hemlock, cedar, maple, oak, madrone, chinquapin, and alder.

UNITED STATES DEPARTMENT OF THE INTERIOR
BUREAU OF LAND MANAGEMENT
Portland, Oregon September 23, 1983

This plat is strictly conformable to the approved field notes, and the survey, having been correctly executed in accordance with the requirements of law and the regulations of this Bureau, is hereby accepted.

For the Director

William W. Glenn

Chief Cadastral Surveyor of Oregon

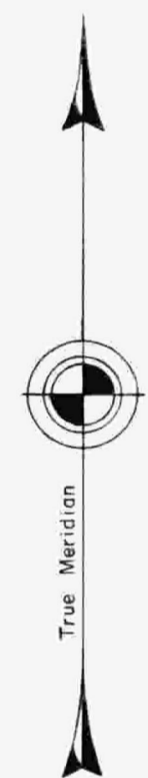

Mean magnetic declination 18°30' East

