

Township N<sup>o</sup> 22 South Range N<sup>o</sup> 6 West Willamette Meridian

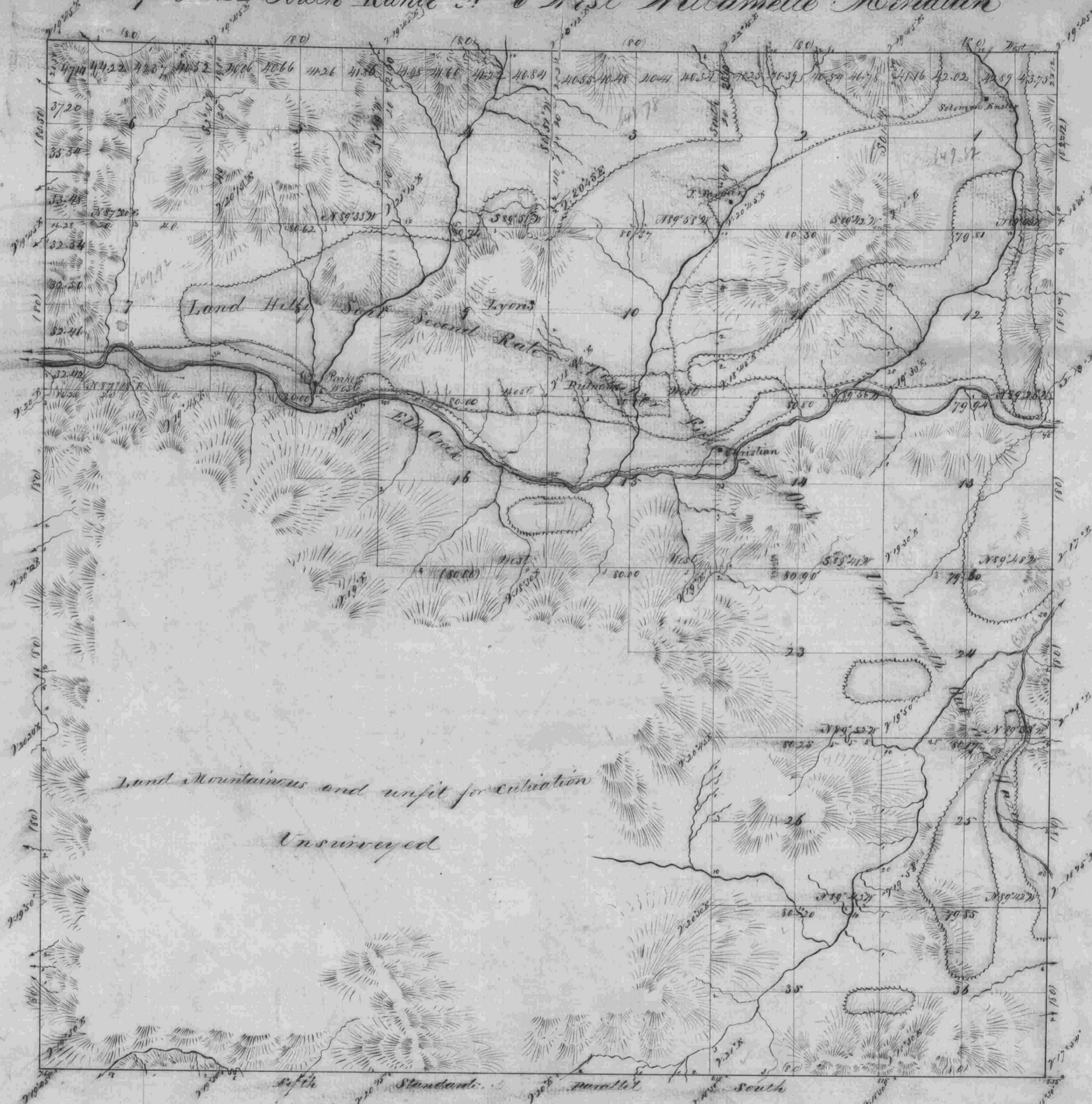

Surveys designated	By whom surveyed	Contract No	Date	Amt of Surveys Kils Chain links	When surveyed
Township Lines	Gordon & Gardner	52	February 17 <sup>th</sup> 1855	6 3 50	Sept 24 <sup>th</sup> 1855
Subdivisions	Gordon & Gardner	52	Feb. 17 <sup>th</sup> 1855	39 77 56	Feb 2 <sup>nd</sup> 20 <sup>th</sup> 1856
Reck <sup>d</sup> Stand Parallel	"	"	"	2 00 00	" " "
Total Number of Acres 14393.28					

The above Map of Fractional Township N<sup>o</sup> 22 South of Range N<sup>o</sup> 6 West of the Willamette Meridian Territory of Oregon is strictly conformable to the field notes of the Survey thereof on file in this office which have been examined and approved.  
 Surveyor General's Office  
 Salem February 20<sup>th</sup> 1856.

C. R. Gardner  
 Surv. Gen of Oregon