

TOWNSHIP 22 SOUTH, RANGE 5 WEST, OF THE WILLAMETTE MERIDIAN, OREGON.

DEPENDENT RESURVEY

Sec. 35

Sec. 36

Sec. 2

Sec. 1

Sec. 6

Sec. 11

Sec. 12

Sec. 7



Mean magnetic declination 19°00' East

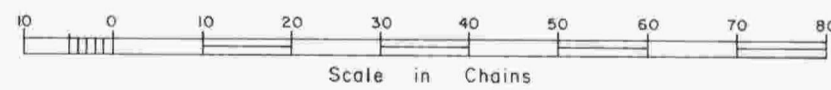
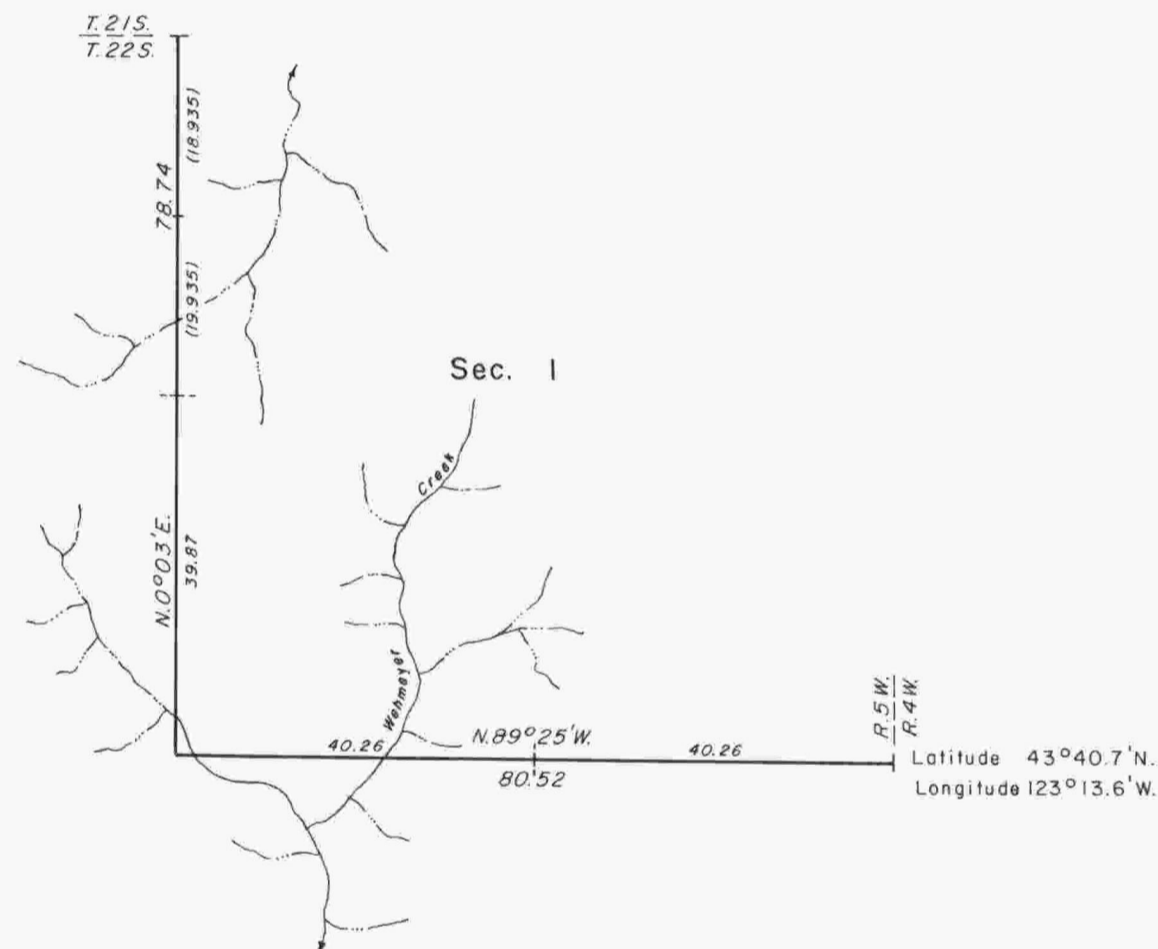

A history of surveys is contained in the field notes.

This plat represents a dependent resurvey of a portion of the subdivisional lines of T. 22 S., R. 5 W., Willamette Meridian, Oregon, designed to restore the corners in their true original locations according to the best available evidence.

The survey was executed by James E. Jelley and Wayne L. Rogers, Cadastral Surveyors, beginning June 17, 1982, and completed July 8, 1982, pursuant to Special Instructions dated May 13, 1982, for Group No. 1103, Oregon.

Timber in this area consists of fir, yew, hemlock, cedar, chinquapin, oak, madrone, cascara, ash, and alder.

UNITED STATES DEPARTMENT OF THE INTERIOR
BUREAU OF LAND MANAGEMENT
Portland, Oregon September 21, 1984

This plat is strictly conformable to the approved field notes, and the survey, having been correctly executed in accordance with the requirements of law and the regulations of this Bureau, is hereby accepted.

For the Director

William W. Glenn

Chief Cadastral Surveyor of Oregon