

Township N^o 22 South Range N^o 5 West Willamette Meridian.

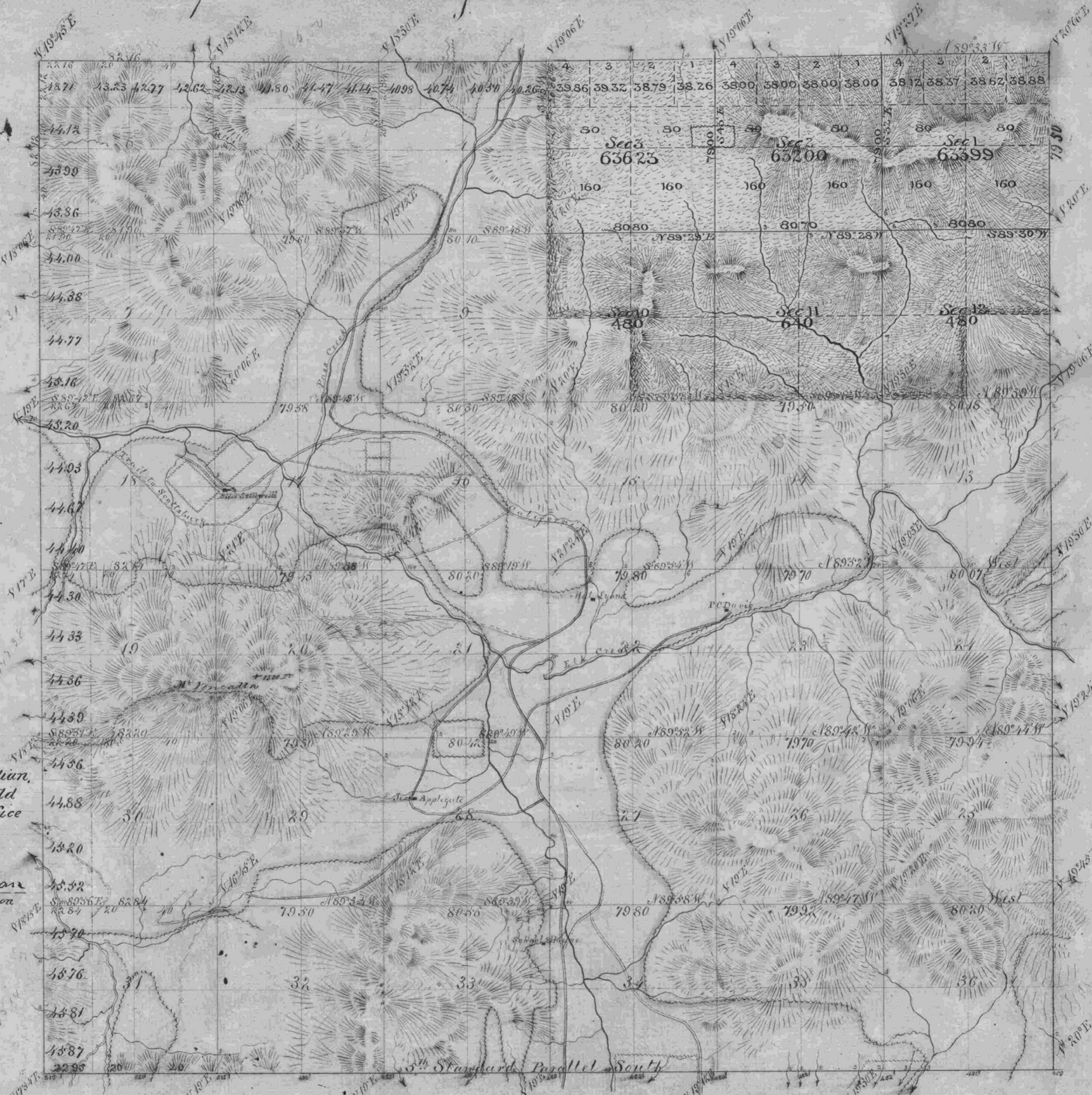

March 17, 1885
Cont 514 ACCEPTED BY THE HON. COMMISSIONER G. L. O.

True Meridian
Mean mag. of Observatory 19° 30' 27"

The above map of the remainder of the subdivisions of Township No 22 South of Range No 5 West, of the Willamette Meridian, Oregon, is strictly conformable to the Field Notes of the survey thereof on file in this Office which have been examined and approved.

U.S. Surveyor-General's Office
Portland, Oregon

Feb 25, 1885
James C. Johnson
Surveyor General of Oregon

Area of Former Survey 19,336.51 Acres — of New Survey 3,502.22 Acres Total number of Acres 22,838.73

Surveys designated	By whom surveyed	Contract		Amt of surveys		When surveyed.
		N ^o	Date	Miles	chains links	
Township Lines.	Gordon & Gardner	52	Feb 4 17 th 1853	6	2 12	Sept. 27 th 1858
Subdivisions.	" "	52	" " "	53	11 75	Feb 20 th 1856
Recl ^d Stand ^d Paral ^l	" "	52	" " "	6	2 95	" " "
Total Number of Acres 19,336.51						
Subdivisions	William P. Wright	514	Aug 27 th 1884	7	00 30	Oct 10 to Oct 14, 84

The above Map of Fractional Township N^o 22 South of Range N^o 5 West of the Willamette Meridian, Territory of Oregon is strictly conformable to the field notes of the survey thereof on file in this Office which have been examined and approved.

Surveyor General's Office.
Valent February 20th 1856.

E. K. Gardner
Surv. Gen. of Oregon