

# TOWNSHIP 21 SOUTH, RANGE 12 WEST, OF THE WILLAMETTE MERIDIAN, OREGON

## DEPENDENT RESURVEY AND SUBDIVISION OF SECTIONS

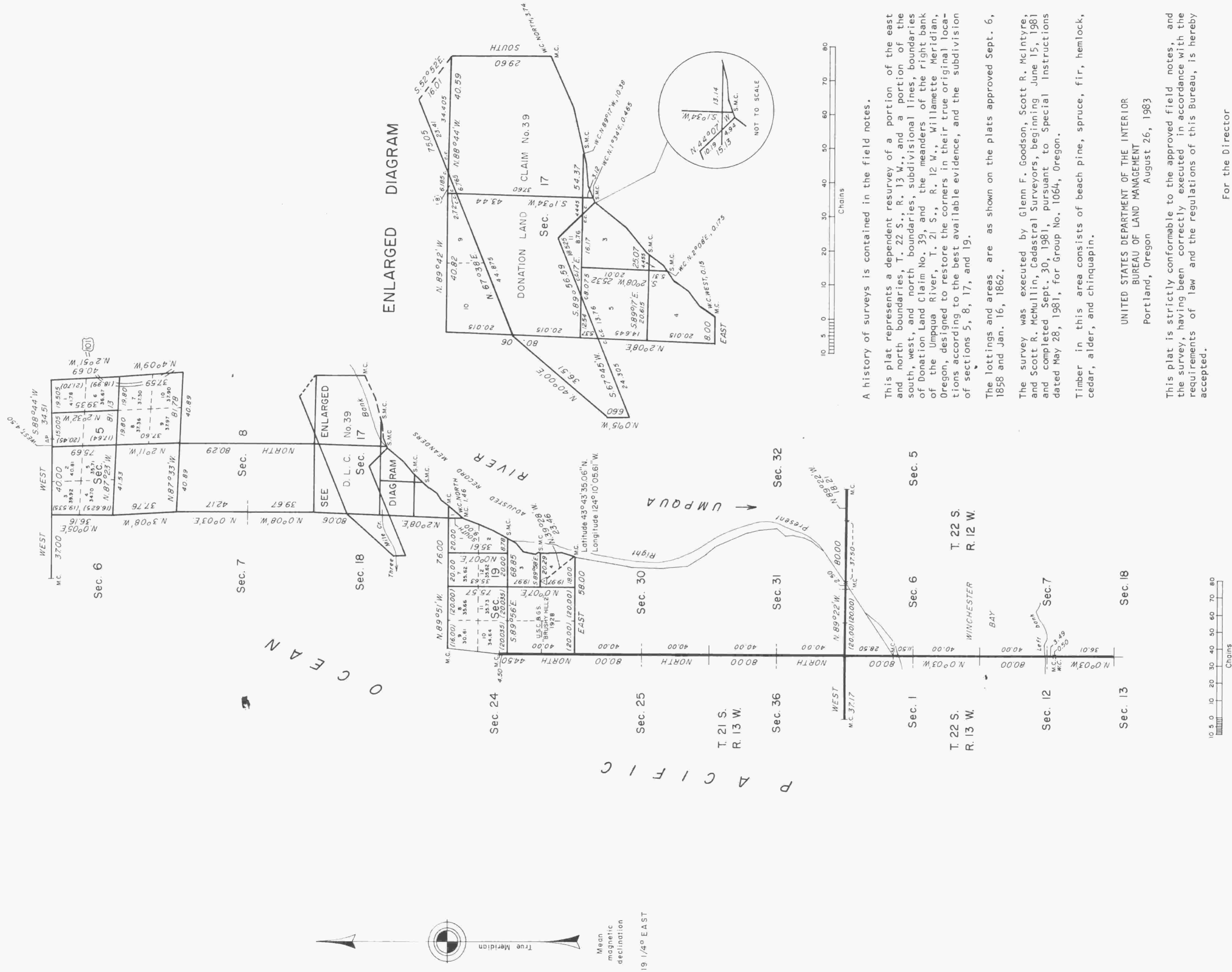

A history of surveys is contained in the field notes.

This plat represents a dependent resurvey of a portion of the east and north boundaries, T. 22 S., R. 12 W., and a portion of the south, west, and north boundaries, subdivisional lines, boundaries of Donation Land Claim No. 39, and the meanders of the right bank of the Umpqua River, T. 21 S., R. 12 W., Willamette Meridian, Oregon, designed to restore the corners in their true original locations according to the best available evidence, and the subdivision of sections 5, 8, 17, and 19.

The lottings and areas are as shown on the plats approved Sept. 6, 1858 and Jan. 16, 1862.

The survey was executed by Glenn F. Goodson, Scott R. McIntyre, and Scott R. McMullin, Cadastral Surveyors, beginning June 15, 1981 and completed Sept. 30, 1981, pursuant to Special Instructions dated May 28, 1981, for Group No. 1064, Oregon.

Timber in this area consists of beach pine, spruce, fir, hemlock, cedar, alder, and chinquapin.

UNITED STATES DEPARTMENT OF THE INTERIOR  
BUREAU OF LAND MANAGEMENT  
Portland, Oregon August 26, 1983

This plat is strictly conformable to the approved field notes, and the survey, having been correctly executed in accordance with the requirements of law and the regulations of this Bureau, is hereby accepted.

For the Director

*William W. Glenn*

Chief Cadastral Surveyor of Oregon