

Township No 21 South Range No 12 West, Willamette Meridian,

G r f e E d D e C b B a A

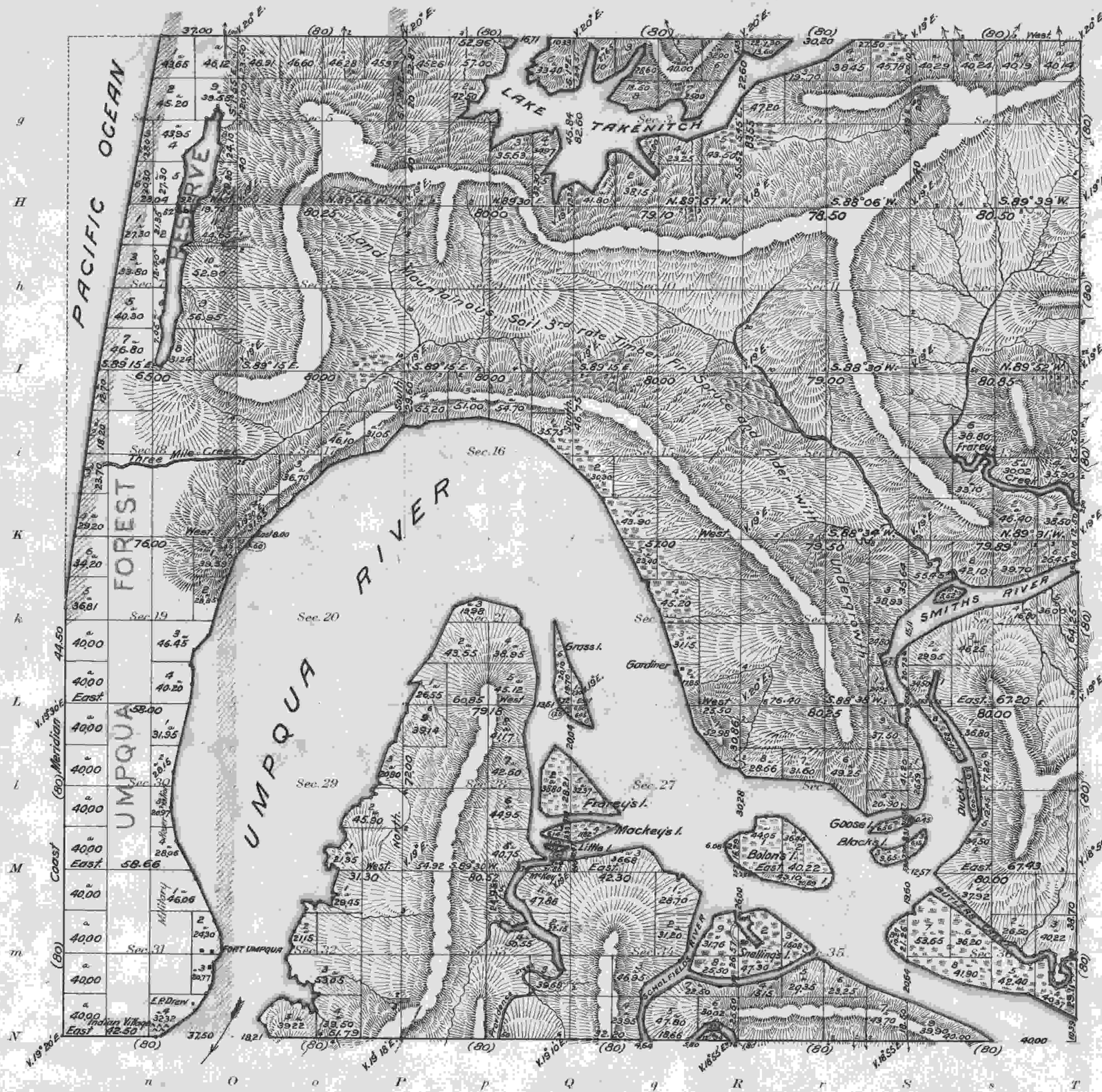

I certify this to be a correct copy of the original plat on file in this office.  
 U.S. Surveyor General's Office,  
 Portland, Oregon.  
 Dec. 7, 1918. *Edward M. Witt*  
 Surveyor General of Oregon.

Areas in Acres	
Public Land	
Indian Reservation	
Indian Allotments	
Mineral Claims	
Water Surface	
<b>Total Area</b>	

Scale 30 Chains to an inch  
 Mean Magnetic Declination

Surveys Designated	By Whom Surveyed	Contract		Amount of Surveys			When Surveyed
		No.	Date	Mts.	chs.	fts.	
Township Lines	Harvey Gordon	69	February 2 <sup>d</sup> 1857	12	00	00	September 6 <sup>th</sup> 1858
Subdivisions	Harvey Gordon	69	February 2 <sup>d</sup> 1857	47	70	67	September 6 <sup>th</sup> 1858
Meanders	"	"	"	61	40	07	"
Total number of Acres		17116.03					

Fractional  
 The above map of Township No 21 South Range No 12 West of the Willamette  
 Territory of Oregon is strictly conformable to the field notes of the survey thereof on file  
 in this office, which have been examined and approved  
 Surveyor General's Office. (SIGNED) *John S. Gieber*  
 Salem, September 6<sup>th</sup> 1858  
 Surveyor General of Oregon.