

TOWNSHIP NO. 21 SOUTH, RANGE NO. 8 WEST OF THE WILLAMETTE MERIDIAN, OREGON.

DEPENDENT RESURVEY

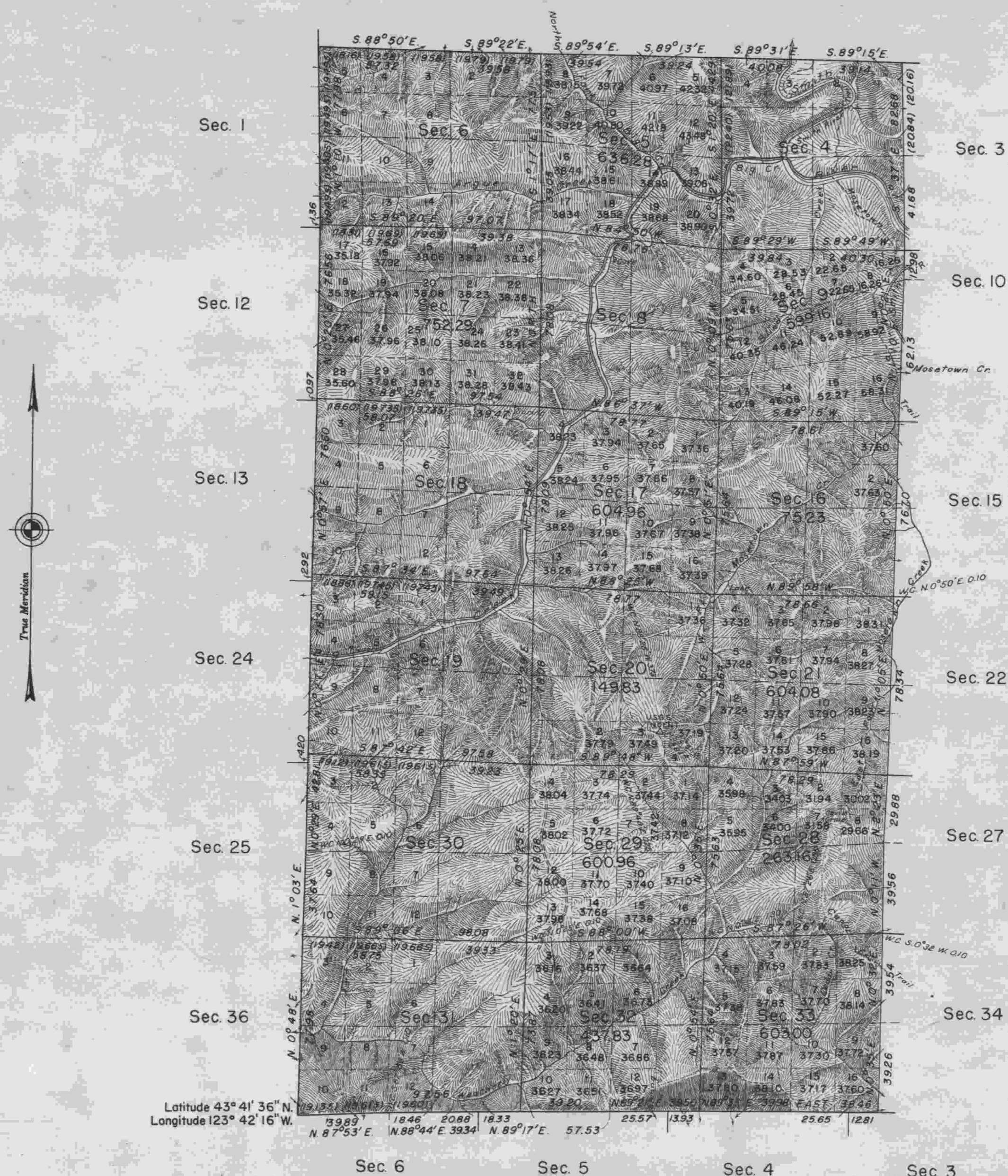

MEMORANDUM

This plat delineates a retracement and reestablishment of the lines of the original survey in their true original positions according to the best available evidence of the position of the original corners; all differences between the measurements shown on the original plat and those derived in the retracement have been distributed proportionally between accepted corners in accordance with surveying rules; reference will be made to the original plat for the showing of areas and more detailed descriptions of the various smaller subdivisions, except where new areas are shown hereon.

Resurvey authorized by General Land Office teletype message dated Feb. 15, 1945.

Some patches of heavy timber consisting of fir, hemlock, cedar, alder, maple, chinquapin, madrona, yew, dogwood, cherry, and cascara are found in this area.

Latitude 43° 41' 36" N.
Longitude 123° 42' 16" W.

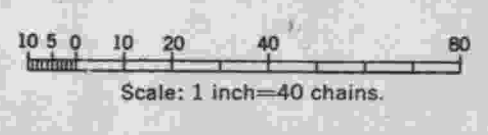

UNITED STATES DEPARTMENT OF THE INTERIOR
BUREAU OF LAND MANAGEMENT

Denver, Colorado, August 26, 1946.

Washington, D. C., MARCH 10, 1947

This plat is strictly conformable to the field notes of the survey which have been examined and approved.

The survey represented by this plat, having been correctly executed in accordance with the requirements of law and the regulations of this office, is hereby accepted.

[Signature]
Acting Chief Cadastral Engineer

[Signature]
ACTING ASSISTANT DIRECTOR

Mean Magnetic Declination 21° 15' E.

Area resurveyed: 12086.56 acres.

| LINES DESIGNATED | BY WHOM SURVEYED | GROUP NO. | DATE OF SPECIAL INSTRUCTIONS | WHEN SURVEYED | |
|------------------|---|-----------|------------------------------|---------------|---------------|
| | | | | BEGUN | COMPLETED |
| Exterior | Norman D. Price (Geo. F. Rigby Norman D. Price) | 282 | February 19, 1945 | May 1, 1945 | Aug. 31, 1945 |
| Subdivisional | | | | | |
| Miscellaneous | | | | | |

TOPOGRAPHY WITHIN SECTIONS COMPILED FROM AERIAL PHOTOGRAPHS AND COORDINATED WITH SECTION LINE CONTROL OBTAINED DURING SURVEY.