

Charles Johnson
1859 - 1864
1859 - 1864
1859 - 1864

Thomas G. Williams
March 1859
Imp 75⁰⁰

Benja. Wood
1859 - Imp not given
William Wood
April 1858
Imp 400⁰⁰

Manan Cain,
Date of settlement not given
Imp 609⁵⁰ W.H. Kellogg
Imp 300⁰⁰
Date of settlement not stated

John W. Wood
May 1858
Imp 4500⁰⁰

James Carpenter
1859 Imp 75⁰⁰
25

Area	
Sections	Acres
27	160.00
28	160.00
29	160.00
30	160.00
31	637.40
32	640.00
33	640.00
34	160.00
Total	3297.40

335740

General Description
The bottom lands in this Township are rich; but the bottoms are all narrow and heavily timbered. They are the only portions available for cultivation. The adjoining mountains are very steep and abrupt, are covered with a heavy growth of Fir timber. The mountains and mountain benches are covered with sandstone and fine gravel. This Township is only sought after for its timber.

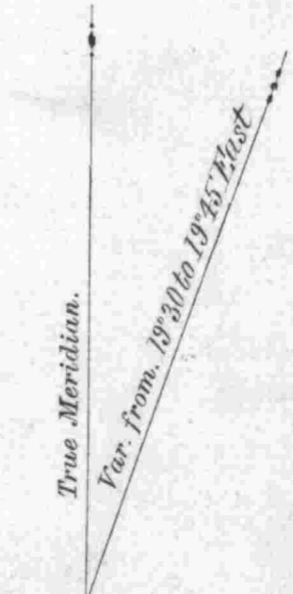
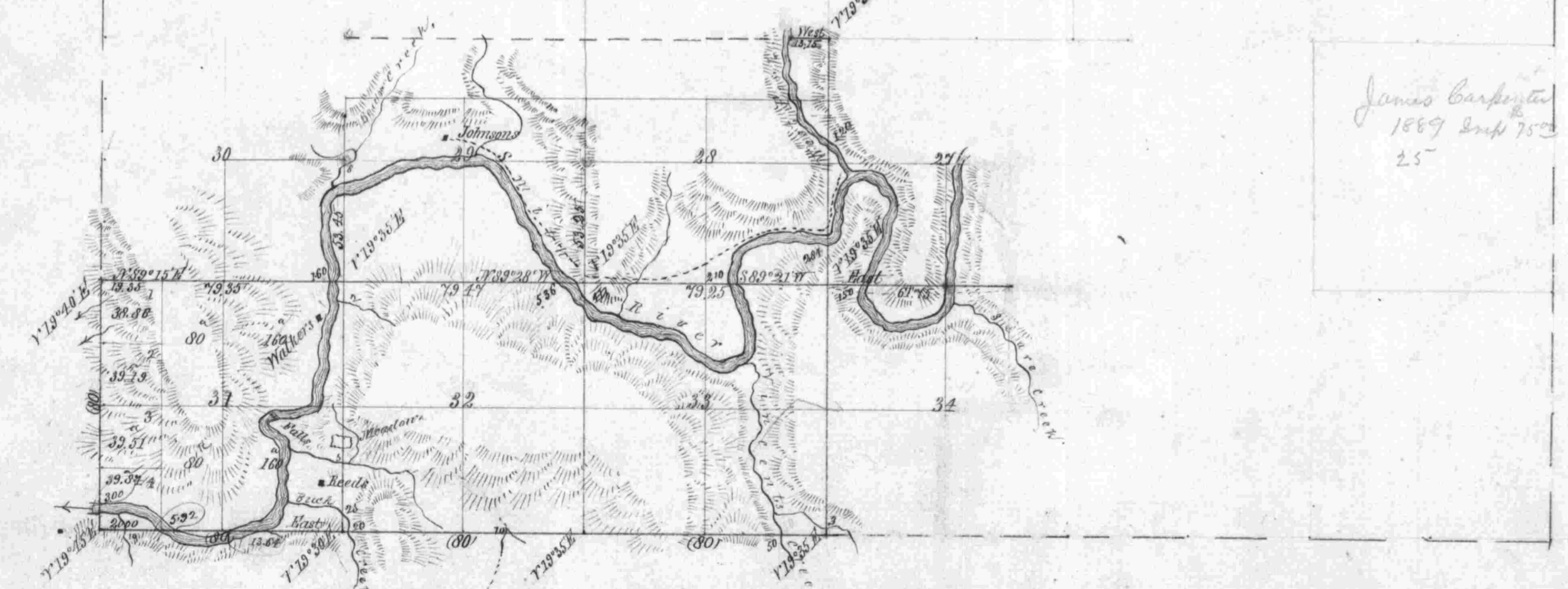

Scale 40 Chains to an inch

Lines.	Contractor.	Contract.		Amount Surveyed.			Commenced.	Completed.
		No.	Date.	Miles.	Chains.	Links.		
Subdivisions Esoteric	William Wheel	260	April 17 1877	9	19	67	June 9th 1877	June 16th 1877

The above Map of the subdivisinal lines of Township No. 20 South Range No. 9 West Willamette Meridian, Oregon, is strictly conformable to the original field notes of the survey thereof on file in this office, which have been examined and approved.
U. S. Surveyor General's Office,
Portland, Oregon,
July 3^d 1878
Surveyor General of Oregon.