

# TOWNSHIP 20 SOUTH, RANGE 8 WEST, OF THE WILLAMETTE MERIDIAN, OREGON.

DEPENDENT RESURVEY

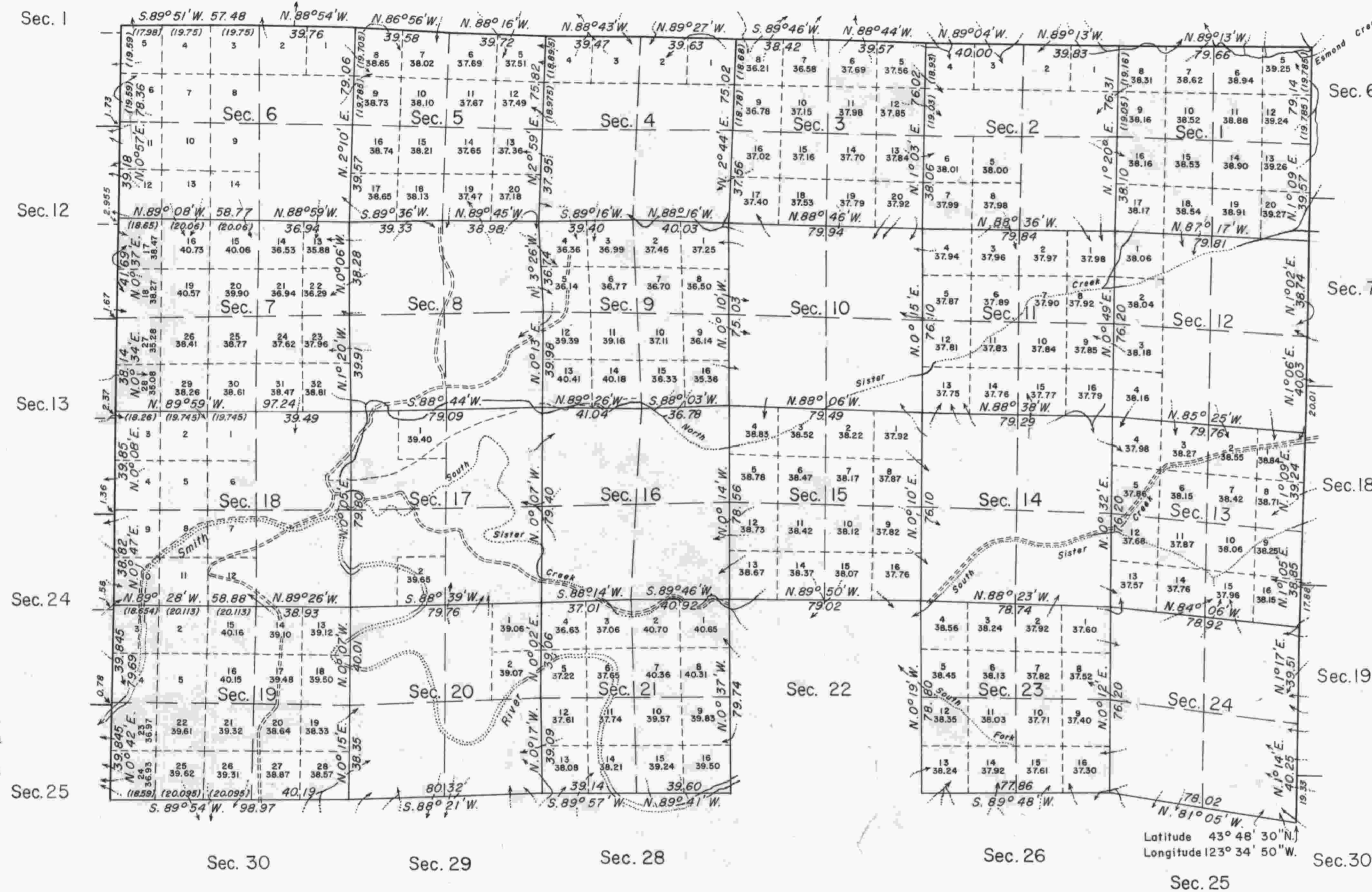

True Meridian

Mean magnetic declination  
21° 20' East

Timber in this area consists of Douglas fir, western hemlock, red cedar, Oregon maple, and alder.

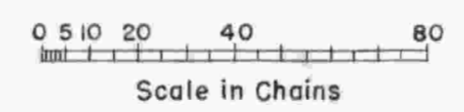

Area resurveyed: 14,973.71 acres

This plat represents a retracement and reestablishment of the north, east, and west boundaries and a portion of the subdivisional lines designed to restore the corners in their true original location according to the best available evidence; and excepting as new or modified vacant subdivisions are shown hereon, the lottings and areas are as shown on the plats approved August 4, 1884 and February 7, 1952.

The boundaries and subdivisional lines surveyed by William P. Wright in 1883-1884.

The north boundary resurveyed by Charles M. Collier in 1891.

A portion of the north boundary resurveyed by Lytle and Norseth in 1952.

A portion of the south boundary resurveyed by Norman D. Price in 1945.

The east boundary resurveyed by Thomas E. Todd in 1891.

A portion of the south, east, and west boundaries and a portion of the subdivisional lines of T. 20 S., R. 8 W., Willamette Meridian, Oregon, executed by Thomas A. Tillman, Raymond M. Bicknell, Hans W. Thilsen, and Joseph S. Gawron, August 13, 1953 to September 24, 1954, under Special Instructions dated August 1, 1952, which provide for the surveys included under Group 305, Oregon.

A portion of the west boundary resurveyed by Alonzo Gesner in 1893.

Dependent resurvey of portions of the north, east, and west boundaries and a portion of the subdivisional lines of T. 20 S., R. 8 W., Willamette Meridian, Oregon, executed by Thomas A. Tillman, Raymond M. Bicknell, Hans W. Thilsen, and Joseph S. Gawron, August 13, 1953 to September 24, 1954, under Special Instructions dated August 1, 1952, which provide for the surveys included under Group 305, Oregon.

UNITED STATES DEPARTMENT OF THE INTERIOR  
BUREAU OF LAND MANAGEMENT  
Washington, D. C. February 3, 1960

This plat is strictly conformable to the approved field notes, and the survey, having been correctly executed in accordance with the requirements of law and the regulations of this Bureau, is hereby accepted.

For the Director

*James H. [Signature]*  
Cadastral Engineering Staff Officer