

TOWNSHIP 20 SOUTH, RANGE 6 WEST, OF THE WILLAMETTE MERIDIAN, OREGON.
DEPENDENT RESURVEY

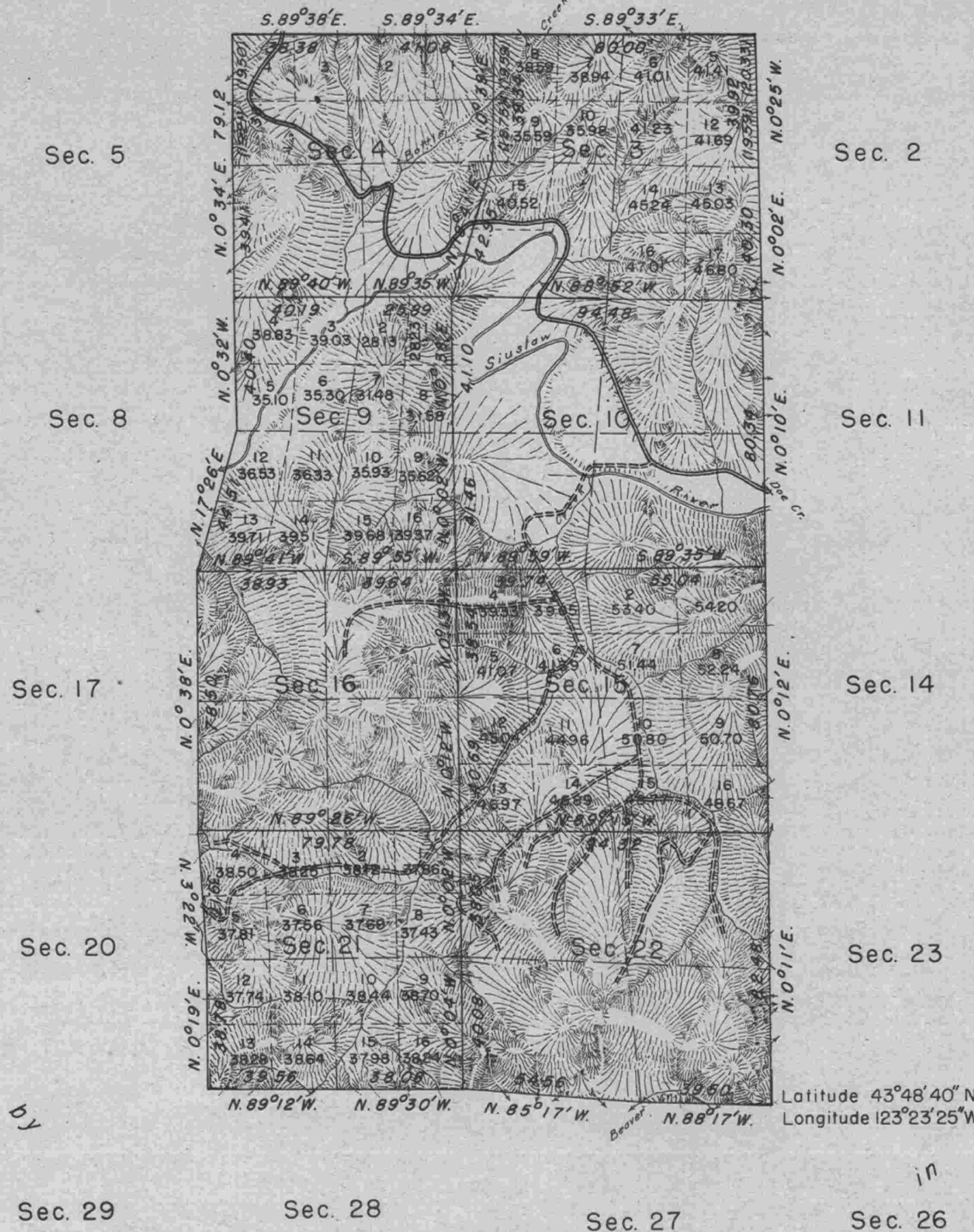

This plat represents a retracement and reestablishment of portions of the original township boundary and subdivisional lines designed to restore the corners in their original locations according to the best available evidence. The lottings and areas are as shown on the plat approved January 23, 1873 except as new areas are shown hereon.

The forest cover is heavy Douglas fir, hemlock, red cedar, Oregon maple, alder, chinquapin, yew, madrona and Cascara, with Douglas fir by far the predominating specie.



Mean Magnetic Declination 20° 37' East

Surveyed

1872

Latitude 43° 48' 40" N.
Longitude 123° 23' 25" W.

J. H. McClung

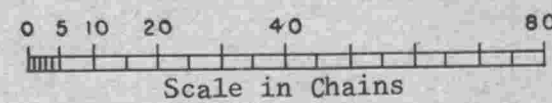

Area Resurveyed: 5,159.06 Acres

UNITED STATES DEPARTMENT OF THE INTERIOR
BUREAU OF LAND MANAGEMENT
Washington, D. C., August 16, 1951

This plat is strictly conformable to the approved field notes, and the survey, having been correctly executed in accordance with the requirements of law and the regulations of this Bureau, is hereby accepted.

For the Director
William F. Richards
Chief, Branch of Surveys

Line between secs. 9 and 10 resurveyed by Norman D. Price in 1948.

Dependent resurvey of a portion of the north boundary and a portion of the subdivisional lines executed by Marvin J. Lytle June 6 to August 14, 1950 under Special Instructions for Group 293 Oregon, dated May 8, 1950.