

Township 20 South, Range 6 West.

Duplicate

Area	
Sections	Acres
1	443.48
2	446.69
3	446.62
4	444.80
5	440.10
6	434.44
7	440.00
8	440.00
9	440.00
10	440.00
11	440.00
12	440.00
13	440.00
14	440.00
15	440.00
16	440.00
17	440.00
18	440.00
19	440.00
20	440.00
21	440.00
22	440.00
23	440.00
24	440.00
25	440.00
26	440.00
27	440.00
28	440.00
29	440.00
30	440.00
31	440.00
32	440.00
33	440.00
34	440.00
35	440.00
36	440.00
Total	23064.52

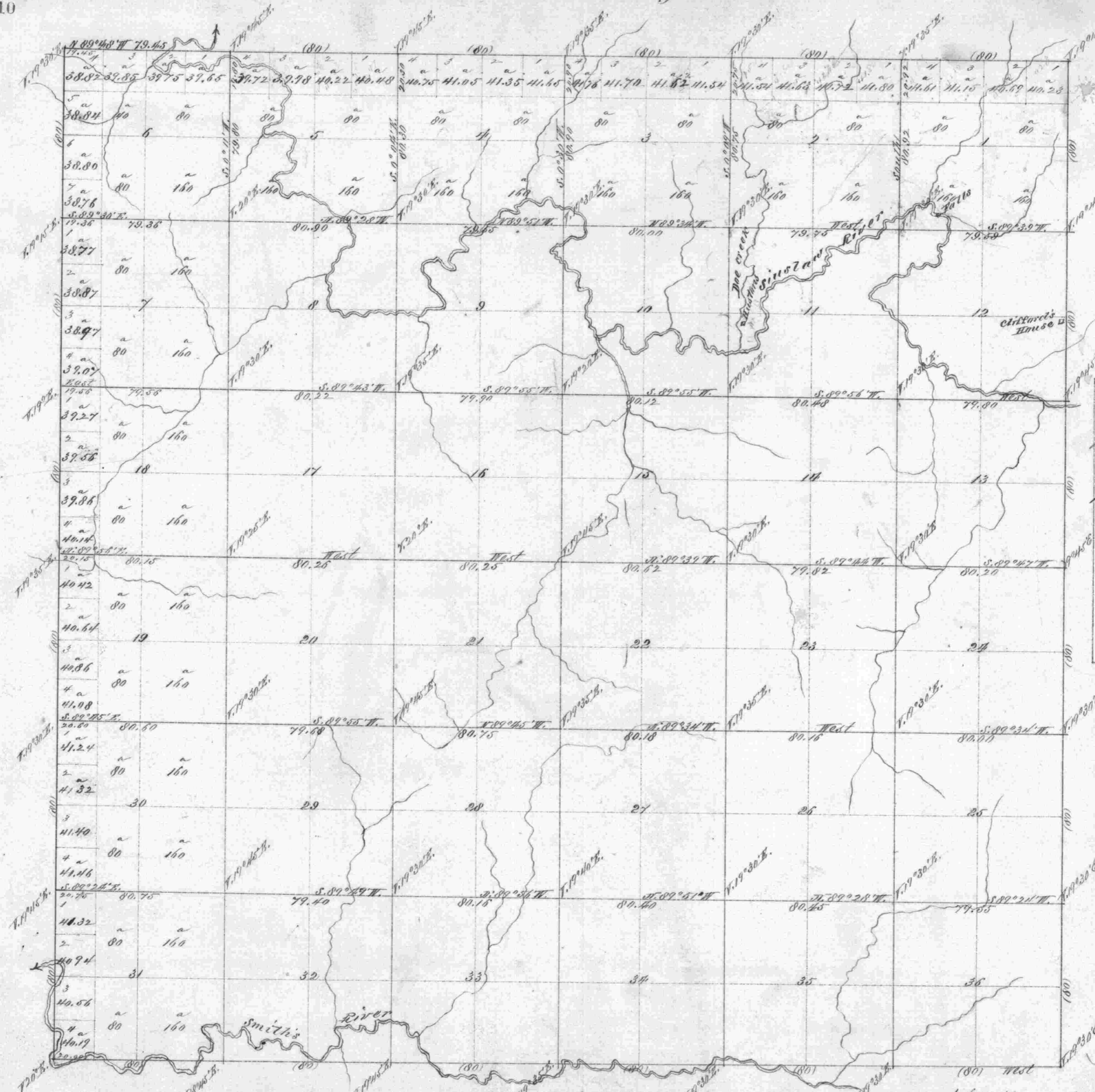

General Description
 The lands in this township are generally rough, rugged and second only to forest of spruce and hemlock timber and a few undergrowth of thin maple, maple for fuel, chinquapin, etc. The soil on the mountains is 2^d and 3^d rate, while that along the streams is either 1st or 2^d rate. The only level land of any consequence lies along streams and Smith's river, and this consists of narrow bottoms heavily timbered and covered with a dense undergrowth.



Lines	Contractor	Contract No.	Date	Acres Surveyed	Sections	Commenced	Completed
Subdivisions	J. C. McClung	173	July 20, 1872	60	5 37	Aug. 15, 1872	Sept. 10, 1872

The survey of the Subdivisional lines of the above map of Township 20 South, Range 6 West Tillamette Meridian, Oregon, is strictly conformable to the original field notes on file in this office, which have been examined and approved -
 Surveyor General's Office
 Eugene Jan. 23^d 1873
 N. H. Odell
 Surveyor General - Cal.