

THIS PLAT REPRESENTS THE ENTIRE RECORD OF THE DEPENDENT RESURVEY

TOWNSHIP 19 SOUTH, RANGE 9 WEST, OF THE WILLAMETTE MERIDIAN, OREGON

DEPENDENT RESURVEY

FILED Date: 8/21/2017 By: JC This survey consists of: Map PLAT: T19-S-2017-1 Narrative: VOL: 58 PAGES Corner Rpt: 23422 THE SEPARATE USER NOTES DOUGLAS COUNTY SURVEYOR

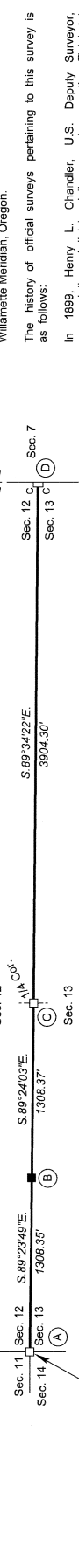

Latitude 43°55'45.86"N Longitude 123°43'42.73"W NAD 1983 (2011)

This plat constitutes the entire record of the dependent resurvey of a portion of the subdivisional lines, designed to restore the corners in their true original locations according to the best available evidence. Township 19 South, Range 9 West, Willamette Meridian, Oregon.

The history of official surveys pertaining to this survey is as follows: In 1899, Henry L. Chandler, U.S. Deputy Surveyor, surveyed the subdivisional lines, as shown on the official plat of survey approved February 12, 1901.

In 1957-58, Thomas A. Tillman, Robert L. Holm, and Floyd A. Brooks, Cadastral Surveyors, dependent resurveyed the east boundary and a portion of the subdivisional lines, as shown on the official plat of survey accepted January 7, 1963. The following local surveys filed in the Douglas County Surveyor's Office are referred to in the subsequent corner descriptions and are referenced by surveyor's last name, official title or Professional Land Surveyor (PLS) No., and year.

The directions of the lines are based on the true meridian as determined by Global Positioning Systems (GPS) techniques and carried forward by sustained angulation using conventional survey techniques. All measurements along the lines were made through the use of GPS and electronic data collection techniques. Measured distances and directions have been adjusted by computer software that incorporates a least squares adjustment routine. The adjusted mean bearings and mean horizontal ground elevation distances are reported to the nearest second and 0.01 foot.

Preliminary to the resurvey, the lines of the official original surveys and resurveys were retraced and a search was made for all corners, lines, other calls of record, and where available, collateral evidence of local surveys and other corners. The retracement data was thoroughly verified and only the true line file data are given herein.

A magnet in a white plastic case was deposited at the base of each stainless steel post, and each new bearing tree has a 2 1/2 inch x 1/4 inch magnetic nail (Mag Nail) driven at the base on right side center, unless otherwise noted in the corner description. Only those lines bounding Federal interest land were blazed.

The geographic position shown herein was determined by ties to temporary GPS control points utilizing dual frequency carrier phase GPS receivers, and processed using the National Geodetic Survey's Online Positioning User Service (OPUS). The survey was executed in accordance with the specifications set forth in the Manual of Surveying Instructions (2009), and the special instructions approved August 17, 2015, for Group No. 2799, Oregon, by Joseph M. Mannix, Cadastral Surveyor, beginning August 19, 2015, and completed August 31, 2015. He was assisted by Daniel B. Bliss and Luke A. Chapman, Surveying Technicians.

UNITED STATES DEPARTMENT OF THE INTERIOR BUREAU OF LAND MANAGEMENT

Portland, Oregon

The survey represented by this plat, having been correctly executed in accordance with the requirements of law and the regulations of this Bureau, is hereby accepted.

For the Director

Signature of Director

Chief Cadastral Surveyor of Oregon

February 9, 2017 Date

(D) The oblong cor. of secs. 12 and 13, on the E. bdy. of the 'P', perpetuated in 2014, monumented with an iron post, 2 1/2 ins. diam., firmly set, projecting 3 ins. above ground, in a collar of stone, 3 ft. base, with a brass cap mkd.

T 19 S | T 19 S S 12 | S 7 R 9 W | R 8 W 1958

Add the marks CC 2016 to the brass cap.

from which the remains of a bearing tree mkd. by Tillman, et al. in 1957-58

A hemlock snag, 28 ins. diam., bears S. 50 1/2° W., 80.6 ft. dist., with a healed blaze and a nail driven into the top of the snag center. (Record S. 49 1/2° W., 82.3 ft. dist.)

and the remains of a bearing tree mkd. by person(s) unknown reported by Tillman, et al.

A fir stump, 39 ins. diam., bears N. 75° W., 9.2 ft. dist., with a healed blaze.

and the bearing trees mkd. by Ezell

A fir, 16 ins. diam., bears N. 30° E., 25.4 ft. dist., with a healed blaze.

A fir, 11 ins. diam., bears S. 87 1/2° E., 23.6 ft. dist., with a healed blaze.

and the remains of a bearing tree mkd. by person(s) unknown

A fir stump, 48 ins. diam., bears N. 55 1/4° E., 21.1 ft. dist., with a healed blaze.

and new bearing trees

An alder, 12 ins. diam., bears S. 51 1/2° W., 23.9 ft. dist., mkd. T19S R9W S13 CC BT in the bark.

A fir, 13 ins. diam., bears N. 6 1/4° W., 21.7 ft. dist., mkd. T19S R9W S12 CC BT.

A steel fence post is alongside the cor.

From this cor., N. 89° 34' 22" W., 200 ft. dist., creek, 10 ft. wide, 270 ft. dist., creek, 10 ft. wide, course N. 40° E.

(C) The 1/4 sec. cor. of secs. 12 and 13, perpetuated by Rice, PLS No. 54633, in 2014, and is accepted as the cor., monumented with an iron rod, 2 1/2 ins. diam., firmly set, projecting 6 ins. above ground, with a brass cap projecting 4 ins. above ground, with an aluminum cap mkd.

1/4 | S 12 S 13 T 19 S | R 9 W 1958

from which the remains of the bearing trees mkd. by Tillman, et al. in 1957-58

A fir, 36 ins. diam., bears S. 10 1/2° W., 25.7 ft. dist., with a healed blaze.

A fir stump, 24 ins. diam., bears N. 64° W., 14.5 ft. dist., with a healed blaze.

and a bearing tree mkd. by Rice

A fir, 8 ins. diam., bears N. 13 1/4° W., 26.3 ft. dist. with scribe marks 1/4 S12 BT visible on a partially healed blaze.

An aluminum fence post is alongside the cor.

W 1/16 S 12 S 13 T 19 S | R 9 W 2013 54633LS

from which the bearing trees mkd. by Rice

A fir, 9 ins. diam., bears S. 54 3/4° W., 11.3 ft. dist., with scribe marks W176 S13 BT visible on a partially healed blaze.

A fir, 11 ins. diam., bears N. 51 1/4° W., 17.6 ft. dist., with scribe marks W176 S12 BT visible on a partially healed blaze.

At the corner point

Set a stainless steel post, 28 ins. long, 2 1/2 ins. diam., 20 ins. in the ground, directly over the iron rod, with a brass cap mkd.

An aluminum fence post is alongside the cor.

W 1/16 S 12 S 13 T 19 S | R 9 W 2015

from which the remains of bearing trees mkd. by Tillman, et al. in 1957-58

A fir stump, 25 ins. diam., bears N. 9° E., 32.3 ft. dist., with a healed blaze.

A fir stump, 47 ins. diam., bears S. 57° E., 127.4 ft. dist., with illegible scribe marks visible on an open blaze.

A fir stump, 32 ins. diam., bears S. 30° W., 7.9 ft. dist., with no marks visible.

and the remains of the bearing trees mkd. by Ward

A hemlock, 18 ins. diam., bears N. 18 3/4° E., 29.6 ft. dist., with illegible scribe marks visible on a partially healed blaze.

LEGEND: Corner previously established or reestablished (square symbol), Corner previously established or reestablished; remonumented this survey (square symbol)

I, Joseph M. Mannix, Cadastral Surveyor, HEREBY CERTIFY upon honor, that in pursuance of special instructions bearing the approval date of the 17th day of August, 2015, and the assignment instructions bearing the date of the 17th day of August, 2015, I have dependently resurveyed a portion of the subdivisional lines, Township 19 South, Range 9 West, Willamette Meridian, Oregon, which is represented upon this plat as having been executed by me and under my direction; and that said survey has been made in strict conformity with said special instructions, the Manual of Surveying Instructions, and in the specific manner described on this plat.

Signature of Joseph M. Mannix

Cadastral Surveyor

FEB 6 2017 Date

