

# County Surveyor's Record, Douglas County, Oregon

Subdivision of Section 33,  
T. 20 S., R. 9 W., Willamette Meridian, Oregon

18015

**CHAINS**

- 27.00 Top of ascent slopes N.; desc. over NW. slope.
- 29.65 Creek, 2 lks. wide, course N. 70° E.; asc. over SE. slope, changing to NE. slope.
- 42.16 The center S 1/16 sec. cor. of sec. 33.

Survey of Lot 7 in Section 33,  
T. 20 S., R. 9 W., Willamette Meridian, Oregon

**MEMORANDUM**

The survey of Lot 7 is based on the deed description from George H. Emerson Inc., to the United States of American, dated July 23, 1934.

From angle point No. 1, determined at a point 25 ft. S. of the center line of the existing Vincent Creek bridge and on the W. bank of the Smith River.

Set an iron post, 28 ins. long, 2½ ins. diam., 26 ins. in the ground, in a collar of stone, with brass cap mkd.

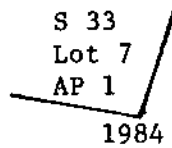

From this point, the NE 1/16 sec. cor. of sec. 33, bears N. 43° 07'; E., 12.44 chs. dist.

From this same point, a standard brass tablet bench mark of the Bureau of Public Roads, set in concrete curb, on Vincent Creek bridge, bears N. 25° 17' E., 0.455 chs. dist., with brass tablet mkd. 19 BM ELEV.

Thence N. 85° 45' W., along line 1-2, Lot 7, along S. edge of Vincent Creek Access Road, asphalt surface, 20 lks. wide, bears N. 85° W. and S. 85° E.

- 6.515 (430.0 ft.) Point for angle point No. 2, Lot 7.

Set an iron post, 28 ins. long, 2½ ins. diam., 24 ins. in the ground, with brass cap mkd.

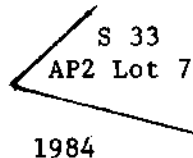

Thence N. 40° 30' E., along line 2-3, Lot 7.

- 0.60 Vincent Creek access Road, asphalt surface, 20 lks. wide, bears N. 85° W. and S. 85° E.

- 5.30 Road, asphalt surface, 10 lks. wide, bears N. 30° E. and S. 30° W.