

County Surveyor's Record, Douglas County, Oregon

17172

Survey of Parcel B in Sec. 29,
T. 20 S., R. 12 W., Willamette Meridian, Oregon

CHAINS

N. 44° 25' W., 3.16 chs. At 0.795 chs. dist., intersect the adjusted meanders of the west shore of Tahkenitch Lake.

N. 58° 02' W., 1.13 chs.

N. 86° 14' W., 1.51 chs.

S. 55° 43' W., 1.245 chs.

S. 34° 27' W., 3.175 chs. At end of course, intersect the 80 ft. easterly right-of-way of U.S. Highway No. 101, point for Angle Point No. 3 of Parcel B.

Set an aluminum post, 28 ins. long, 2 1/2 ins. diam., 24 ins. in the ground, with aluminum cap mkd.

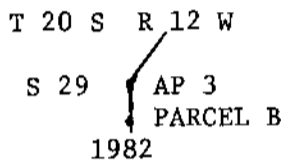

Set a steel fence post alongside aluminum post.

Thence southerly on line 3-4 of Parcel B, along the 80 ft. easterly right-of-way of U.S. Highway No. 101, on a 3° 47' circular curve to the right, an arc distance of 1.976 chs. (130.4 ft.), the long chord of which bears S. 1° 55' W., 1.975 chs. dist. (130.4 ft.), to point of curve, and point for Angle Point No. 4, of Parcel B.

Set an aluminum post, 28 ins. long, 2 1/2 ins. diam., 24 ins. in the ground, with aluminum cap mkd.

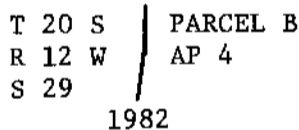

from which

A fir, 24 ins. diam., bears N. 38 3/4° E., 37 lks. dist., mkd. AP 4 PAR B BT.

A fir, 8 ins. diam., bears S. 88 1/4° W., 13 1/2 lks. dist., mkd. AP S29 BT.

Set a steel fence post alongside aluminum post.

Thence S. 4° 23' W., on line 4-5 of Parcel B, on a tangent, along the 80 ft. easterly right-of-way of U.S. Highway No. 101.

0.775

A point established by person(s) unknown and shown on plat of survey of Lot 5, sec. 29, Crown Willamette Paper Co., to G. M. and Ross R. Dean, December, 1937, monumented with an iron pipe, 1 in. diam., firmly set, flush with the ground.

2.085

Intersect the adjusted meanders of the west shore of Tahkenitch Lake.