

# County Surveyor's Record, Douglas County, Oregon

16609

Dependent Resurvey, Portion of Subdivisional Lines,  
T. 33 S., R. 5 W., Willamette Meridian, Oregon

16609

**CHAINS**

From this point, cor. No. 1 of St. Peters Quartz Lode, Mineral Survey No. 142, bears S. 20° 12' E., 3.405 chs. dist., hereinbefore described.

From this same point, cor. No. 2 of St. Peters Quartz Lode, Mineral Survey No. 142, on line 1-2 of Summit Quartz Lode, Mineral Survey No. 143, bears N. 20° 12' W., 5.655 chs. dist., monumented with a decayed fir post, 24 ins. long, 4 ins. sq., loosely set in a mound of stone, 4 ft. base, 1 ft. high, from which the remains of the original bearing trees:

A sawed fir stump, 38 ins. diam., bears N. 35° W., 16 1/2 lks. dist., with scribe marks BT visible on opened blaze.

A sawed fir stump, 43 ins. diam., bears S. 20° E., 13 lks. dist., with scribe marks SP visible on opened blaze. (Record, S. 70° E.)

At the corner point

Set an iron post, 28 ins. long, 2 1/2 ins. diam., 18 ins. in the ground, and in a mound of stone, 3 ft. base, to top, with brass cap mkd.

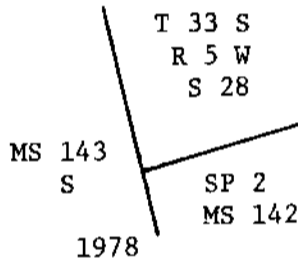

from which new bearing trees

A fir, 10 ins. diam., bears N. 57 1/2° E., 46 1/2 lks. dist., mkd. S28 BT.

A fir, 15 ins. diam., bears N. 87° E., 65 lks. dist., mkd. MS142 SP2 BT.

Deposit fir post alongside iron post.

Descend 35 ft. over SW. slope.

40.23

The 1/4 sec. cor. of secs. 28 and 33, monumented with an iron post, 2 1/2 ins. diam., firmly set, projecting 12 ins. above ground, in a mound of stone, 3 ft. base, to top with brass cap mkd.

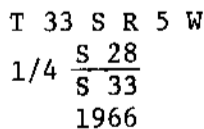

from which the remains of the original bearing trees

A white oak, 10 ins. diam., bears N. 43 3/4° E., 16 lks. dist., with healed blaze. (Record, N. 42 1/2° E., 15 lks.)

A sawed ponderosa pine stump, 55 ins. diam., bears S. 15 1/2° W., 177 lks. dist., with healed blaze.

and bearing trees mkd. by Gawron, Jelley, and Aanrud