

Retracement of Boundaries of Sec. 9, T. 26 S., R. 3 W.

CHAINS

38.23 Fall 140 lks. N of the $\frac{1}{4}$ sec. cor.

78.40 Fall 149 lks. N of the point for the cor. of secs. 9, 10, 15, and 16.

The bearing and length of the W half mile is N.87°25' W. 38.27 chs., and of the E half mile is N.89°23' W., 40.17 chs.

Thence

North, from the sec. cor., retracing bet. secs. 9 and 10.

35.41 Triangulation point on left bank of North Umpqua River.

Auxiliary flag bears N.59°21' W., 4.82 chs. dist.

From the auxiliary flag, the flag on random line projected across river, bears N.47°08' E.; all bearings checked by direct reading of the solar.

Dist. on random line - 35.41 chs.

Dist. by triangulation - 6.31 chs.

41.72 chs.

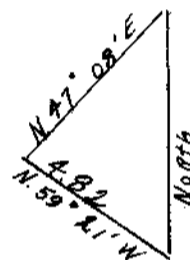

41.72 Flag on random line projected across river.

41.73 Fall 289 lks. E of the point for the $\frac{1}{4}$ sec. cor.

81.77 Fall 237 lks. E of the point for the cor. of secs. 3, 4, 9, and 10.

The bearing and length of the South half mile is N.3°58' W.,

41.83 chs., and of the north half mile is N.0°45' E.,

40.04 chs.

Thence

N.89°39' W., from the sec. cor., retracing bet. secs. 4 and 9.

39.68 After diligent search, find no evidence of the $\frac{1}{4}$ sec. cor.

78.13 Fall 68 lks. S of the point for the cor. of secs. 4, 5, 8 and 9.

The bearing and length of this mile is N.89°09' W., 78.13 chs., and proportional length of each half mile is 39.06 $\frac{1}{2}$ chs.