

Correction and Explanation of the survey of T 24 S R 7 W

CHAINS

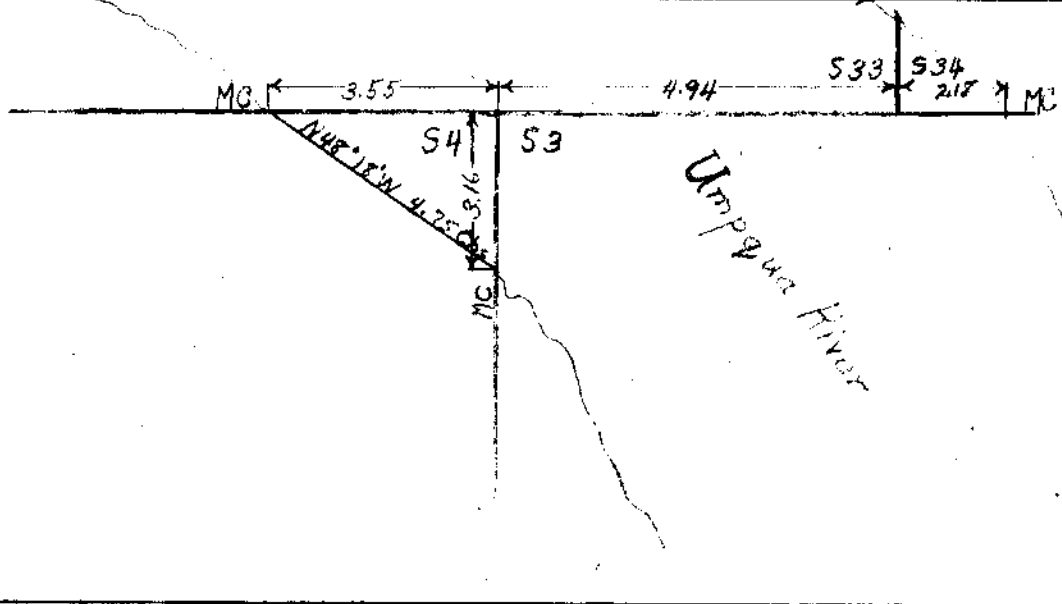

Lines bet. secs. 18 and 19, 7 and 18, and 6 and 7.

I obliterate marks on cors. established by Deputy Chandler referring to secs. for which closing cors. stand.

June 18, 1896.

Cor. to secs. 19, 30, 24 and 25, on West Bdy.

I can only account for the difference in description of bearing trees in this way.

I only ran to this cor. to verify my work and did not take description of B Ts. I got Mr. D. W.

Applegate to copy the notes for Surveyor General's office and in the absence of other notes, I think he must have taken description from notes furnished by Surveyor General and the error overlooked by myself.

Line bet. secs. 3 and 10.

I destroy C C to Secs. 3 and 10, and beginning at cor. to secs. 2, 3, 10 and 11,

I run

West on true line bet. secs. 3 and 10.

Va. 20*38'E.

Along N. slope of mountain

25.00 Foot of steep ascent.

37.00 Top of spur, 300 ft. high slopes N.

37.36 Set post, 4 ins. sq., 4 ft. long, 24 ins. in the ground