

~~Ret~~ Rec'd 9/20/21



United States Department of the Interior



BUREAU OF LAND MANAGEMENT
Oregon State Office
P.O. Box 2965, Portland, Oregon 97208
<http://www.blm.gov/or>

Kris DeGroot
Douglas County Surveyor
1036 SE Douglas Avenue
Room 105 Justice Building
Roseburg, OR 97470

Dear Mr. DeGroot:

This is to inform you that a cadastral survey crew under the direction of Ernest Q. Lundeen, Cadastral Surveyor, will be dependently resurveying a portion of the Seventh Standard Parallel South (north boundary), subdivisional lines and a portion of Mineral Survey No. 899 and subdividing section 29, T. 33 S., R. 4 W., Willamette Meridian, Oregon, as provided by Special Instructions for Group No. 3004, Oregon.

In order to properly execute this work, it may be necessary for our party chief to contact you for pertinent information. Any assistance you may be able to provide will be appreciated.

The Special Instructions Diagram is enclosed for your information. Please contact Ernest Lundeen at 541-618-2454 if you have any questions regarding this survey.

Sincerely,

MARY
HARTEL

Digitally signed by MARY
HARTEL
Date: 2021.08.09
11:44:21 -07'00'

Mary J.M. Hartel
Chief, Branch of Geographic Sciences

Enclosure (1)

CS 42/404

SPECIAL INSTRUCTIONS DIAGRAM
TOWNSHIP 33 SOUTH, RANGE 4 WEST, WILLAMETTE MERIDIAN
 GROUP No. 3004, OREGON
 SHEET 1 of 2

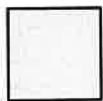
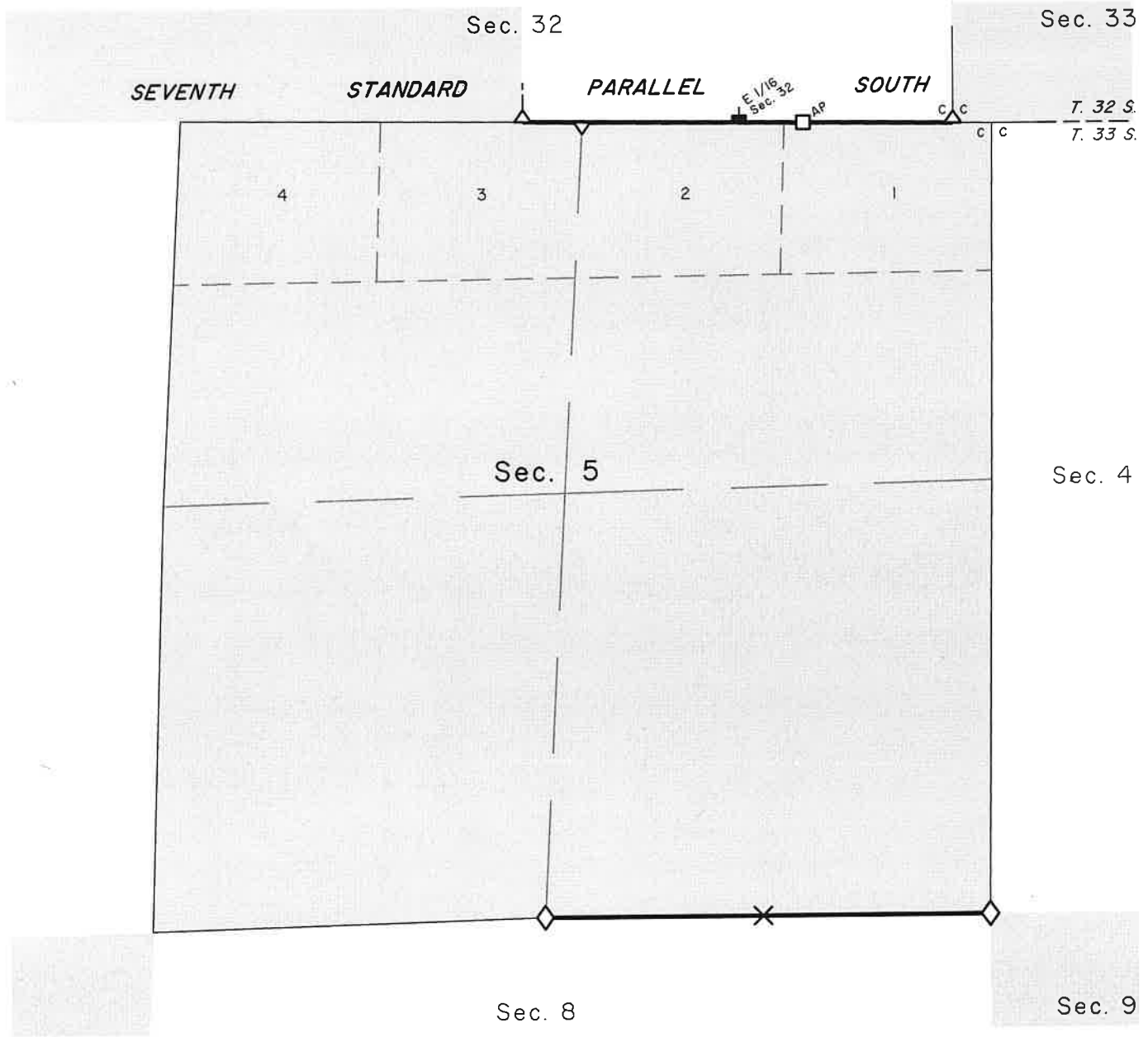

Federal interest lands

- ◊ Corner to be recovered or reestablished
- Corner previously established or reestablished
- Previously Established AP
- × Record Line tree

— Line to be resurveyed or surveyed

SPECIAL INSTRUCTIONS DIAGRAM

TOWNSHIP 33 SOUTH, RANGE 4 WEST, WILLAMETTE MERIDIAN

GROUP No. 3004, OREGON

SHEET 2 of 2

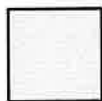
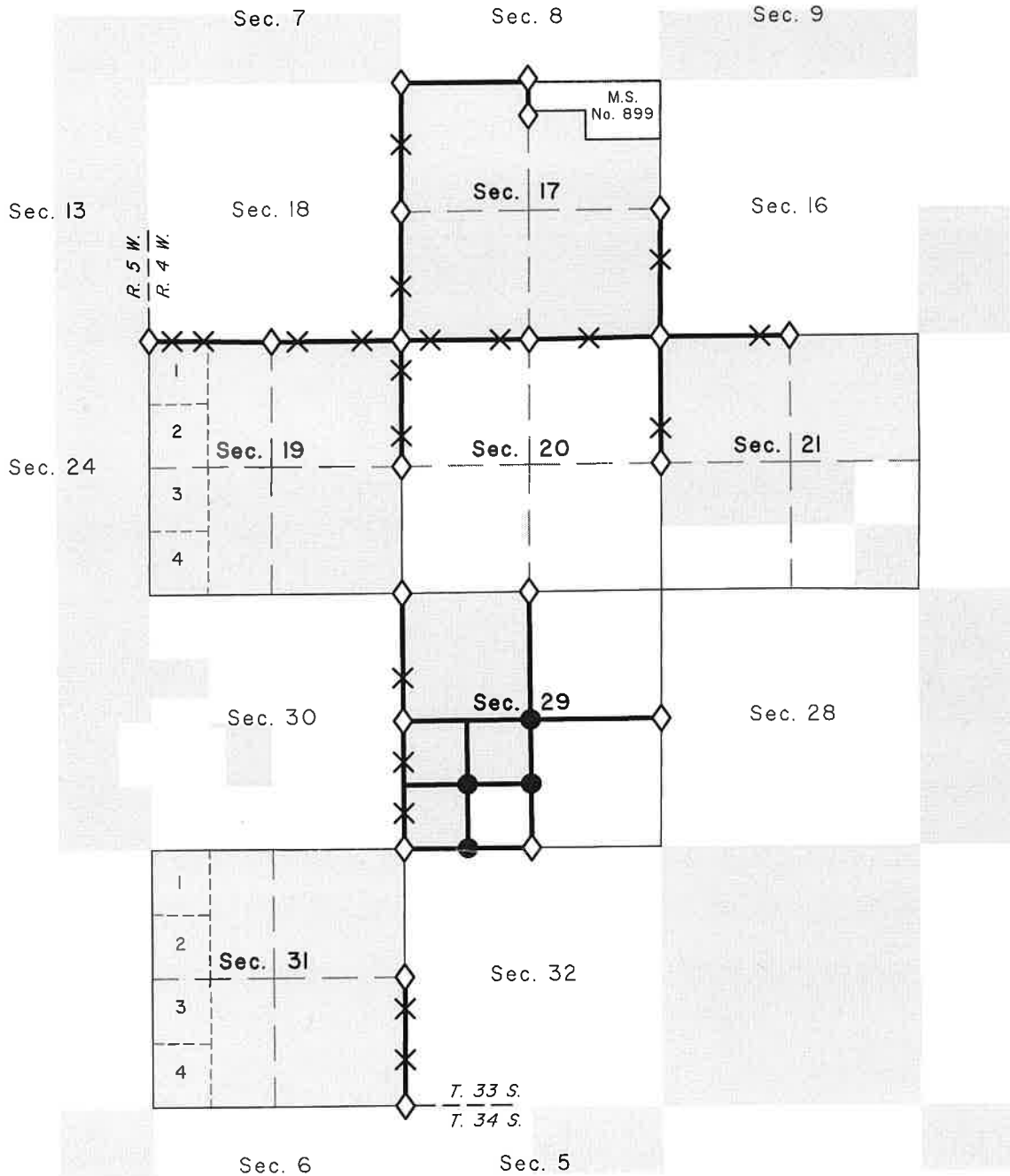

Federal interest lands

◇ Corner to be recovered or reestablished

● Corner to be established

× Record Line tree

— Line to be resurveyed or surveyed