

Rec'd 7-1-2024



United States Department of the Interior

BUREAU OF LAND MANAGEMENT
Oregon State Office
P.O. Box 2965, Portland, Oregon 97208
blm.gov/or



Ronald A. Quimby
Douglas County Surveyor
1036 SE Douglas Avenue
Roseburg, OR 97470

Dear Ronald A. Quimby:

This is to inform you that a cadastral survey crew under the direction of Kevin G. Mulder, Cadastral Surveyor, will be dependently resurveying a portion of the subdivisional lines, T. 30 S., R. 9 W., and dependently resurveying a portion of the subdivisional lines, T. 31 S., R. 9 W., Willamette Meridian, Oregon, as provided by Special Instructions for Group No. 3054, Oregon.

In order to properly execute this work, it may be necessary for our party chief to contact you for pertinent information. Any assistance you may be able to provide will be appreciated.

The Special Instructions Diagram is enclosed for your information. Please contact Kevin G. Mulder at 541-618-2230 if you have any questions regarding this survey.

Sincerely,

ROBERT
FEMLING

Digitally signed by
ROBERT FEMLING
Date: 2024.06.27
06:55:23 -07'00'

Robert W. Femling
Chief Cadastral Surveyor of Oregon

Enclosure (1)

INTERIOR REGION 9 • COLUMBIA-PACIFIC NORTHWEST
IDAHO, MONTANA, OREGON*, WASHINGTON
* PARTIAL

SPECIAL INSTRUCTIONS DIAGRAM

TOWNSHIPS 30 & 31 SOUTH, RANGE 9 WEST, WILLAMETTE MERIDIAN

GROUP No. 3054, OREGON

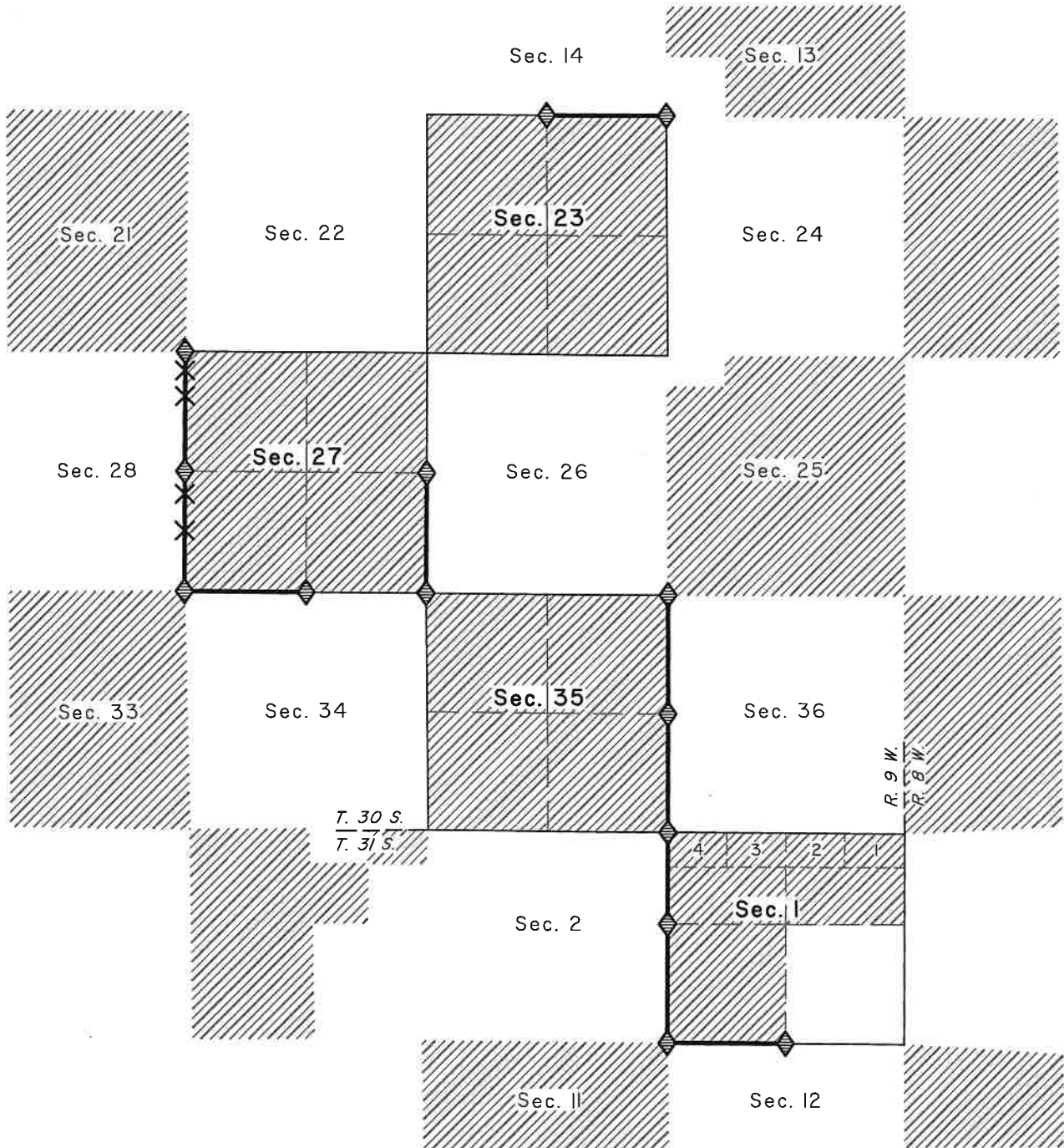

 Public Land Administered by BLM

 Corner to be recovered or reestablished

 Record line tree

 Line to be surveyed or resurveyed