

Rec'd 8/26/24



United States Department of the Interior



BUREAU OF LAND MANAGEMENT
Oregon State Office
1220 SW 3rd Ave., Portland, Oregon 97204
blm.gov/or

Ronald A. Quimby
Douglas County Surveyor
1036 SE Douglas Avenue
Roseburg, OR 97470

Dear Ronald A. Quimby:

This is to inform you that a cadastral survey crew under the direction of Kevin G. Mulder, Cadastral Surveyor, will be dependently resurveying a portion of the subdivisional lines, T. 30 S., R. 8 W., Willamette Meridian, Oregon, as provided by Special Instructions for Group No. 3046, Oregon.

In order to properly execute this work, it may be necessary for our party chief to contact you for pertinent information. Any assistance you may be able to provide will be appreciated.

The Special Instructions Diagram is enclosed for your information. Please contact Kevin G. Mulder at 541-618-2230 if you have any questions regarding this survey.

Sincerely,

ROBERT
FEMLING

Digitally signed by
ROBERT FEMLING
Date: 2024.08.20
14:47:05 -07'00'

Robert W. Femling
Chief Cadastral Surveyor of Oregon

Enclosure (1)



SPECIAL INSTRUCTIONS DIAGRAM

TOWNSHIP 30 SOUTH, RANGE 8 WEST, WILLAMETTE MERIDIAN

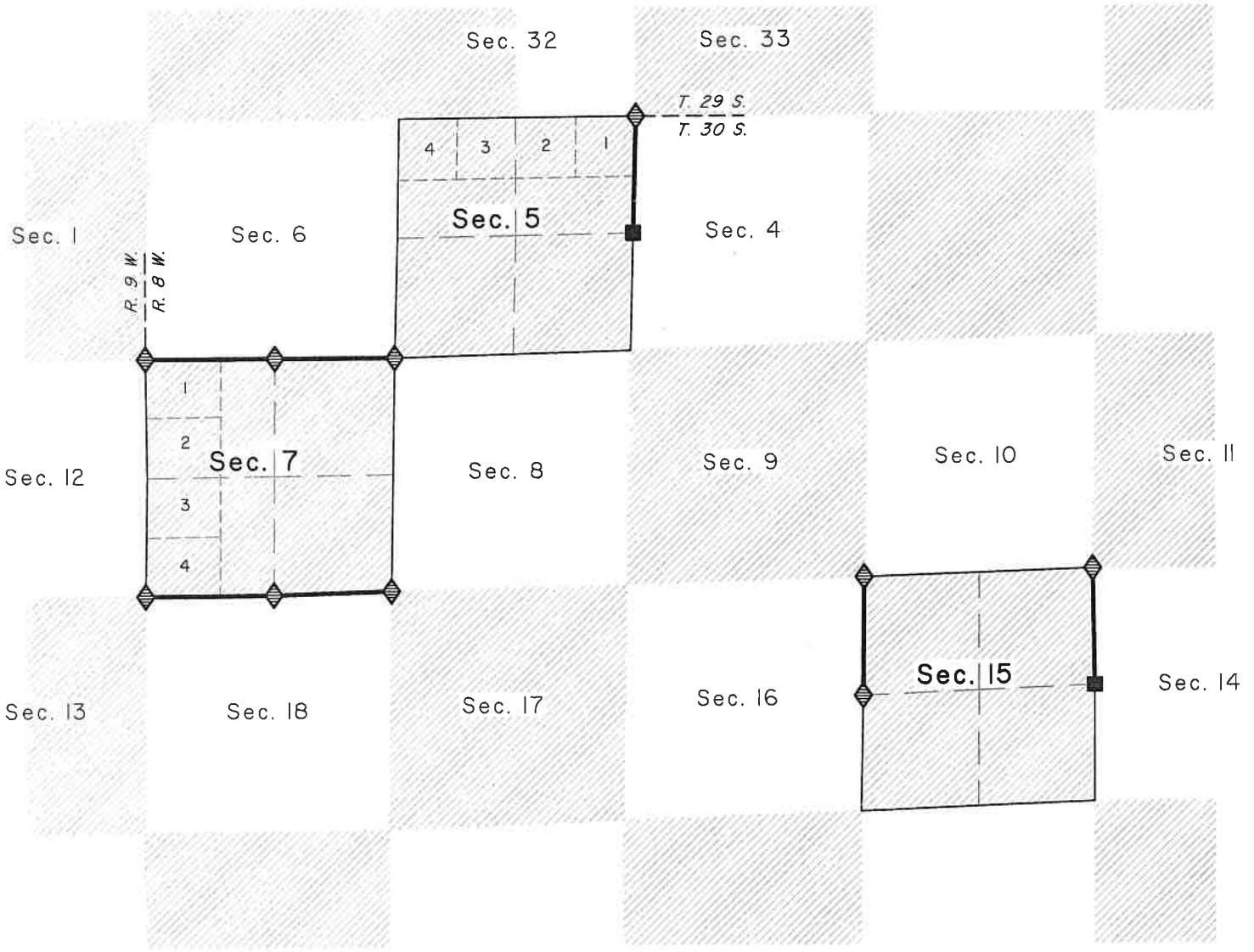
GROUP No. 3046 OREGON



 Public Land Administered by BLM

 Corner to be recovered or reestablished
 Corner previously established or reestablished
 Line to be surveyed or resurveyed