

PRIMARY CORNER DESCRIPTION Sec. Cor. for 2, 3, 10 and 11

Alias _____ Description _____
Alias _____ Description _____
Alias _____ Description _____
Alias _____ Description _____

GLO survey by Fred Mensch, Deputy Surveyor, under Contract #782, dated Dec. 1, 1908 - (DCSO records Vol. 16 Page(s) 6840)

A Fir 36" dia., for cor. of secs. 2, 3, 10 and 11, I mark T30S S2 on NE.; R2W S11 on SE.; S10 on SW.; and S3 on NW. side, with 5 notches on S. and 2 notches on E. side, from which

- A Fir 20" dia., bears N.70°E., 32 lks. mkd. T30S R2W S2 BT
- A Fir 4" dia., bears S.48°E., 36 lks. mkd. T30S R2W S11 BT
- A Fir 24" dia., bears S.47°W., 35 lks mkd. T30S R2W S10 BT
- A Fir 24" dia., bears N.27°W., 25 lks. mkd. T30S R2W S3 BT

Douglas Co. Surveyors Office - James Byron, Deputy - W. Penley; J. Heritage - Aug. 9, 1971 - C.S. File 54/73-76

Found - Original corner tree shows good scars.
Orig. SE. BT now stump, shows good scribing.
Orig. SW. BT now stump, shows scars.
Orig. NW. and NE. BTs, now dead, show scars.
All BTs check for bearings and distances.

Set Brass cap 3.0 ft. East of center of corner tree. Mark
brass cap County Surveyors Office

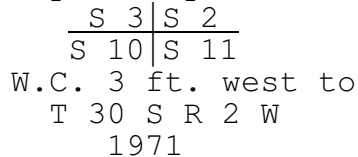

- New BTs- 8" W.Fir bears S.42°W., 36.7 ft. scribed S10 T30S R2W W.C. CS BT.
- 18" W.Fir bears S.57°W., 39.5 ft. scribed W.C. S11 T30S R2W CS BT.
- 15" W.Fir bears N.44°E., 63.6 ft. scribed W.C. S2 T30S R2W.
- 10" W.Fir bears N.70°W., 27.0 ft. scribed W.C. T30S R2W CS BT. Scribe high above log.

BLM Dependent Resurvey by Kenneth W. Saveland, Cadastral Surveyor, under Group No. 2232, Surveyed Oct. 2008/April 2009 - (DCSO records Vol. 57 Page(s) 22651-2)

The cor. of secs. 2, 3, 10, & 11, perpetuated by Byron, in 1971, monumented with the remains of the orig. cor. tree, a debarked, sawed fir stump, 36" dia. 5 ft high, with 5 notches on S. face, 2 notches on E. face, and fragmentary scribe marks visible on decayed and open SW. blaze, with a metal cap, from which the remains of the orig. BTs
continued next page

TOWNSHIP 30 RANGE 02 POINT IDENTIFIER # 500600

PRIMARY CORNER DESCRIPTION Sec. Cor. for 2, 3, 10 and 11

Alias _____ Description _____
Alias _____ Description _____
Alias _____ Description _____
Alias _____ Description _____

A sawed, decayed fir stump, 23" dia., bears N.70°E., 21.1 ft., with scribe marks 30S R2W 2 BT visible on an open blaze.

A sawed, decayed fir stump, 32" dia., bears S.47°W., 23.1 ft., with no marks visible.

A fir snag, 29" dia., bears N.27°W., 16.5 ft., with scribe marks R2 S3 visible on an open, decayed blaze.

At the corner point

Sawed the stump of the orig. cor. tree to ground level and drove an aluminum rod, 36" long, 3/4" dia., 34" into stump, with an aluminum cap mkd.

T30S R2W
S 3 | S 2
S 10 | S 11
2009

from which

A fir, 6" dia., bears S.75½°E., 20.4 ft., mkd. T30S R2W S11 BT.

A fir, 12" dia., bears N.34¼°W., 27.1 ft., mkd. T30S R2W S3 BT.

Deposit magnet in a white plastic case under the aluminum cap and alongside the aluminum rod.

From this cor., a witness cor. to the cor. of secs. 2, 3, 10, and 11, established by Byron, in 1971, bears East, 3.00 ft., monumented with an iron post, 1¼" dia. firmly set, projecting 12" above ground, with brass cap (properly) mkd.

from which bearing trees mkd. by Byron

A sawed, decayed fir stump, size indeterminate, bears N.44½°E., 63.2 ft., with no marks visible.

A fir, 18" dia., bears S.43¼°W., 36.1 ft., with scribe mark 3 and other illegible scribe marks visible on a partially healed blaze.

A decayed fir snag, 13" dia., bears N.70½°W., 26.5 ft., with fragmentary scribe marks visible on a partially healed blaze.

Corner is located on a N. slope.