

TOWNSHIP 28 RANGE 05 POINT IDENTIFIER # 339700

PRIMARY CORNER DESCRIPTION South 1/4 Cor. for 33, T27-5

Alias _____ Description _____
Alias _____ Description _____
Alias _____ Description _____
Alias _____ Description _____

Original - Elder & Gile, Contract #31 dated April, 1853

Set ¼ Sec. post, C. C. from which
A Y.Oak, 10" dia. bears N.37°W., 152 lks. dist.
A Y.Oak, 16" dia. bears N.15¼°E., 274 lks. dist.

James W. Byron Crew - Nov. 1961 - C.S. 49/64-46

Found - Orig. 10" now 12" B.O., N.37°W., 133.3 ft., not
130.3 ft., shows good scribing on old face, "S"
Orig. 16" now 36" B.O., N.15¼°E., 180.8 ft. shows
old scar. I do not open.

Set - Brass cap at cor. mkd. County Surveyors Office, 1961
C. C. ¼ S33 T27S R5W

New BTs - Rescribe orig., now 36" B.Oak, N.15¼°E., 180.8 ft.
mkd. S ¼ S33 CS BT.

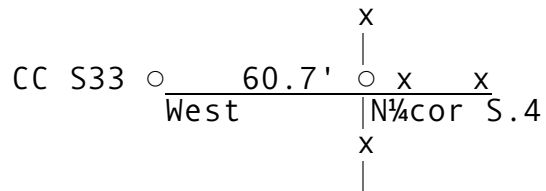

Found OK, May 21, 1984 R. Thompson, M 96 - 58

Carl Sweeden - For: VIPS Industries INC - April 2004 - M144-56

Found - 2½" BC, up 0.8'
39" B.Oak BT, N.15.5°E., 180.8, scar & tag.
New BTs- 13" B.Oak, N.17°W., 93.17' scribed "S ¼ S33 BT" tag.
7" I.Cedar, N.28°W., 70.45' scribed "S ¼ S33 BT" tag

Fd. OK by Kris DeGroot, 6/2009 - 2009-0034A&B