

Rec'd 9/3/2024



# United States Department of the Interior



BUREAU OF LAND MANAGEMENT  
Oregon State Office  
1220 SW 3<sup>rd</sup> Ave., Portland, Oregon 97204  
blm.gov/or

Ronald A. Quimby  
Douglas County Surveyor  
1036 SE Douglas Avenue  
Roseburg, OR 97470

Dear Ronald A. Quimby:

This is to inform you that a cadastral survey crew under the direction of Kevin G. Mulder, Cadastral Surveyor, will be dependently resurveying portions of the north boundary, subdivisional lines, and subdivision of section lines of section 1, and subdividing section 15, T. 27 S., R. 3 W., Willamette Meridian, Oregon, as provided by Special Instructions for Group No. 3065, Oregon.

In order to properly execute this work, it may be necessary for our party chief to contact you for pertinent information. Any assistance you may be able to provide will be appreciated.

The Special Instructions Diagram is enclosed for your information. Please contact Kevin G. Mulder at 541-618-2230 if you have any questions regarding this survey.

Sincerely,

ROBERT  
FEMLING

Digitally signed by  
ROBERT FEMLING  
Date: 2024.08.27  
15:36:07 -07'00'

Robert W. Femling  
Chief Cadastral Surveyor of Oregon

Enclosure (1)

INTERIOR REGION 9 • COLUMBIA-PACIFIC NORTHWEST  
IDAHO, MONTANA, OREGON\*, WASHINGTON  
\* PARTIAL

CS 42/404

# SPECIAL INSTRUCTIONS DIAGRAM

## TOWNSHIP 27 SOUTH, RANGE 3 WEST, WILLAMETTE MERIDIAN

GROUP No. 3065, OREGON

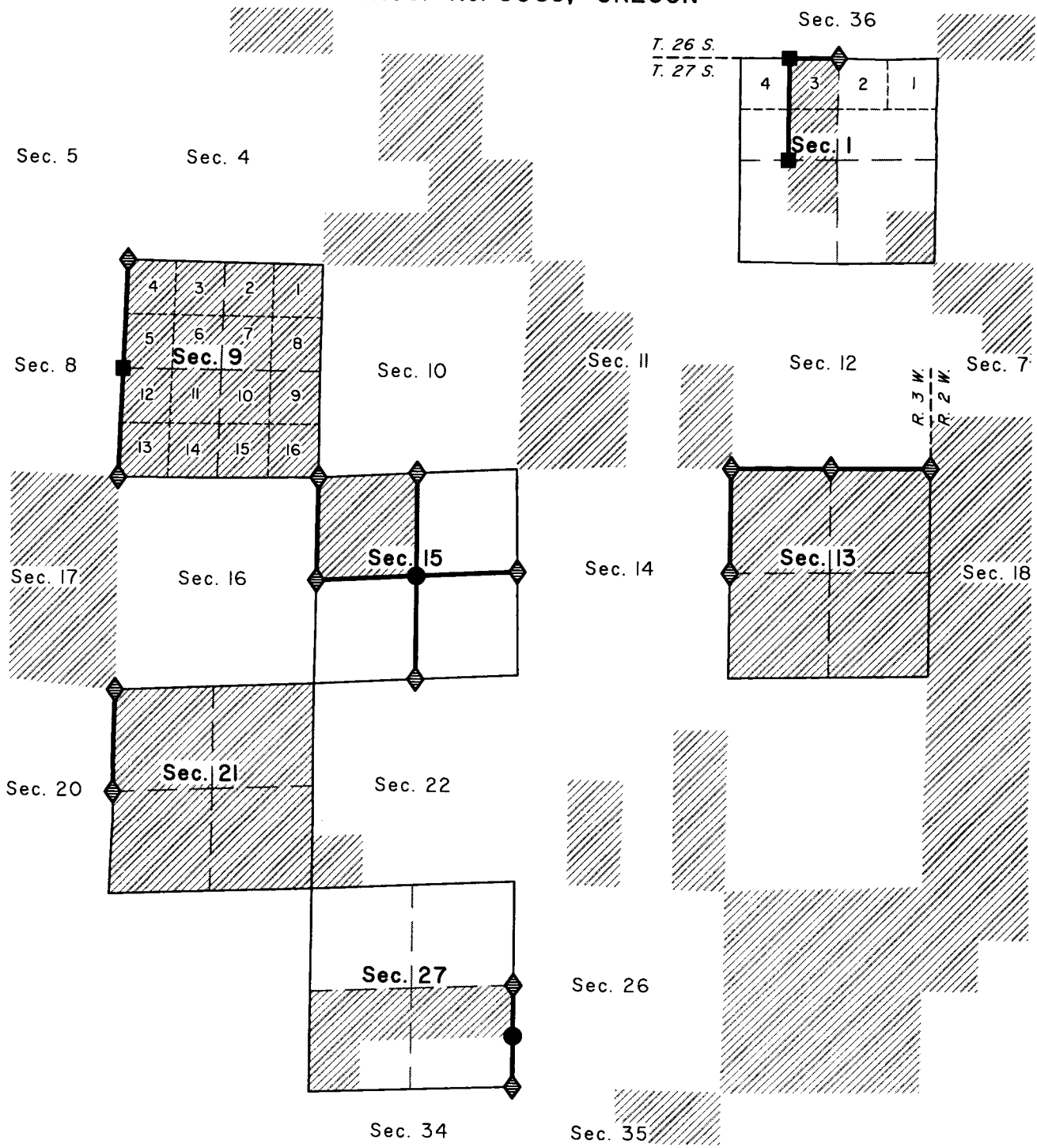

Public Land Administered by BLM

- Corner to be recovered or reestablished
- Corner previously established or reestablished
- Corner to be established

Line to be surveyed or resurveyed

CS 42/A04