

Rec'd 10/24/24



United States Department of the Interior

BUREAU OF LAND MANAGEMENT
Oregon State Office
P.O. Box 2965, Portland, Oregon 97208
blm.gov/or



Ronald A. Quimby
Douglas County Surveyor
1036 SE Douglas Avenue
Roseburg, OR 97470

Dear Ronald A. Quimby:

This is to inform you that a cadastral survey crew under the direction of Kevin G. Mulder, Cadastral Surveyor, will be dependently resurveying portions of the west boundary, subdivisional lines, and subdivision of section lines of sections 6 and 30, T. 27 S., R. 2 W., Willamette Meridian, Oregon, as provided by Special Instructions for Group No. 3068, Oregon.

In order to properly execute this work, it may be necessary for our party chief to contact you for pertinent information. Any assistance you may be able to provide will be appreciated.

The Special Instructions Diagram is enclosed for your information. Please contact Kevin G. Mulder at 541-618-2230 if you have any questions regarding this survey.

Sincerely,

**ROBERT
FEMLING**

Digitally signed by
ROBERT FEMLING
Date: 2024.10.16
08:43:59 -07'00'

Robert W. Femling
Chief Cadastral Surveyor of Oregon

Enclosure (1)

INTERIOR REGION 9 • COLUMBIA-PACIFIC NORTHWEST
IDAHO, MONTANA, OREGON*, WASHINGTON
* PARTIAL



CS 42/404

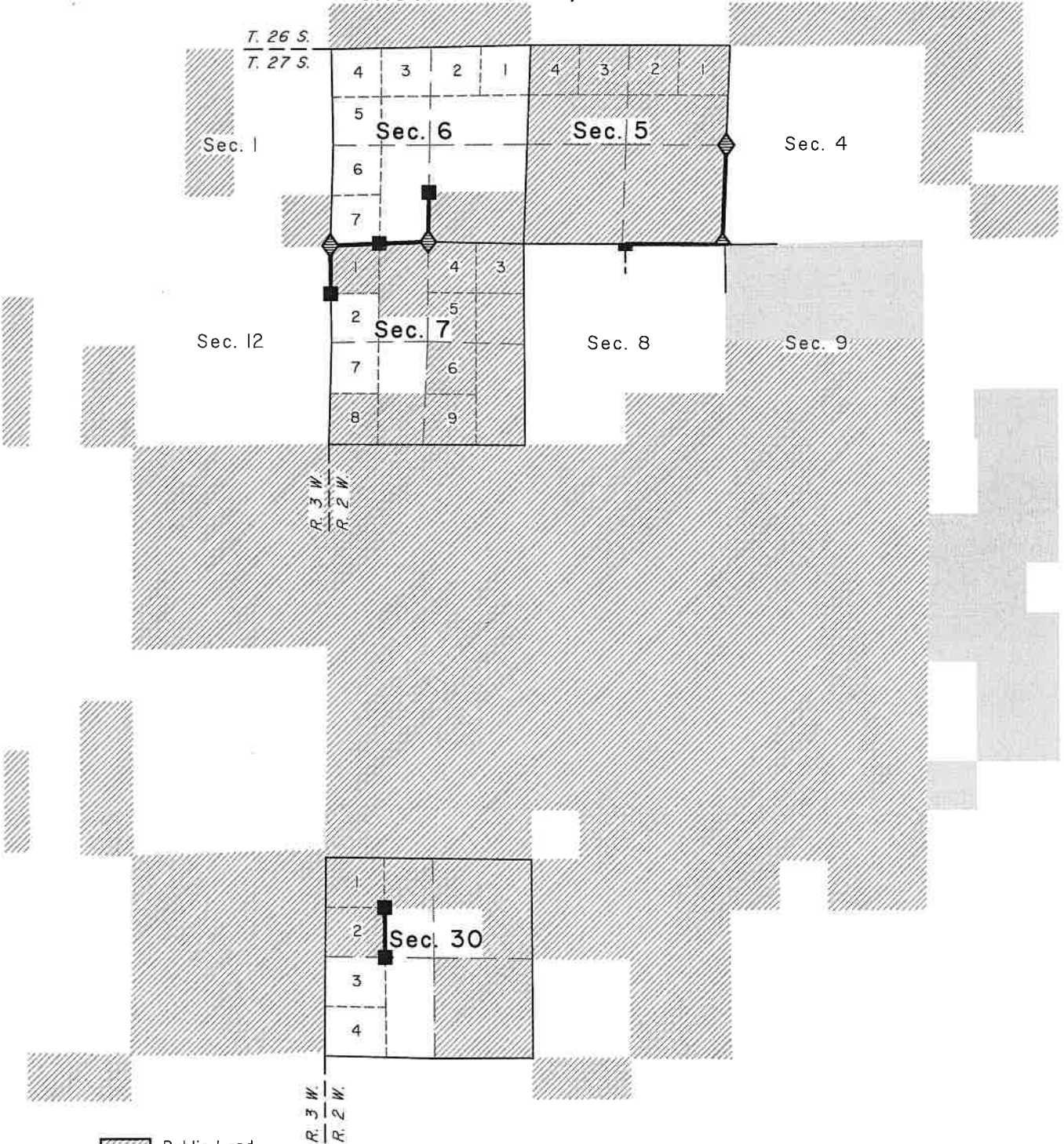

SPECIAL INSTRUCTIONS DIAGRAM

TOWNSHIP 27 SOUTH, RANGE 2 WEST, WILLAMETTE MERIDIAN

GROUP No. 3068, OREGON



 Public Land Administered by BLM
 Public Land Administered by USFS

 Corner to be recovered or reestablished
 Line to be surveyed or resurveyed