

T 26 S R09 W

1" = 2000'

- BLM RESURVEYS ----- |||||
- CORNERS RENEWED OR ESTABLISHED ----- ●
- CORNERS FOUND AND USED ----- ◻
- CORNERS LOOKED FOR AND NOT FOUND ----- ○
- COUNTY BOUNDARY -----
- CORNER RENEWED - LAST REPORT NOT FD ----- *

COOS
COUNTY

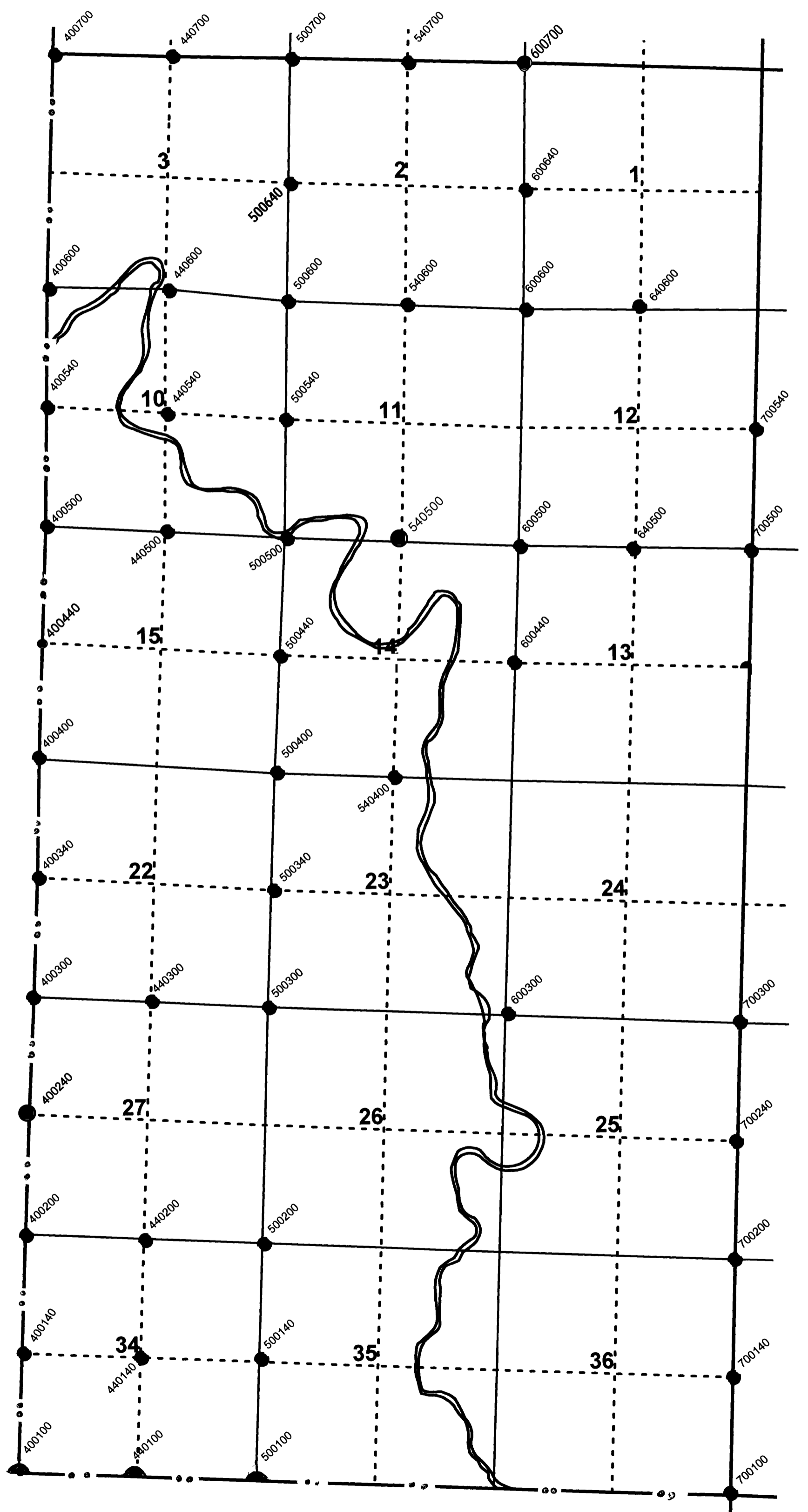

COOS COUNTY