

TOWNSHIP 26 RANGE 02 POINT IDENTIFIER # 700209

PRIMARY CORNER DESCRIPTION C C for Secs. 30 & 31, T26-1

Alias \_\_\_\_\_ Description \_\_\_\_\_  
Alias \_\_\_\_\_ Description \_\_\_\_\_  
Alias \_\_\_\_\_ Description \_\_\_\_\_  
Alias \_\_\_\_\_ Description \_\_\_\_\_

GLO survey by Fred Mensch, Deputy Surveyor, under Contract #797, dated April 19, 1910 - (DCSO records Vol. 10 Page(s) 4151)

-----  
(At intersection point, 10.45 chs. N.1°20'W. of the cor. of secs. 25 & 36, T26S R2W)  
Set a basalt stone 15x8x6 ins., 10" in the ground for closing cor. of secs. 30 and 31, marked CC on E. with 5 grooves on N. and 1 groove on S. face, from which  
A Fir 6" dia., bears N.52°E., 20 lks. dist. mkd. T26S R1W S30 BT.  
A Hemlock 8" dia., bears S.27°E., 23 lks. dist. mkd. T26S R1W S31 BT.

GLO Survey by Fred Mensch, U.S. Surveyor Under Special Instructions dated May 25, 1916 - (DCSO records Vol. 10 Page(s) 4172)

-----  
(72.63 chs.)  
Intersect the old closing cor. of secs. 30 & 31, which I now destroy and obliterate marks on old bearing trees.  
  
(72.99 chs., N.89°24'W.)  
At the point of intersection (10.54 chs. N.0°22'E. from the cor. of secs. 25 & 36) Set a basalt stone, 15x8x6 ins., 10" in the ground, for closing cor. of secs. 30 & 31, marked CC on E., with 5 grooves on N. and 1 groove on S. face, from which  
A Maple 14" dia., bears N.25°E., 4 lks. dist. mkd. CC T26S R1W S30 BT.  
A Hemlock 12" dia., bears S.70°E., 26 lks. dist. mkd. CC T26S R1W S31 BT.

Douglas County Surveyors Office - Vernon "Ray" Tracy and crew Aug. 1967 - C.S. File 54/40-47

-----  
Found - No trace of corner stone or NE. BT.  
Orig. 8" now 16" Hemlock, S.27°E., 15.2 ft., alive, open and find scribing.  
Set Brass cap at cor. mkd: County Surveyors Office  
T26S CC | S30 R1W  
R2W | S31  
1967  
New BTs- 44" D.Fir N.40°E. 32.0 ft. mkd. T26S R1W S30 CC CSBT  
14" Hemlock S.32°E., 34.7 ft. mkd. T26S R1W S31 CC CS BT.  
Corner lies on N. side of dry creek bottom, course W.

PRIMARY CORNER DESCRIPTION C C for Secs. 30 & 31, T26-1

Alias \_\_\_\_\_ Description \_\_\_\_\_  
 Alias \_\_\_\_\_ Description \_\_\_\_\_  
 Alias \_\_\_\_\_ Description \_\_\_\_\_  
 Alias \_\_\_\_\_ Description \_\_\_\_\_

Douglas Co. Surveyors Office - Randall Smith and Stephen  
 Flause, crew - July 22, 1997 - C.S. File 64/75-30

Found - 2½" dia. brass cap on a 1½" O.D. Iron pipe,  
 protrudes 12" above ground. (1967)

(Note: 1967 DCSO BC/IP set in error. 1967 DCSO used a 1916  
 resurvey BT and a brg. & dist. from 1910.)

Found - No corner stone found.

(Brgs. & dist. taken from 1967 DCSO BC/IP.)

Found - 44" now 49" dia. D.Fir with a fully healed single  
 blaze, bears N.38°E., 29.4 ft. (Rec. N.40°E.,  
 32.0 ft. (1967)

14" now 15" dia. Hemlock with a partially healed  
 single blaze, scribing visible "26S R1W S31 CS  
 BT", bears S.34°E., 34.7 ft. (Rec. S.32°E., 34.7  
 ft.) (1967)

12" now 17" dia. Hemlock with a previously opened  
 unhealed blaze, scribing visible "BT" facing  
 N.70°W., bears S.30½°E., 15.2 ft. (Rec. from  
 1967, S.27°E., 15.2 ft.) Note: This is a BT  
 marked in 1916 Mensch resurvey)

NOT A BT, 8" now 10" dia. Hemlock with a previously  
 opened chopped out blaze, bears S.49¼°E., 30.9  
 ft. (1910 BT, scribing axed out in 1916)

Brass cap from 1967 renewal is sawed off. I.P. now protrudes  
 8" above ground. At point determined from 1916 resurvey BT,  
 A 17" dia. Hemlock (S.70°E., 17.2 ft.), WE SET a 2½" dia.  
 brass cap on a 1 3/8" O.D. x 32" long Iron pipe. BC/IP  
 protrudes 10" above ground. BC/IP is surrounded by a mound  
 of stone. Cap marked: Douglas County Surveyors

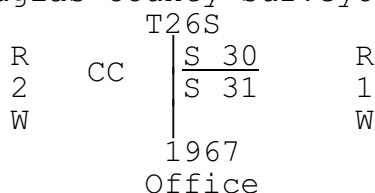

New Accessories:

1967 1½" O.D. Iron pipe bears N.49¼°E.,, 10.7 ft.

1967 13" Hemlock bears S.51½°E., 35.1 ft.

1967 49" D.Fir bears N.41°E., 39.9 ft.

Corner is at the bottom of a steep gully that courses West.

Corner is in an old growth forest.