

TOWNSHIP 24 RANGE 2 POINT IDENTIFIER # 440160

PRIMARY CORNER DESCRIPTION C N 1/16 S 34

Alias _____	Description _____
Alias _____	Description _____
Alias _____	Description _____
Alias _____	Description _____

David Edwards - For: Seneca Jones Timber Co.- 5/30/2008 - M156-7

Set - 6 ft. steel post
5/8" x 30" steel rebar with 2 1/2" alum. cap stamped "LS 2339"
9" diameter Fir, bears N.37°E. 8.25 ft.
10" diameter Cedar, bears N.79°W. 4.75 ft.

Douglas Co. Surveyor's Office - Crew: Stephen J. Flaese and Jeff Lorsung - 1/5/2026 - C.S. File 67/61-57

Found - 2 1/2" alum. cap on 5/8" iron rod proj. 3".

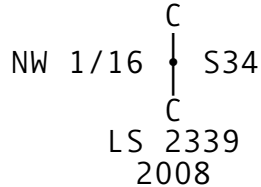

Burnt-dead 14" cedar N.65°W. 4.75 ft. (Rec N.79°W. to BT tag) partly healed single blaze. Add 3 1/2" mag nail right side center.

Burned, fallen out of position 12" hemlock. Root hole obliterated. Partly healed single blaze.

New - 5/8" x 30" iron rod with D.C.S.O. plastic yellow cap proj. 3" North 11.0 ft.

Notes - Area burnt 9/2020.
Mon. On moderate South slope 6 ft.± N.45°W. from seasonal stream. Large clearcut to North all burned

Compass decl. 14 1/4°E.
OGRS COORDINATE SYSTEM
COTTAGE GROVE-CANYONVILLE ZONE
N. 43.44568055°
W. 122.92222413°