

Rec'd 5-8-15



United States Department of the Interior

BUREAU OF LAND MANAGEMENT
Oregon State Office
P.O. Box 2965, Portland, Oregon 97208
<http://www.blm.gov/or>



1/2020
8/2020
4/2023

MAY - 5 2015

Sec 25
not included
in recent
map filed

Kris DeGroot
Douglas County Surveyor
Douglas County Courthouse Room 105a
Roseburg, Oregon 97470

Dear Mr. DeGroot:

This is to inform you that a cadastral survey crew under the direction of Edith Forkner, Cadastral Surveyor, will be dependently resurveying a portion of the subdivisional lines and subdivision of section lines of section 25, and subdividing section 23, T. 23 S., R. 8 W., Willamette Meridian, Oregon, as provided by Special Instructions for Group No. 2781, Oregon.

In order to properly execute this work, it may be necessary for our party chief to contact you for pertinent information. Any assistance you may be able to provide will be appreciated.

The Special Instructions Diagram is enclosed for your information. Please contact Edith Forkner, Cadastral Surveyor at 541-751-4437 or Ken Saveland at 541-751-4241 if you have any questions regarding this survey.

Sincerely,

Mary J.M. Hartel
Per Mary J.M. Hartel
Chief, Branch of Geographic Sciences

Enclosure

CS @ 421 404

Rec'd
5/1/2015

SPECIAL INSTRUCTIONS DIAGRAM

TOWNSHIP 23 SOUTH, RANGE 8 WEST, WILLAMETTE MERIDIAN

GROUP No. 2781, OREGON

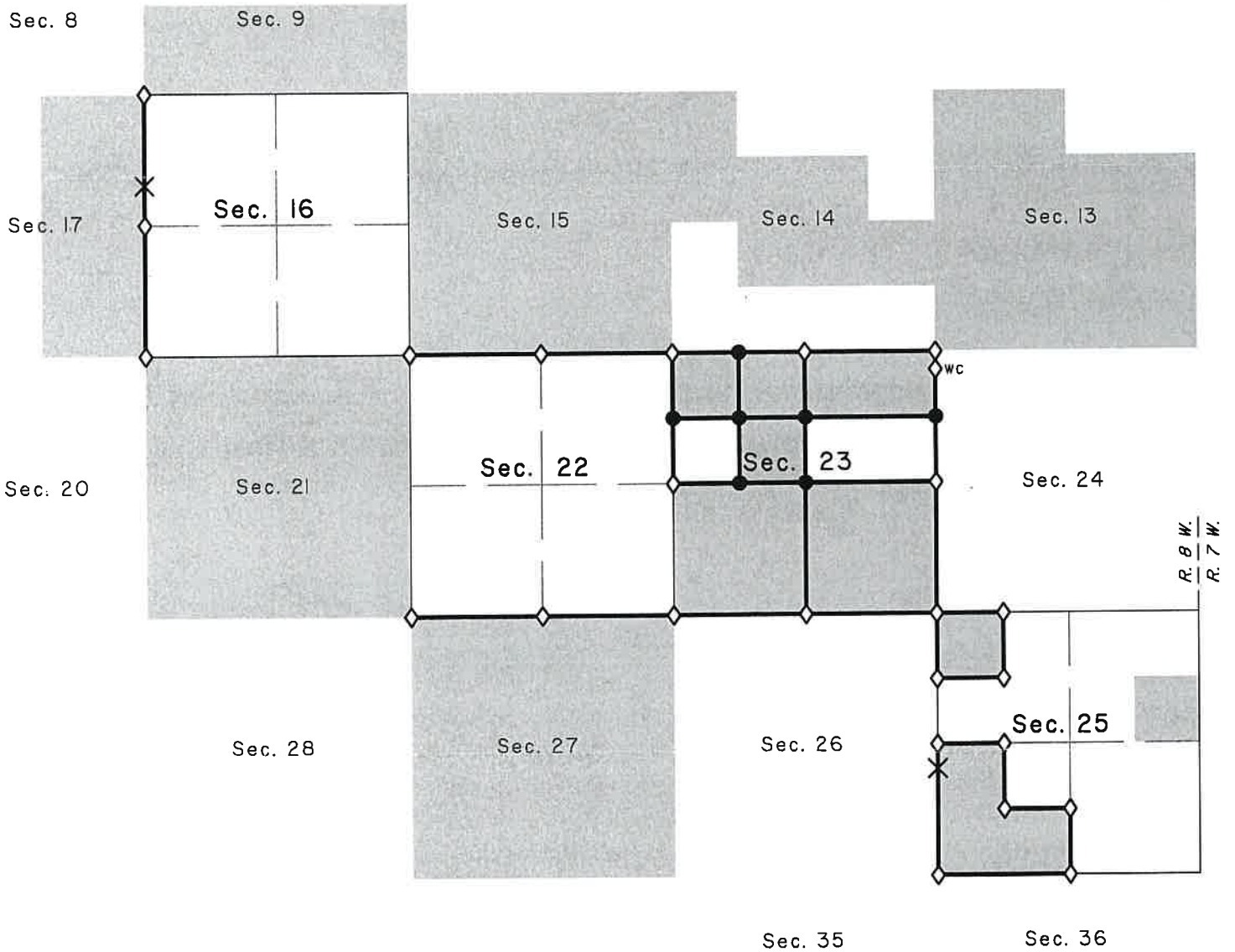

Public Land Administered by BLM

◇ Corner to be recovered or reestablished

● Corner to be established

X Record line tree

— Line to be surveyed or resurveyed