

Reid march 2026



United States Department of the Interior



BUREAU OF LAND MANAGEMENT
Oregon State Office
1220 S.W. 3rd Ave., Portland, Oregon 97204
blm.gov/or

Ronald A. Quimby
Douglas County Surveyor
1036 SE Douglas Avenue
Roseburg, OR 97470

Dear Ronald A. Quimby:

This is to inform you that a cadastral survey crew under the direction of Tevin M. Cruz, Cadastral Surveyor, will be dependently resurveying a portion of the subdivisional lines and subdividing section 21, T. 20 S., R. 9 W., and dependently resurveying a portion of the subdivisional lines and subdividing section 24, T. 20 S., R. 10 W., Willamette Meridian, Oregon, as provided by Special Instructions for Group No. 3087, Oregon.

In order to properly execute this work, it may be necessary for our party chief to contact you for pertinent information. Any assistance you may be able to provide will be appreciated.

The Special Instructions Diagram is enclosed for your information. Please contact Tevin M. Cruz at 971-710-9288 or Markell Hamm at 541-416-6889 if you have any questions regarding this survey.

Sincerely,

ROBERT
FEMLING

Digitally signed by
ROBERT FEMLING
Date: 2026.03.26
08:11:11 -07'00'

Robert W. Femling
Chief Cadastral Surveyor of Oregon

Enclosure (1)

INTERIOR REGION 9 • COLUMBIA-PACIFIC NORTHWEST
IDAHO, MONTANA, OREGON*, WASHINGTON
* PARTIAL

CS 42/404

SPECIAL INSTRUCTIONS DIAGRAM

TOWNSHIP 20 SOUTH, RANGES 9 & 10 WEST, WILLAMETTE MERIDIAN

GROUP No. 3087, OREGON

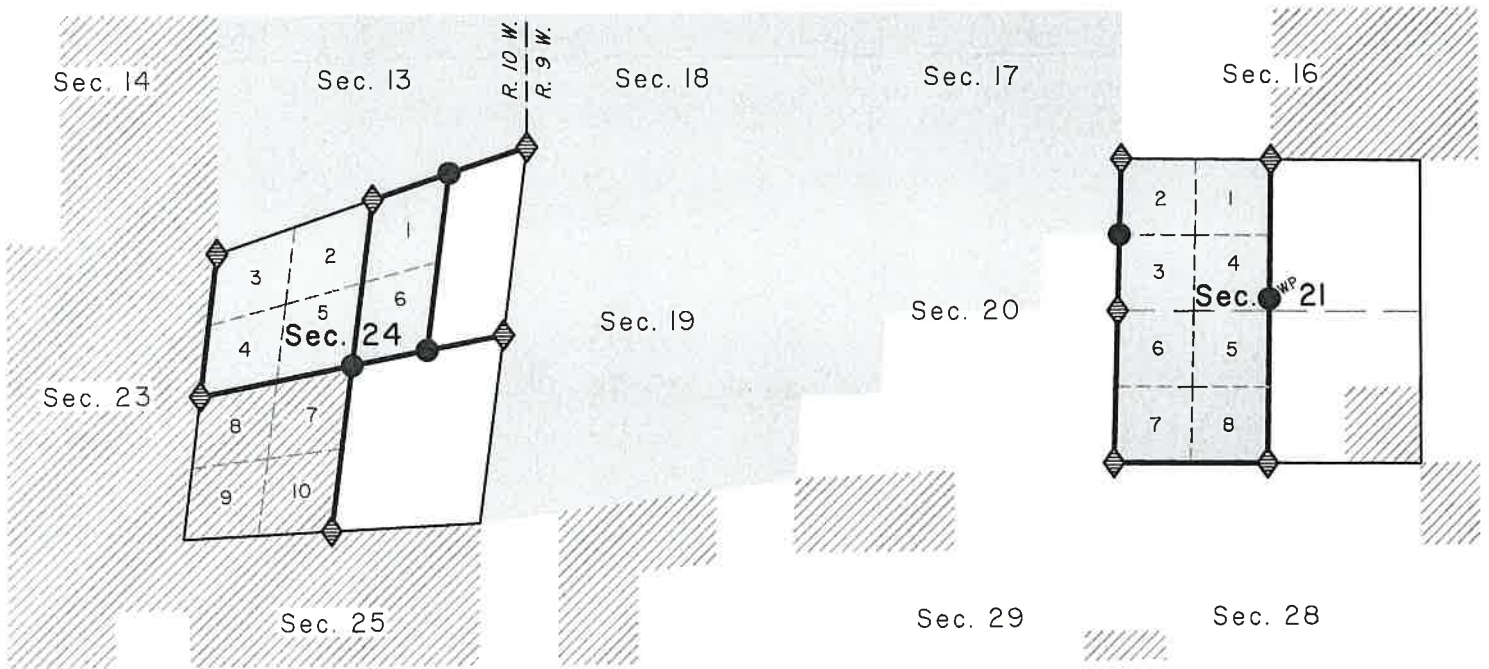

 Public Land Administered by BLM

 Federal Interest Land Administered by BIA

 Corner to be recovered or reestablished

 Corner to be established

 Line to be resurveyed or surveyed