

THIS MAP WAS PREPARED FOR ASSESSMENT PURPOSE ONLY.

T.32S. R.1W. W.M. DOUGLAS COUNTY

REVISED ON 10-28-10

32 1 00 & INDEX

1" = 2000'

SEE MAP 32 1 00

SEE MAP 32 2 00

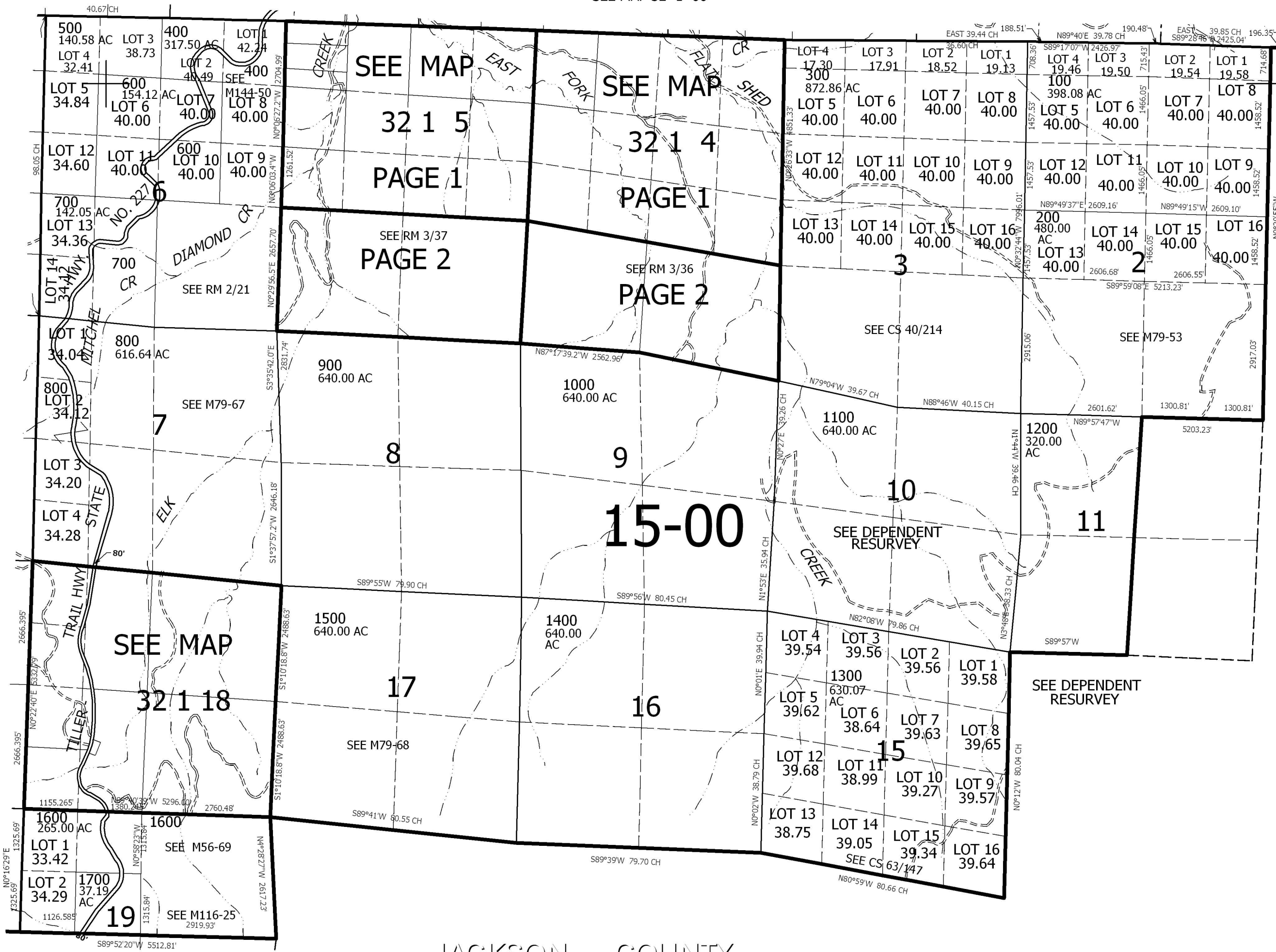

CANCELLED NO'S 400M1

JACKSON COUNTY

JACKSON COUNTY

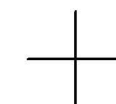
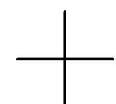

406,000

4,311,000

32 1 00 & INDEX