

THIS MAP WAS PREPARED FOR ASSESSMENT PURPOSE ONLY.

SEC.19 T.27S. R.5W. W.M.
DOUGLAS COUNTY
1" = 400'

REVISED ON
5-19-22

27 5 19
& INDEX
ROSEBURG

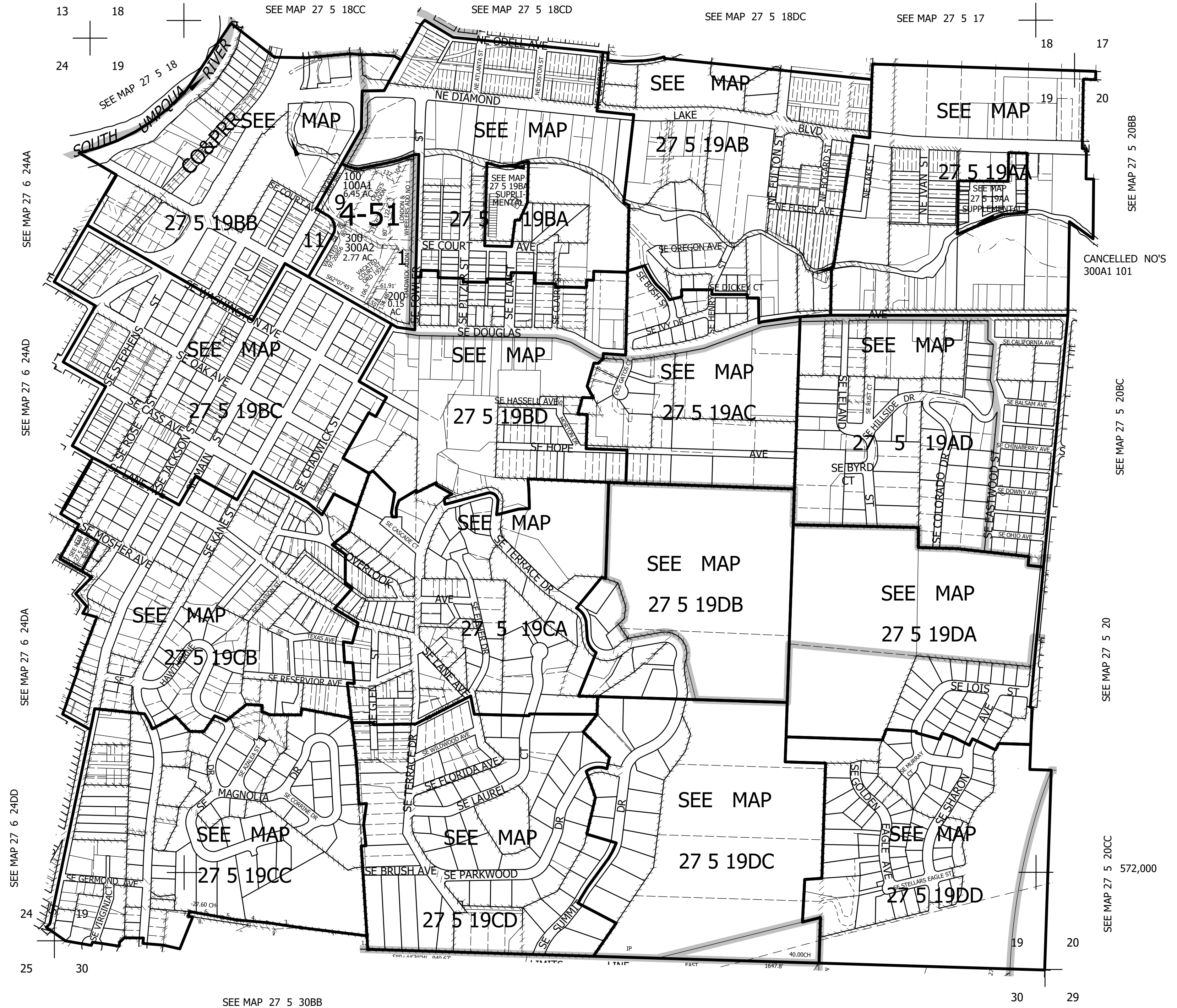

4,168,000
27 5 19
& INDEX
ROSEBURG