

SEC.21 T.25S. R.4W. W.M.
DOUGLAS COUNTY

1" = 400'

REVISED ON

25 4 21

THIS MAP WAS PREPARED FOR
ASSESSMENT PURPOSE ONLY.

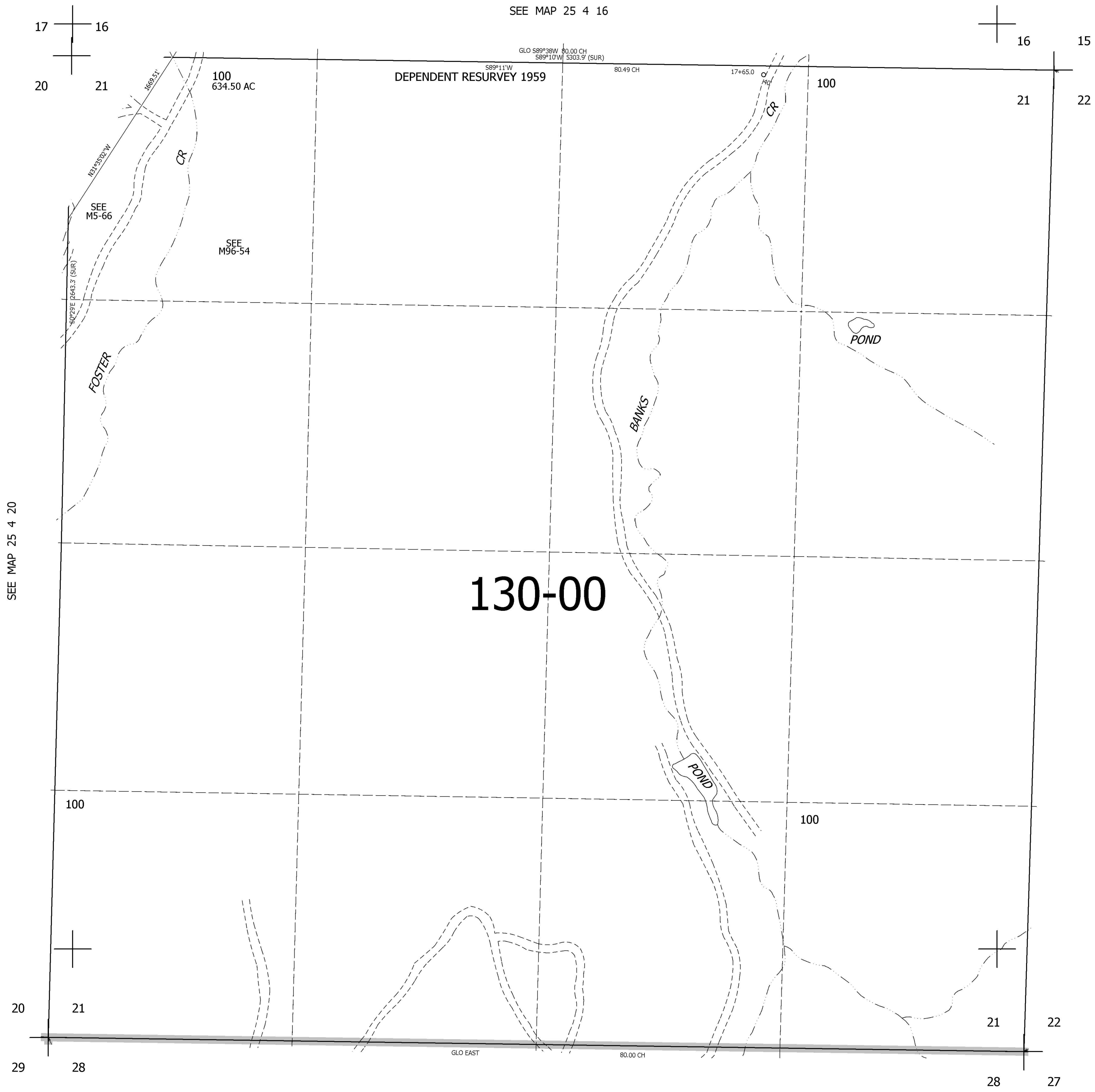

SEE MAP 25 4 16

SEE MAP 25 4 20

SEE MAP 25 4 22

130-00

100
634.50 AC

DEPENDENT RESURVEY 1959

100

FOSTER

BANKS

POND

POND

100

100

634,000

SEE MAP 25 4 28

4,212,000

25 4 21

CANCELLED NOS