

THIS MAP WAS PREPARED FOR ASSESSMENT PURPOSE ONLY.

T.25S. R.4W. W.M. DOUGLAS COUNTY

REVISED ON

25 4 00 & INDEX

SEE MAP 24 4 00 1" = 2000'

CANCELLED NOS 100M1 500M1

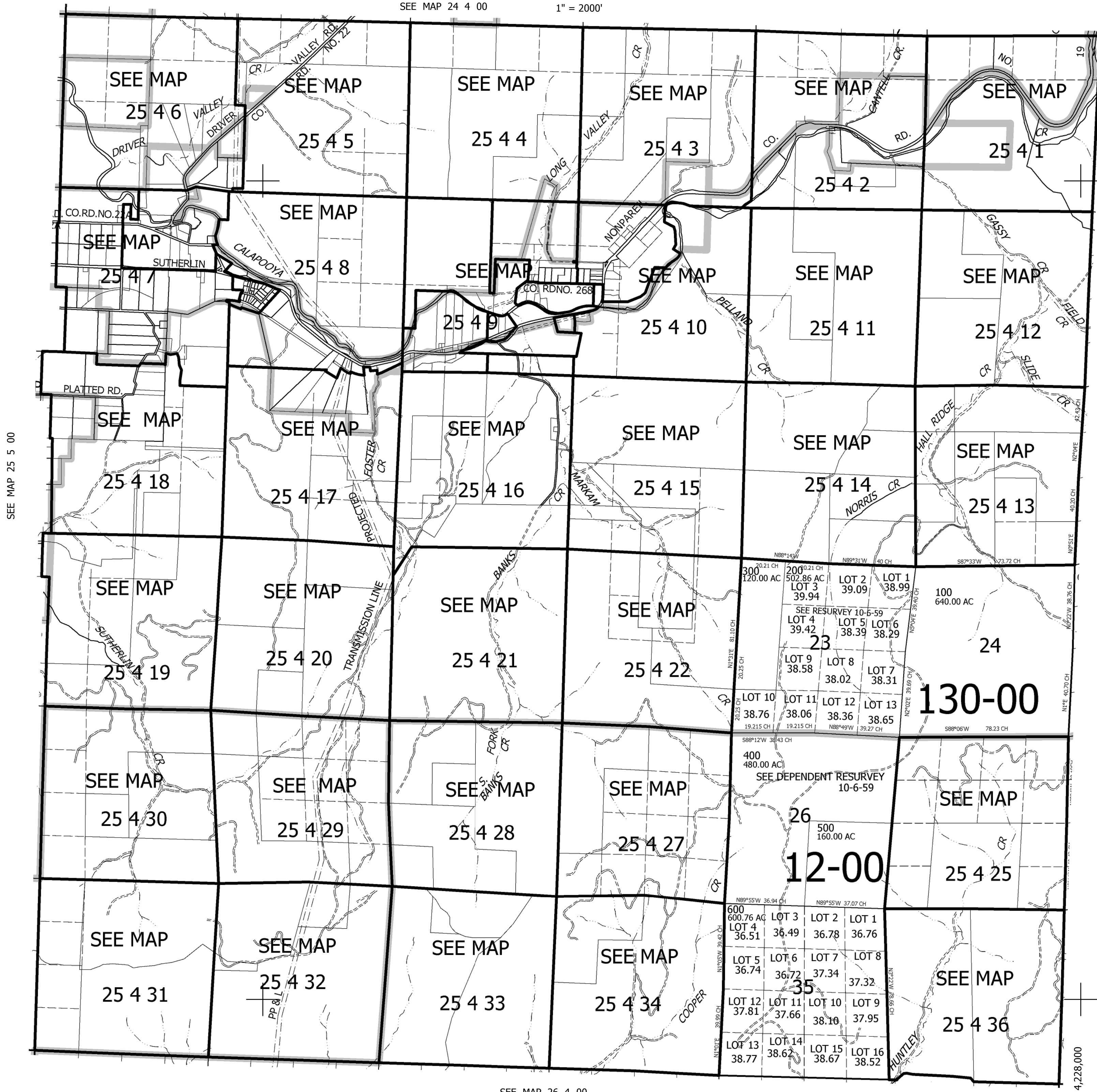

SEE MAP 25 5 00

SEE MAP 25 3 00

625,000

SEE MAP 26 4 00

25 4 00 & INDEX

4,228,000