

THIS MAP WAS PREPARED FOR ASSESSMENT PURPOSE ONLY.

Upper Left:
124°11'30"W 43°41'5"N
3945092E 757020N ft

SEC.07 T.22S. R.12W. W.M.
DOUGLAS COUNTY
1" = 400'

Date Exported 2025-11-26

CANCELLED NOS:
102 101

- TAXLOT 100
1. N89°30'22"E 94.86'
 2. S32°17'07"E 51.6'
 3. S25°41'16"E 122.53'
 4. S70°19'23"E 70.11'
 5. S45°09'10"E 37.52'
 6. S65°34'13"E 44.36'
 7. N87°12'53"E 49.61'
 8. N67°19'08"E 136.04'
 9. N83°01'18"E 100.37'
 10. N84°42'07"E 69.54'
 11. S88°53'40"E 85.16'
 12. N61°57'47"E 280.08'
 13. S85°21'54"E 50.94'
 14. N0°22'28"E 31.2'
 15. N89°22'28"E 259.13'

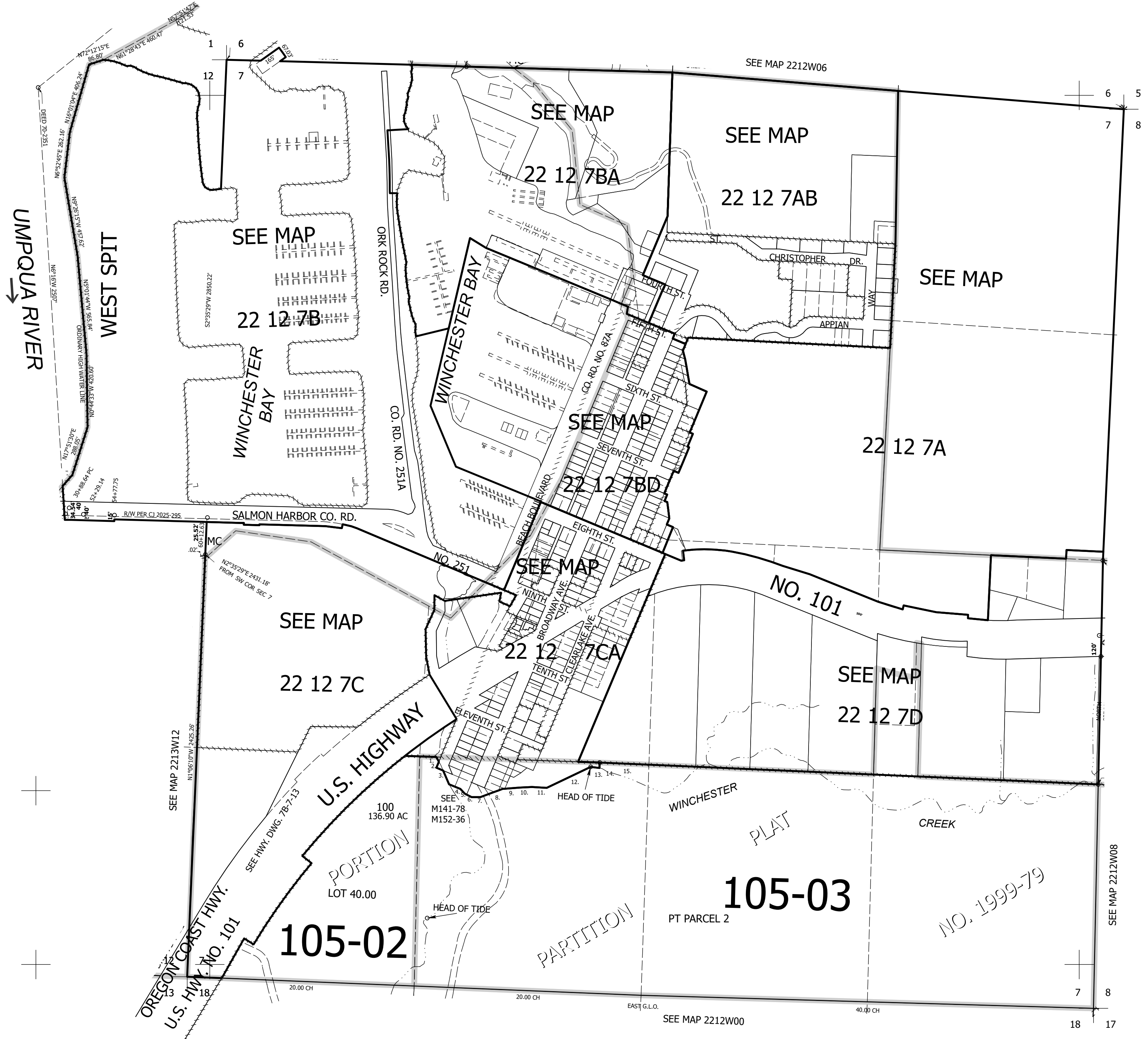

Lower Right:
124°9'39"W 43°40'N
3952942E 750065N ft