

THIS MAP WAS PREPARED FOR ASSESSMENT PURPOSE ONLY.

SEC.26 T21S. R.11W. W.M.  
DOUGLAS COUNTY

21 11 26

REVISED ON  
5-23-05

1" = 400'

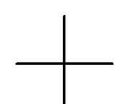

CANCELLED NO'S  
200

SEE MAP 21 11 00

SEE M 84-51

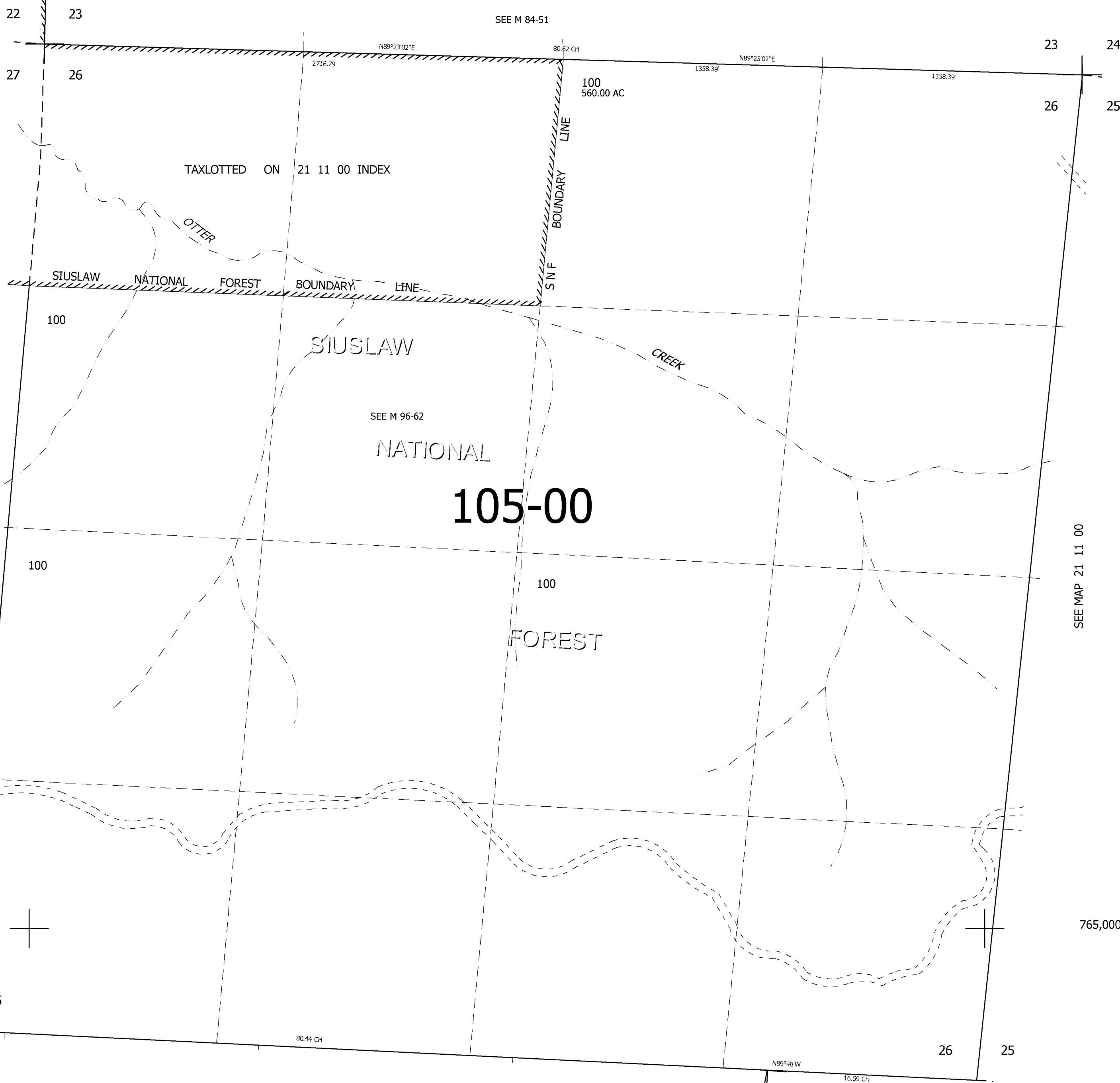

SEE MAP 21 11 27

SEE MAP 21 11 00

34 35  
GLO S89°44'W  
16.95 CH

SEE MAP 21 11 35

35 36

4,005,000

21 11 26