

This map was prepared for assessment purpose only.

SECTION 10 T.30S. R. 6 W. W.M.
DOUGLAS COUNTY

30 6 10

1" = 400'

SEE MAP 30 6 3

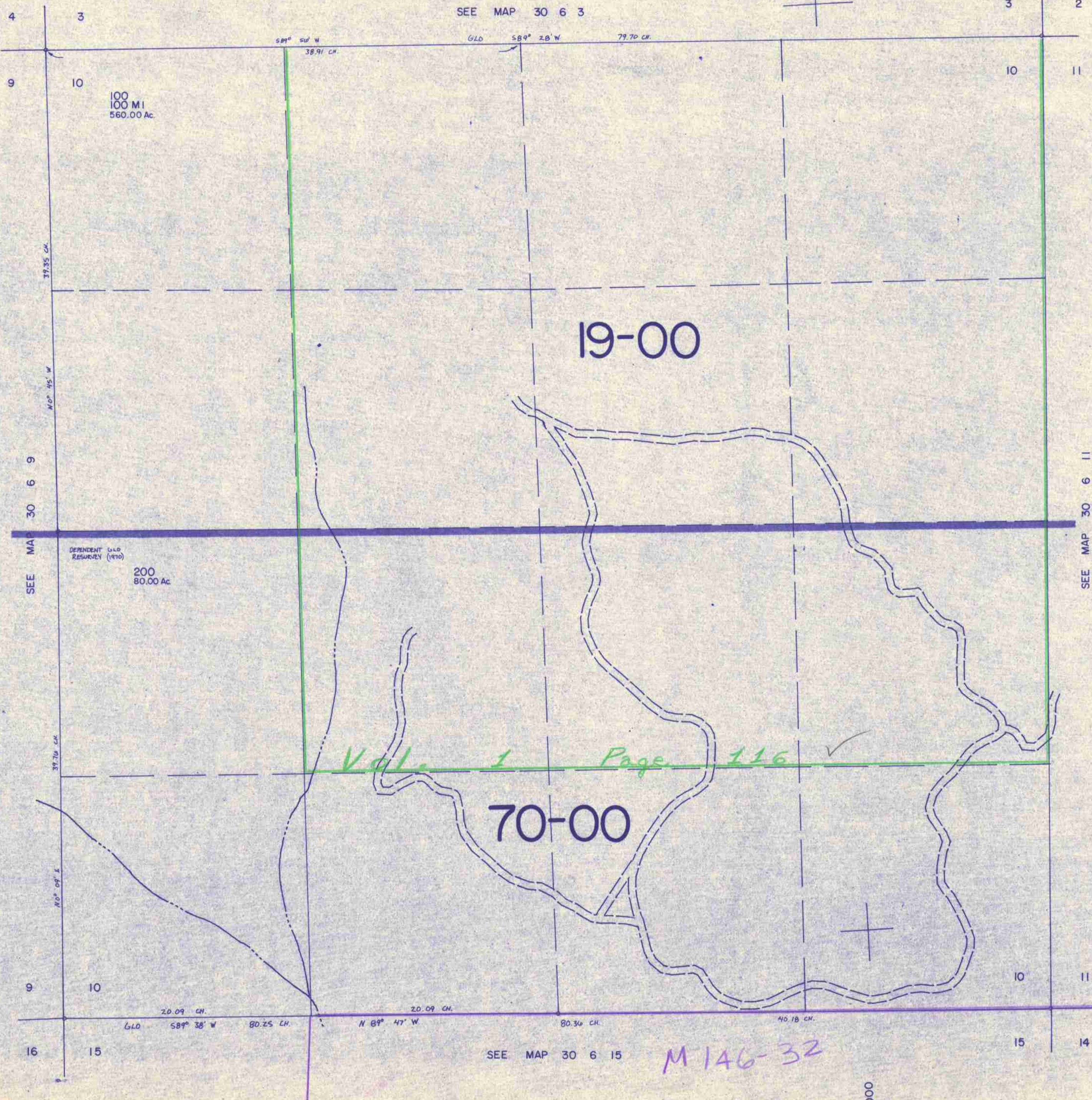

100
100 MI
560.00 Ac.

19-00

DEPENDENT G.L.O.
RESURVEY (1930)
200
80.00 Ac.

V. 1 Page 116

70-00

489,000

SEE MAP 30 6 15

M 146-32

1,227,000

30 6 10

12/03 BS