

THIS MAP WAS PREPARED FOR ASSESSMENT PURPOSE ONLY.

SEC.3 T.28S. R.6W. W.M. DOUGLAS COUNTY

REVISED ON 8-16-05

28 6 3 & INDEX

1" = 400'

SEE MAP 27 6 34

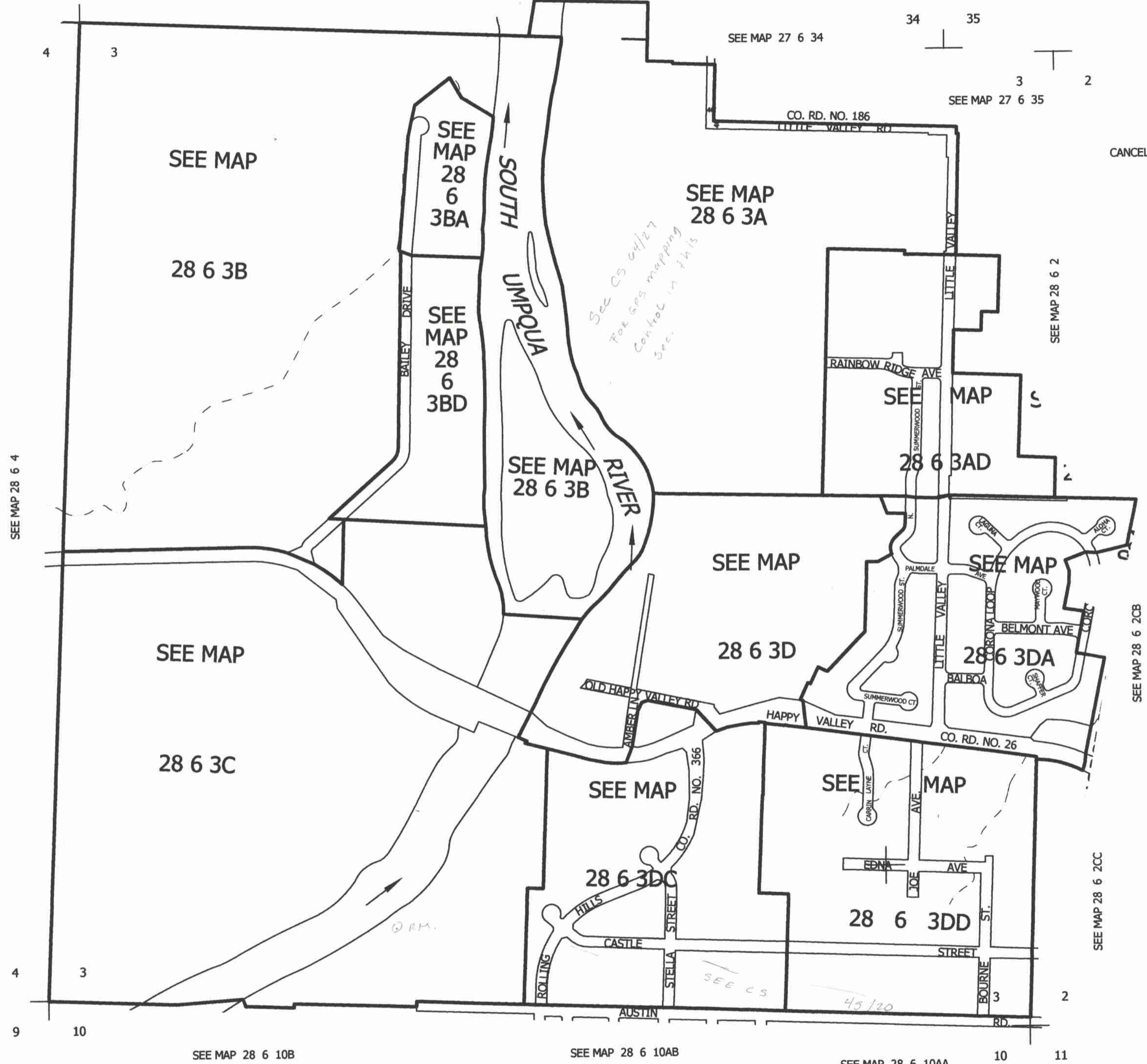

CANCELLED NO'S

557,000

4,151,000

28 6 3 & INDEX