

DETAIL T.28S. R.5E. W.M.
DOUGLAS COUNTY

1"-200'

28 5E
DETAIL MAP 3

THIS MAP WAS PREPARED FOR
ASSESSMENT PURPOSE ONLY.

APPROX.
CEN. SEC.

DETAIL OF DIAMOND LAKE
HOMESITES IN SEC. 12

*No Survey - For See
Descriptions, Assessor
Office*

SEE MAP 28 5E DETAIL NO 2

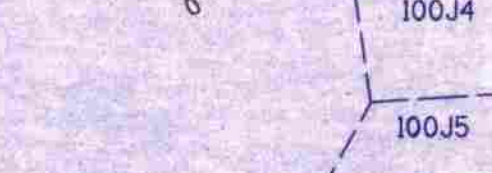
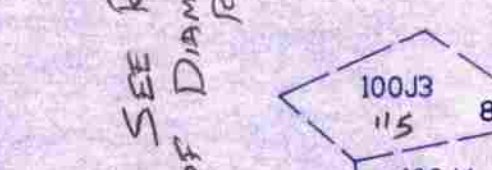
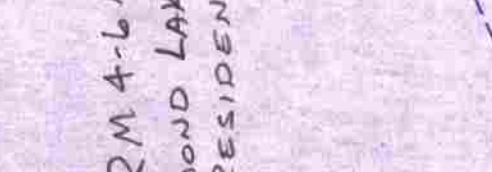
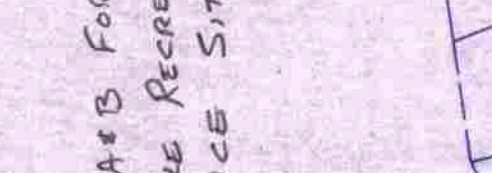
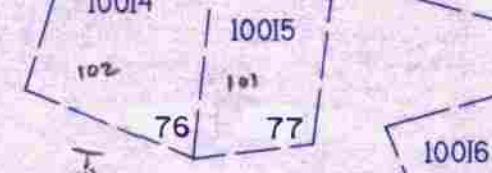
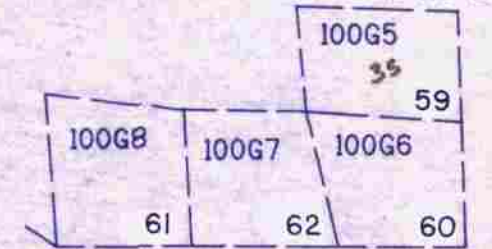

12-00

NO IMPROVEMENT
IN THIS AREA

SEE MAP 28 5E

*SEE RM 4-6 A & B FOR SURVEY
OF DIAMOND LAKE RECREATION
RESIDENCE SITE*

*SEE C.S. FILE 65/26-1A & B
FOR SCHEMATIC*

LAKE

APPROX.
1/4 COR.

SEE MAP 28 6E

APPROX.
1/4 COR

SEE MAP 28 5E DETAIL NO 4

12 7
13 18

28 5E
DETAIL MAP 3