

THIS MAP WAS PREPARED FOR ASSESSMENT PURPOSE ONLY.

T.28S. R.5E. W.M.
DOUGLAS COUNTY

28 5E
& INDEX

SEE MAP 27 5E

1"=2000'

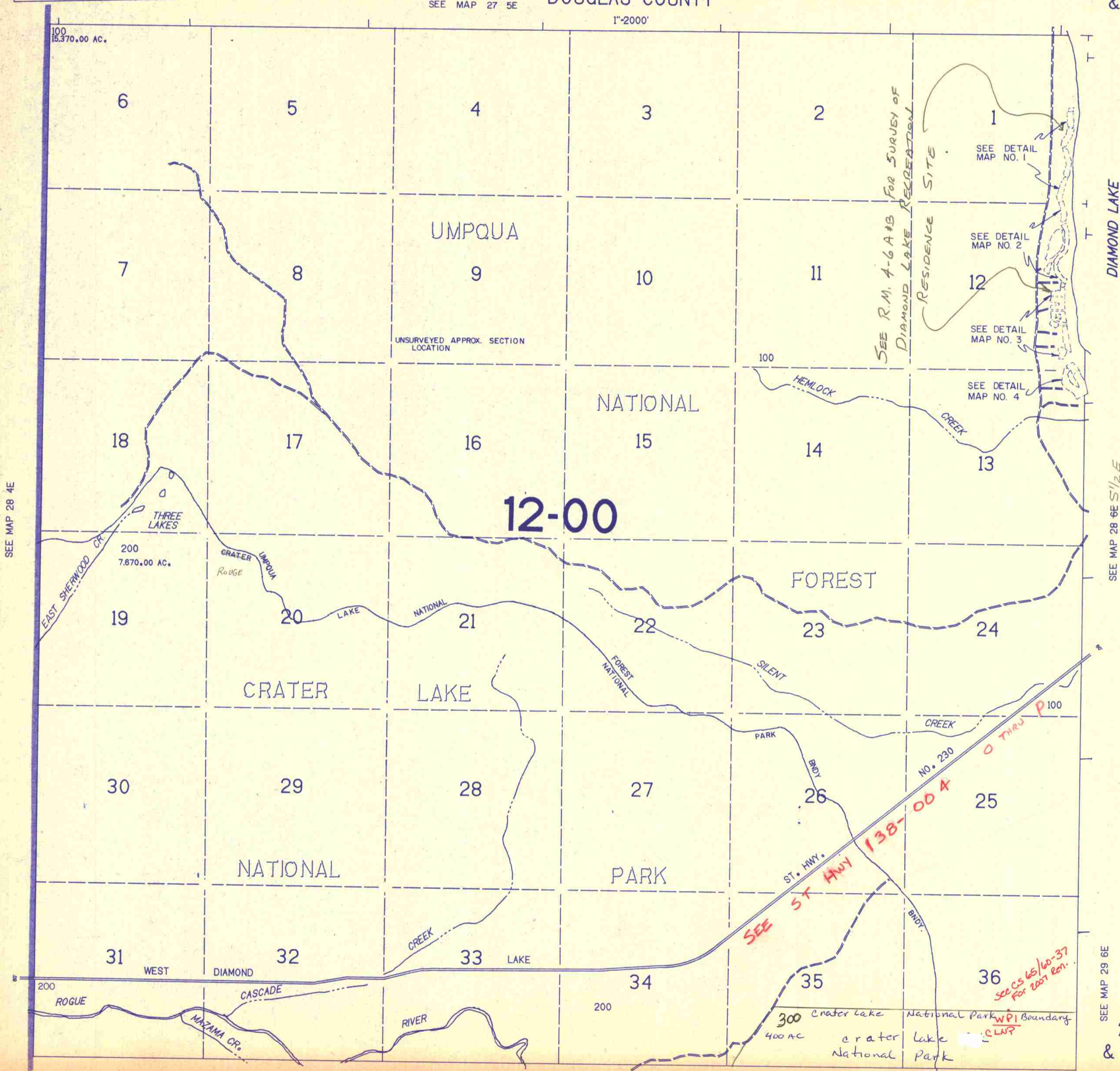

SEE MAP 28 4E

SEE MAP 28 6E S 1/2 E

SEE MAP 29 6E

SEE MAP 29 5E

28 5E
& INDEX

10/2/81