

THIS MAP WAS PREPARED FOR ASSESSMENT PURPOSE ONLY.

T.26S. R.6E. W.M.
DOUGLAS COUNTY

SEE MAP 25V 5E

26 6E

100
23,040.00 AC.

1"=2000'

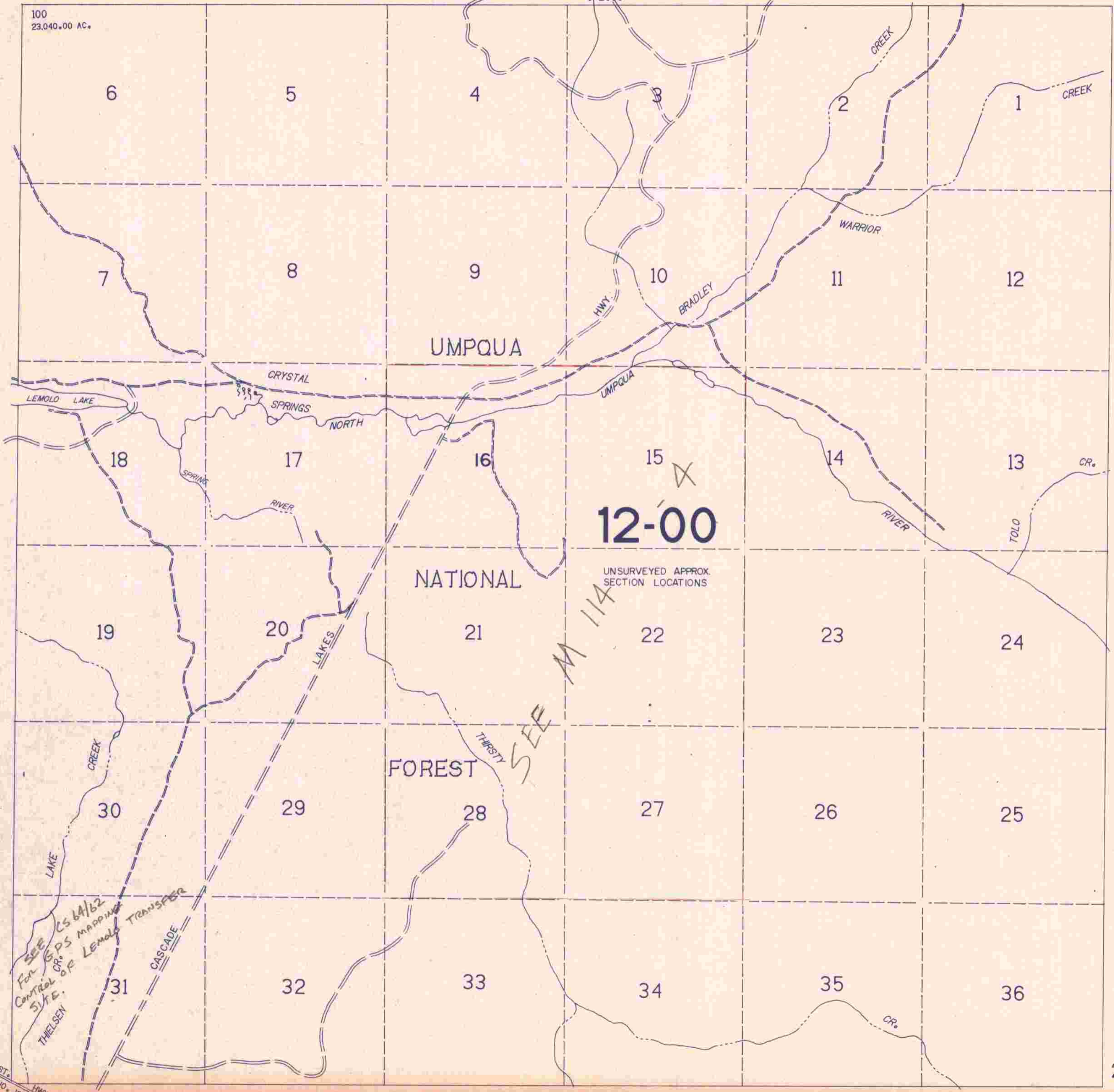

SEE MAP 26 5E

SEE MAP 26 6V

N. UMPQUA HWY.
ST. ON
HWY.
38

SEE MAP 27 6E

26 6E

11/2/88