

THIS MAP WAS PREPARED FOR ASSESSMENT PURPOSE ONLY.

T.26S. R.5E. W.M. DOUGLAS COUNTY

26 5E

SEE MAP 25V 5E

SEE MAP 26 4E

SEE MAP 26 6E

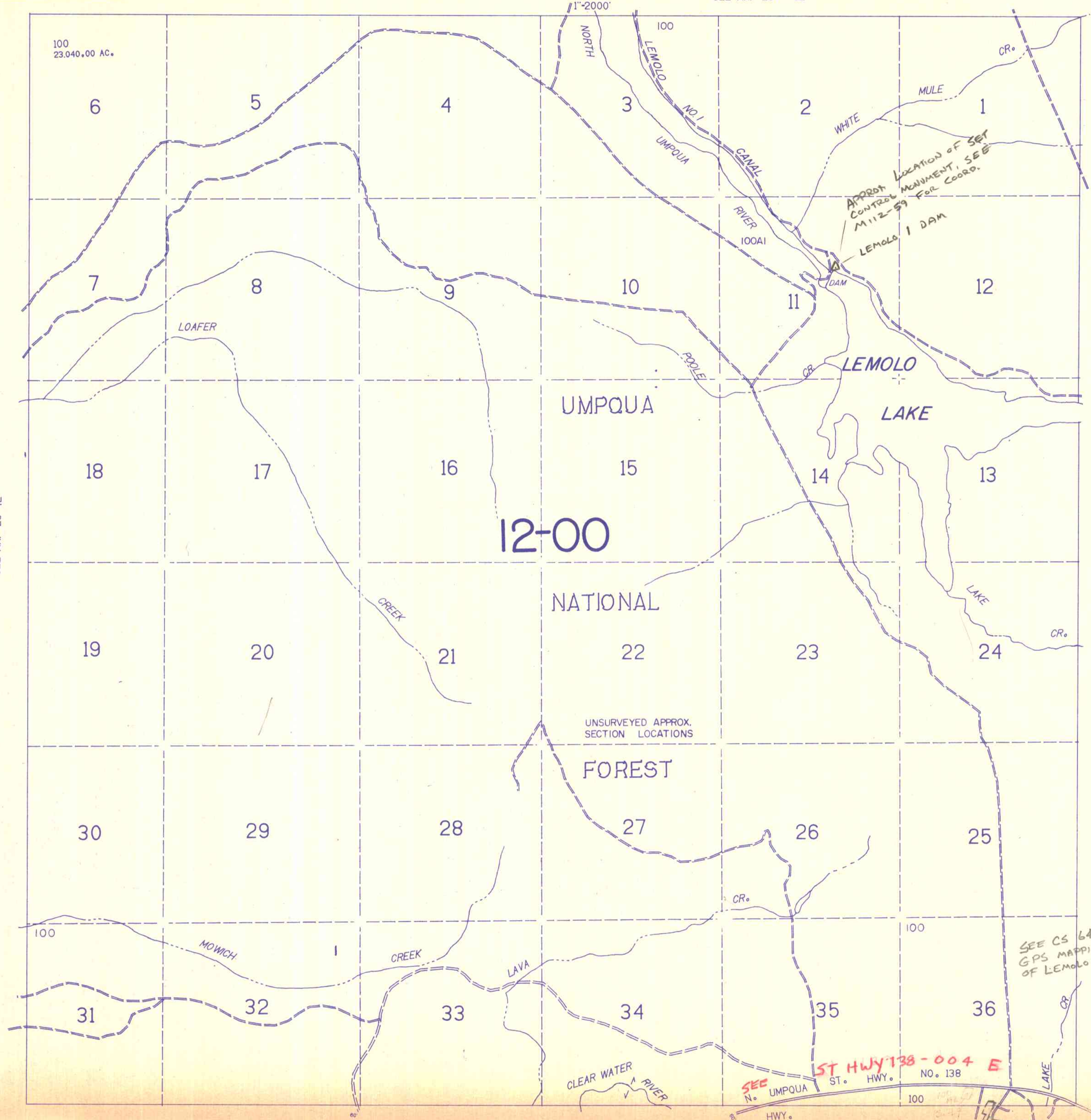

100  
23,040.00 AC.

1"=2000'  
NORTH

WHITE

APPROX LOCATION OF SET CONTROL MONUMENT, SEE M 112-59 FOR COORD.  
LEMOLO 1 DAM

LEMOLO LAKE

12-00

NATIONAL FOREST

UNSURVEYED APPROX. SECTION LOCATIONS

SEE CS 64/62 FOR GPS MAPPING CONTROL OF LEMOLO TRANSFER SITE.

SEC N. UMPQUA ST. HWY. NO. 138

26 5E

SEE MAP 27 5E

100  
3.49 AC

1/8/88