

SECTION 17 T.23S. R.4W. W.M.
DOUGLAS COUNTY

23 4 17

THIS MAP WAS PREPARED FOR
ASSESSMENT PURPOSE ONLY.

1"=400'

SEE MAP 23 4 8

CS 65197-2

M 172-80

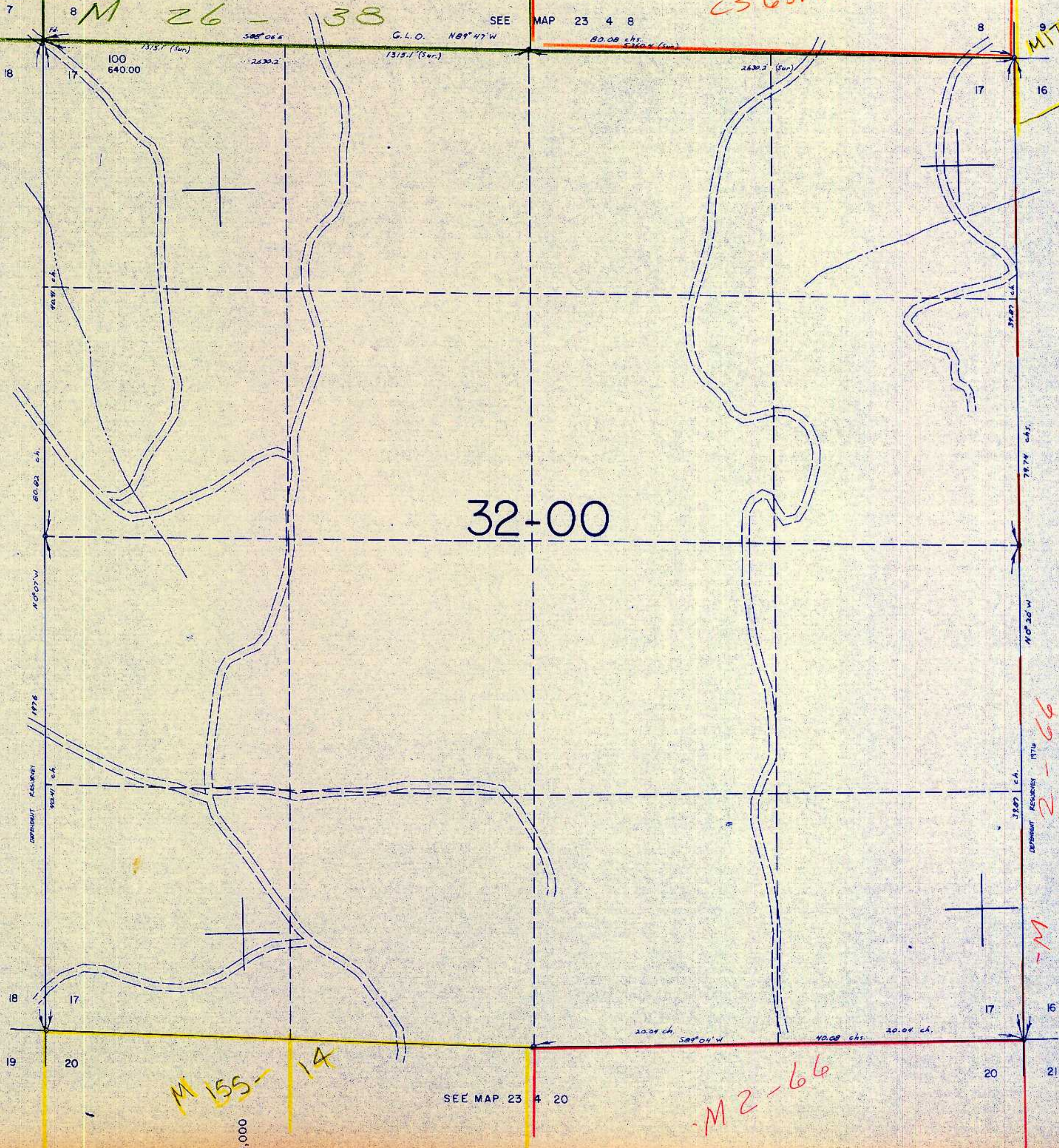

SEE MAP 23 4 18

SEE MAP 23 4 16

SEE MAP 23 4 20

M 155-14

M 2-66

M 98-44

M 2-66

M

703,000

1,284,000

23 4 17

9/10/78