

SECTION 13 T.22S. R.5W. W.M.
DOUGLAS COUNTY

22 5 13

THIS MAP WAS PREPARED FOR
ASSESSMENT PURPOSE ONLY.

1"=400'

SEE MAP 22 5

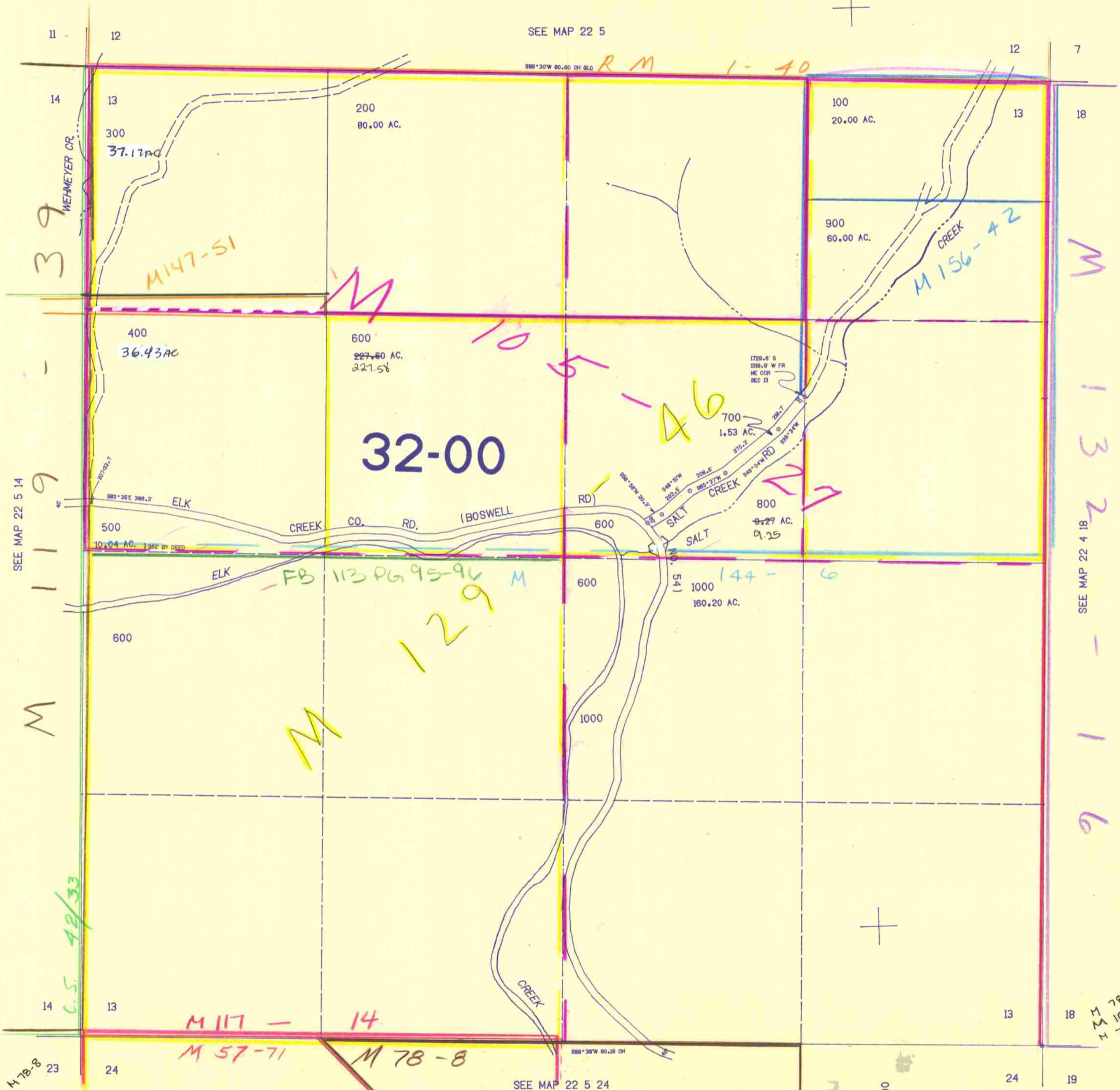

SEE MAP 22 5 14

SEE MAP 22 4 18

SEE MAP 22 5 24

735,000

1,277,500

22 5 13

7/03 BL

M 78-11
M 105-27
M 70-76

C.S. 48/33

M 78-8

M 117 -
M 57-71

14
M 78-8

39

119

M

M

129

146

M 13

144 - 6

M

132

136

91

18

19

7

18

13

13

13

13

13

13

13

13

13

13

13

13

11

12

14

13

300

400

500

600

600

600

600

14

24

200

80.00 AC.

600

227.60 AC.

221.58

600

600

600

600

600

14

24

S89°30'W 80.80 CH 91.0

S89°30'W 80.80 CH 91.0

S89°30'W 80.80 CH 91.0

S89°30'W 80.80 CH 91.0

S89°30'W 80.80 CH 91.0

S89°30'W 80.80 CH 91.0

S89°30'W 80.80 CH 91.0

S89°30'W 80.80 CH 91.0

S89°30'W 80.80 CH 91.0

S89°30'W 80.80 CH 91.0

S89°30'W 80.80 CH 91.0

S89°30'W 80.80 CH 91.0

S89°30'W 80.80 CH 91.0

S89°30'W 80.80 CH 91.0

S89°30'W 80.80 CH 91.0

S89°30'W 80.80 CH 91.0

S89°30'W 80.80 CH 91.0

S89°30'W 80.80 CH 91.0

S89°30'W 80.80 CH 91.0

S89°30'W 80.80 CH 91.0

S89°30'W 80.80 CH 91.0

S89°30'W 80.80 CH 91.0

S89°30'W 80.80 CH 91.0

S89°30'W 80.80 CH 91.0

S89°30'W 80.80 CH 91.0

S89°30'W 80.80 CH 91.0

S89°30'W 80.80 CH 91.0

S89°30'W 80.80 CH 91.0

S89°30'W 80.80 CH 91.0

S89°30'W 80.80 CH 91.0

S89°30'W 80.80 CH 91.0

S89°30'W 80.80 CH 91.0

S89°30'W 80.80 CH 91.0

S89°30'W 80.80 CH 91.0

S89°30'W 80.80 CH 91.0

S89°30'W 80.80 CH 91.0

S89°30'W 80.80 CH 91.0

S89°30'W 80.80 CH 91.0

S89°30'W 80.80 CH 91.0

S89°30'W 80.80 CH 91.0

S89°30'W 80.80 CH 91.0

S89°30'W 80.80 CH 91.0